

**FRITERM**<sup>®</sup>

since 1979

## AKSİYAL FANLI YATIK VE DİK TİP KURU SOĞUTUCULAR HORIZONTAL AND VERTICAL TYPE DRY COOLERS WITH AXIAL FANS

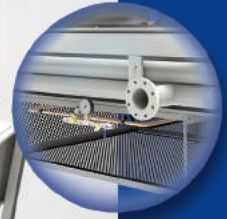
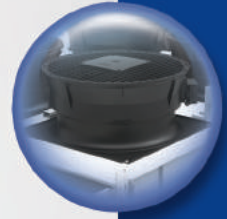

AKSİYAL FANLI YATIK VE DİK TİP KURU SOĞUTUCULAR • HORIZONTAL AND VERTICAL TYPE DRY COOLERS WITH AXIAL FANS • AKSİYAL FANLI YATIK VE DİK TİP KURU SOĞUTUCULAR • HORIZONTAL AND VERTICAL TYPE DRY COOLERS WITH AXIAL FANS • AKSİYAL FANLI YATIK VE DİK TİP KURU SOĞUTUCULAR • HORIZONTAL AND VERTICAL TYPE DRY COOLERS WITH AXIAL FANS • AKSİYAL FANLI YATIK VE DİK TİP KURU SOĞUTUCULAR • HORIZONTAL AND VERTICAL TYPE DRY COOLERS WITH AXIAL FANS • AKSİYAL FANLI YATIK VE DİK TİP KURU SOĞUTUCULAR • HORIZONTAL AND VERTICAL TYPE DRY COOLERS WITH AXIAL FANS

### Yeni Nesil FDH / FDV Kuru Soğutucu Tasarım Geliştirmeleri

- Ø800 ve Ø910 mm fan seçenekleri
- Ø800 mm fanlı ürünler için 6, Ø910 mm fanlı ürünler için 8 farklı ses seviyesi seçeneği.
- 1'den 16 fana kadar farklı ürün çeşitleri, geniş performans aralığı

### Developments in New Generation FDH / FDV Dry Coolers

- Ø800 and Ø910 mm fan options
- For the dry coolers with Ø800 mm fans 6, and for Ø910 mm fans 8 different sound level options
- Dry coolers with various fan numbers; from 1 to 16 fans, wide performance range



### Friterm Motor Kontrol ve İzleme Sistemi (FMC)

#### FMC Step Kontrol (FMC- S)

FMC Step Kontrol AC dıştan rotorlu ve standart motorlar için geliştirilen bir kontrol sistemidir. Temel kontrol ünitesi 5 kademeli olup özel uygulamalarda 15 kademeye kadar çıkılabilir. Sistemde fanların çalışma zamanının üniform olmasını sağlar, güvenli bir çalışma ve servis ömrü sunar.

#### FMC Voltaj Kontrol (FMC- V)

FMC Voltaj kontrol sistemi AC dıştan rotorlu motorlarda uygulanır. Fan hız kontrolünün en ekonomik yoludur. Bu sistem herhangi bir fan arızasında entegre bypass hattı sayesinde yüksek işletim güvenilirliği sağlar. Sese suyarlı ve yüksek enerji verimliliği istenen uygulamalarda tavsiye edilmez.

#### FMC Frekans Kontrol (FMC- F)

FMC Frekans Kontrol Sisteminde güç ünitesi olarak frekans invertörü kullanılır ve AC standart motorlarda uygulanır. Kontrolenden kaynaklı ek bir ses oluşmaz. Fan sayısına bağlı olarak çoklu güç ünitesi uygulanabilir. Güç ünitelerinden herhangi birinin arızalanmasında bypass özelliği ile sistem çalışmaya devam eder. Fan hızlarının sürekli modülasyonu sayesinde bu sistem önemli ölçüde enerji verimliliği sağlar.

**FMC All pole sinüs filtreli Frekans Kontrol (FMC- F- APSF):** Güç ünitesi olarak all pole sinüs filtreli frekans invertörü kullanılır ve AC dıştan rotorlu motorlarda uygulanır. All pole sinüs filtresi dıştan rotorlu motorlarda mutlak zorunluluktur.

#### FMC EC Kontrol (FMC- EC)

FMC EC Kontrol yüksek verimli EC fanlar ile birlikte uygulanır. Enerji verimliliği ve ses duyarlılığı açısından ideal çözümdür.

### Friterm Motor Control System (FMC)

#### FMC Step Control (FMC- S)

The FMC step control is a control system for AC external rotor and standard motors. Basic step version with up to 5 steps and special version is available with up to 15 steps. System ensures uniform utilization of fans and enhances the operational reliability and service life of fans.

#### FMC Voltage Control (FMC- V)

The FMC voltage control system is used for AC external rotor motors. This system is the most cost-effective way of controlling the speed and ensures high operational reliability with this product's integrated bypass function. This system is not recommended for noise-sensitive applications or with strict energy efficiency requirements.





#### FMC Frequency Control (FMC- F)

FMC frequency control is used for standard motors with a frequency converter as the power unit. It doesn't cause any control-related noise. Multi power units can be used. Even if a power unit fails this product is equipped with hardware and software bypass functions, which ensures operation. This system provides considerable energy savings thanks to continuous modulation of all the fans.

**FMC frequency control with all pole sine filter (FMC- F- APSF)** is used for AC external rotor motors with a frequency converter as the power unit. This is an absolute necessity for external rotor motors.

#### FMC EC Control (FMC- EC)

FMC EC Control is combined with high efficient EC fans and ensures ideal solution with respect to energy efficiency and noise emissions.

	 FMC-S	 FMC-V	 FMC-F	 FMC-F-APSF	 FMC-EC
<b>Enerji Verimliliği Energy Efficiency</b>	↓	↓	↑	↑	↑
<b>Kontrol Control</b>	Hassasiyet Precision	Hassasiyet Precision	Hassasiyet Precision	Hassasiyet Precision	Hassasiyet Precision
	Ses Seviyesi Sound	Ses Seviyesi Sound	Ses Seviyesi Sound	Ses Seviyesi Sound	Ses Seviyesi Sound
<b>Yatırım Maliyeti Investment</b>	↑	→	→	↓	↓

Çok iyi / Very good

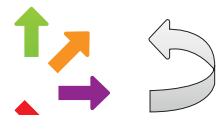

İyi Değil / Not so good

#### ÖZELLİKLER VE UYGULAMALAR

- Friterm FDH/FDV serisi kuru soğutucular dış ortam koşullarında montaj ve çalışmaya uygun olacak şekilde,
  - (S) Standart,
  - (L) Düşük Sesli,
  - (Q) Çok Düşük Sesli ve
  - (E) Sessiz

tiplerde imal edilirler.

- Fanlar tek sıralı 1'den 8'e kadar; çift sıralı 2'den 16'ya kadar olmak üzere yerleştirilmiştir.
- Modeller 8,5 ÷ 1410 kW gibi geniş bir kapasite aralığındadır.
- Tüm modeller yatay ve dikey tarzda montaj ve hava akışına uygundur.

#### Batarya Özellikleri

- Şaşırtmalı boru dizilişi,
- Bakır boru, alüminyum lameller
- 2,1 - 2,5 - 3,2 mm lamel aralıkları, diğer lamel aralıkları opsiyoneldir,
- Ayna saclarında geriye eğimli yakalar ve serbest ayna sistem kombinasyonu uygulanarak boruların ayna saclarına teması engellenmiş ve kaçaksız uzun çalışma ömrü garanti edilmiştir.
- Kollektörler ve giriş-çıkış bağlantıları çelik olup, bağlantı şekli flanşlıdır. Karşı flanş standarttır. Kollektörlerde hava alma ve boşaltma bağlantısı vardır.

#### KASETLEME

- Kuru Soğutucular kendini taşıyıcı bir konstrüksiyona sahiptir ve monte edileceği zemine ilave bir konstrüksiyona ihtiyaç duymadan yerleştirilebilir.
- Kasetleme malzemesi olarak galvanizli çelik kullanılır. Dış yüzeyler mükemmel bir UV ve korozyon koruması sağlayan epoksi polyester esaslı elektrostatik toz boya ile kaplanır. Standart renk olarak RAL 7044 uygulanır. İşlem sonrası sıcak daldırma galvaniz, magnelis ve paslanmaz çelik sac opsiyonel kasetleme malzemeleri olarak kullanılabilir.
- Her fan bölümü diğerinden ayrılmış ve duran fanların ters dönüş etkisi önlenmiştir.
- Tüm modellerde kaldırma mapaları ve montaj ayakları vardır.

#### FEATURES AND APPLICATIONS

- Friterm FDH/FDV series dry coolers, including 4 different sound levels of
  - (S) Standard,
  - (L) Low,
  - (Q) Quiet
  - (E) Extremely Quiet,

are designed for outdoor installation.

- The fans are arranged in single rows from 1 to 8 and in double rows from 2 to 16.
- Capacity range of Dry Coolers varies from 8,5 to 1410 kW.
- All models are available with vertical and horizontal airflow.

#### Coil Block

- Staggered tube alignment,
- Copper tubes, aluminium fins,
- 2,1 - 2,5 - 3,2 mm standart fin pitches. Other fin pitches are optional,
- Sliding collars and free holes system combination used in supporting end-plates that prevents any contact between tubes and end-plates and assures long life operation without leakages.
- Manifolds and inlet- outlet connecting tubes are steel. Manifolds equipped with vent and drain connections.

#### CASING

- Dry Coolers have their own self supporting construction and do not require any extra accessories for installation on steel or concrete base.
- Galvanized steel is used for casing. External surfaces are covered with polyester based electrostatically powder painting, which provides an excellent UV and corrosion protection. Standard color code is RAL 7044. Hot dip galvanized steel, magnelis or stainless steel can be used optionally.
- Each fan chamber is separated by internal baffle plates to prevent induced windmilling effect during off-cycle fans.
- All models are equipped with lifting eyes and mounting legs.

#### ADLANDIRMA / CLASSIFICATION

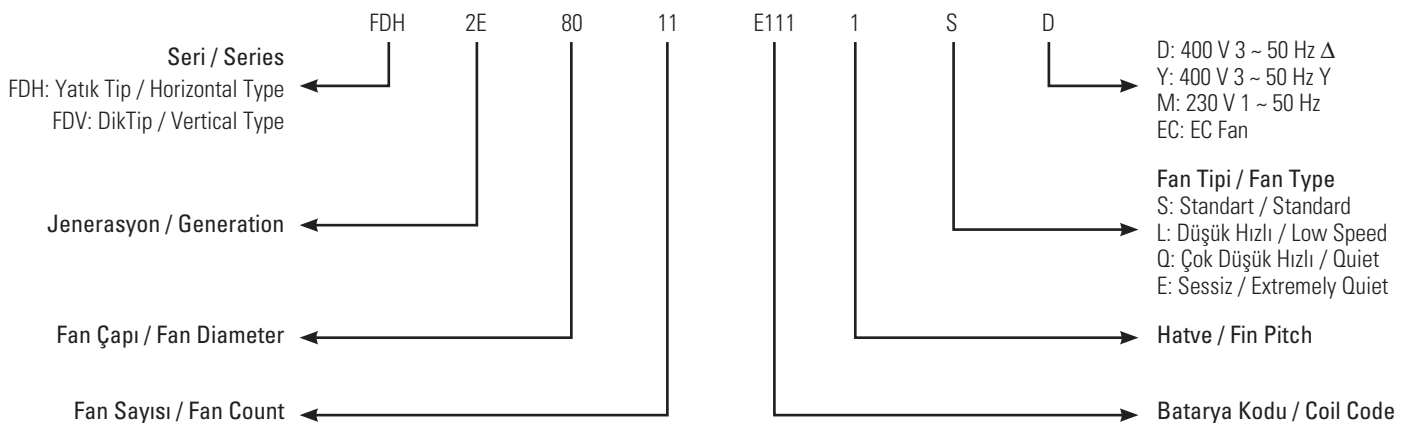

#### FANLAR

- Kuru Soğutucularda 800-910 mm çaplarda yüksek verimli dıştan rotorlu motora sahip ZIEHL-ABEGG, EBM veya muadili fanlar kullanılmaktadır.
- 800/910 mm fanlar 400V 3-50 Hz, çift hızlıdır. EC fanlar opsiyoneldir.
- Dıştan rotorlu motorlarda all pole sinüs filtreli frekans invertörü ile kademesiz fan devir ayarı yapılabilmektedir. Tüm motorlar %100 hız kontrolüne uygun yapıdadır ve iç koruma termistörleri bulunmaktadır.
- Dıştan rotorlu motorlarda izin verilen çalışma sıcaklık aralığı -40°C'dan +50°C / +65°C'a kadardır. Fan tipine bağlı olarak +70°C'a kadar tasarım yapılabilmektedir.
- Yüksek çalışma sıcaklığına uygun farklı fan ve motor seçenekleri opsiyoneldir.
- Fan kanatları hava miktarını en üst seviyede sağlayacak şekilde formlandırılmış yuvalarda çalışmaktadır.
- Koruyucu fan ızgarası standarttır. Motor koruma sınıfı IP 54; izolasyon sınıfı F dir.
- Friterm farklı markalarda fan kullanma hakkına sahiptir. Bu duruma bağlı olarak fan bilgilerinde kısmi farklılıklar olabilir.
- Her fan için dış ortama uygun servis-güvenlik şalteri mevcuttur. (IP 66 koruma sınıfı)

#### SES SEVİYELERİ

- Ürünlerin ses basınç seviyeleri EN 13487 standardına uygun olarak katalogta verilmiştir.
- Ses seviyeleri hesaplanırken fan imalatçıların vermiş olduğu ses gücü seviyeleri (LwA) kullanılmıştır.
- Ses seviyelerinin kritik olduğu durumlar için konunun uzmanına başvurunuz.

#### STANDART AKSESUARLAR

- UV dayanımlı güvenlik şalteri
- Montaj ayakları
- Kablo kanalı
- Karşı flanşlar
- Müdahale kapakları

#### OPSİYONEL AKSESUARLAR VE DİĞER SEÇENEKLER

- Özel boşaltma sistemli ürün
- Farklı lamel aralığı seçenekleri,
- Farklı lamel malzeme seçenekleri,
  - Kaplamalı alüminyum lameller
  - AlMg lameller
  - Bakır lamel
- Komple epoksi kaplı batarya
- Paslanmaz boru seçeneği
- Paslanmaz kaset seçeneği
- Bakır/ Paslanmaz kollektör
- Dış kaplamada farklı renk seçenekleri
- Adyabatik soğutma sistemi
  - Ağ üzeri spreyleme sistemi
  - Düşük ve yüksek basınçlı direkt spreyleme sistemi
- Güç ve kontrol panosu
- Farklı hız kontrol seçenekleri
  - Step kontrol
  - Voltaj kontrol
  - Frekans kontrol
  - EC kontrol
- Titreşim sönümleyici
- Farklı bağlantı şekilleri
- Difüzör/ Hava giriş ızgarası
- EC fan
- Ana klemens kutusu
- Uzaktan haberleşme protokolü (MODBUS)
- Korkuluk/ merdiven
- Genleşme tankı
- Yüksek montaj ayakları
- Yüksek çalışma sıcaklığına uygun farklı fan ve motor seçenekleri

#### MONTAJ VE BAKIM, KONUMLANDIRMA, TAŞIMA VE KALDIRMA

- Montaj ve bakım, konumlandırma, taşıma ve kaldırma detayları için "Kurulum İşletme ve Bakım Kılavuzu" na bakınız.

#### FANS

- High efficient axial, external rotor motor, Ziehl Abegg, EBM or equivalent fans with diameters 800-910 mm are used in drycoolers.
- 800/910 mm fans are 400V 3-50Hz, could be run at two different speeds and EC fans are optional.
- Variable fan speed regulation can be achieved by using frequency inverter with all pole sine filter. All external rotor motors are suitable for %100 speed control and equipped with internal protection.
- Ambient temperature range for external rotor motors is between -40°C and +50°C / +65°C. Due to operating conditions temperature range may go up to +70°C according to fan type.
- For high working temperatures different fans and motors are available optionally.
- Fans are running in a housing designed to maximize air flow rate.
- Protecting guard grilles are standart. Motor protection class IP54; insulation class F.
- Friterm reserves the right to use fans of different manufacturers. Depending on the type, the fan data may slightly vary.
- Each fan has safety-repair switch suitable for outdoor conditions (IP 66 protection class)

#### SOUND DATA

- Indicated sound pressure levels comply with EN 13487.
- Sound levels are obtained from sound power levels (LwA) of the fans.
- Consult an expert for critical sound requirements.

#### STANDARD ACCESSORIES

- UV resistance safety switch
- Mounting legs
- Cable tray
- Counter flanges
- Openings for cleaning etc.

#### OPTIONAL ACCESSORIES AND OTHER VARIANTS

- Products with self- drain system
- Other fin pitches
- Fin material options
  - Coated aluminium fins
  - AlMg fins
  - Copper fins
- Complete epoxy coated coil option
- Stainless steel tube option
- Stainless steel casing option
- Copper/ Stainless steel manifold
- Different color options for external cover
- Adiabatic cooling system
  - Ecomesh spray system
  - High (Fogging system) and low pressure direct spraying system
- Electrical power and control box
- Different speed control
  - Step control
  - Voltage control
  - Frequency control
  - EC Control
- Vibration dampers
- Different connection types
- Axitop/ flowgrid
- EC fan
- Junction box
- MODBUS communication protocol
- Handrail/ Ladder
- Expansion tank
- High mounting legs
- Other fan and motor options for high working pressure

#### INSTALLATION AND MAINTENANCE, SET-UP, CARRYING AND LIFTING

- Please read operating and maintenance manual for installation, maintenance, set-up, carrying and lifting.



**FANLAR / FANS**
**Fan Bilgileri / Fan Data**

Fan Çapı Fan Diameter	Fan Hızı (d/dk) Fan Speed		Fan Gücü (kW) Fan Power (kW)		Fan Akım (A) Fan Current (A)		Ses Gücü Seviyesi (dBA) Sound Power Level (dBA)		Voltaj/Faz/Frekans Voltage/Phase/Frequency
	Δ	Y	Δ	Y	Δ	Y	Δ	Y	
800- S	890	690	1,8	1,15	3,8	2,2	79	74	400V AC 3Ph 50Hz
800- L	670	510	0,8	0,49	1,95	1	73	65	400V AC 3Ph 50Hz
800- Q	440	350	0,33	0,18	0,9	0,4	61	57	400V AC 3Ph 50Hz
910- S	900	700	3,3	2,3	6,2	4	94	88	400V AC 3Ph 50Hz
910- L	885	685	2,48	1,57	5,15	2,9	77	71	400V AC 3Ph 50Hz
910- Q	650	475	1,15	0,64	2,78	1,36	70	63	400V AC 3Ph 50Hz
910- E	420	305	0,41	0,21	1,13	0,48	59	51	400V AC 3Ph 50Hz

**SES BASINÇ SEVİYESİ**

Ses basınç seviyeleri (LpA), ses gücü seviyeleri (LwA) kullanılarak EN 13487 Çevreye Yansıyan Yüzey Metoduna göre aşağıdaki formülle hesaplanır.

$$LpA = LwA - 10 \log \left( \frac{Sp}{Sr} \right)$$

Sp = 10 m mesafedeki dikdörtgen prizması yüzeyi  
Sr = referans yüzey (1m<sup>2</sup>)

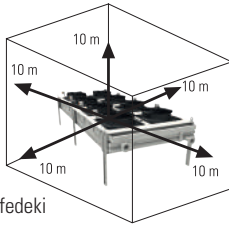

Verilen ses basınç seviyesi değerleri açık havada yansıtıcı bir düzlem üzerinde bulunan üründen 10 m mesafedeki dikdörtgen prizması yüzeyindeki ortalama değerlerdir.

**SOUND PRESSURE LEVEL**

Sound pressure levels (LpA) are determined from the sound power levels (LwA) by using following formula according to EN 13487 Surrounding Surface Method

$$LpA = LwA - 10 \log \left( \frac{Sp}{Sr} \right)$$

Sp = parallelepiped surface at 10 m  
Sr = surface reference (1m<sup>2</sup>)

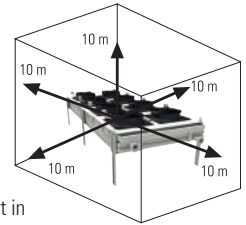

Sound pressure levels given show the average values on a parallelepiped surface at 10 m distance from the unit in open air over a reflecting plain.

**SES GÜCÜ SEVİYESİ / SOUND POWER LEVEL**

Fan Çapı Fan Diameter	Fan Hızı (d/dk) Fan Speed		Ses Gücü Seviyesi - Lwa - fan başına Sound Power Level - Lwa - per fan dB (A)																Toplam Total dB (A)	
	Δ	Y	63 Hz		125 Hz		250 Hz		500 Hz		1000 Hz		2000 Hz		4000 Hz		8000 Hz		Δ	Y
800	890	690	54	49	67	62	69	64	71	66	75	69	73	67	68	60	62	54	79	74
800	670	510	46	44	59	51	61	57	63	58	68	61	66	58	60	52	54	46	72	65
800	440	350	42	43	47	47	53	50	53	51	56	52	56	47	46	40	41	35	61	57
910	900	700	-	-	77	74	80	76	86	80	86	80	82	75	74	67	67	60	94	88
910	885	685	-	-	60	60	67	59	71	55	70	54	66	52	66	51	59	47	80	73
910	650	475	-	-	66	-	63	-	61	-	59	-	57	-	54	-	50	-	70	63
910	420	305	-	-	43	50	41	44	40	44	44	46	43	42	36	35	25	28	59	54

**SES SEVİYESİ BİLGİSİ / NOISE LEVEL DATA**
**SES BASINÇ SEVİYESİ / SOUND PRESSURE LEVEL**

Fan Çapı • Fan Devri Fan Diameter • Fan Speed	10 m'de Ses Basınç Seviyesi • Sound Pressure Level at 10 m															
	Fan Sayısı • Number of Fans															
	1	2	3	4	5	6	7	8	9	10	12	14	16			
SD 800 mm (890 d/d- rpm)	47	50	52	53	54	55	56	56	57	57	58	59	59			
SY 800 mm (690 d/d- rpm)	42	45	47	48	49	50	50	51	51	52	53	54	54			
LD 800 mm (670 d/d- rpm)	41	44	46	47	48	49	49	50	50	51	52	53	53			
LY 800 mm (510 d/d- rpm)	33	36	38	39	40	41	41	42	42	43	44	45	45			
QD 800 mm (440 d/d- rpm)	29	32	34	35	36	37	37	38	38	39	40	41	41			
QY 800 mm (350 d/d- rpm)	25	28	30	31	32	33	33	34	34	35	36	37	37			
SD 910 mm (900 d/d- rpm)	62	65	67	68	69	70	70	71	71	72	73	74	74			
SY 910 mm (700 d/d- rpm)	56	59	61	62	63	64	64	65	65	66	67	68	68			
LD 910 mm (885 d/d- rpm)	45	48	50	51	52	53	53	54	54	55	56	57	57			
LY 910 mm (685 d/d- rpm)	39	42	44	45	46	47	47	48	48	49	50	51	51			
QD 910 mm (650 d/d- rpm)	38	41	43	44	45	46	46	47	47	48	49	50	50			
QY 910 mm (475 d/d- rpm)	31	34	36	37	38	39	39	40	40	41	42	43	43			
ED 910 mm (420 d/d- rpm)	27	30	32	33	34	35	35	36	36	37	38	39	39			
EY 910 mm (305 d/d- rpm)	19	22	24	25	26	27	27	28	28	29	30	31	31			

\* Ses seviyesi değerleri 50 Hz. için verilmiştir. / Sound pressure levels are given for 50 Hz.

Uzaklık Distance m	Ses Seviyesindeki Artış Change in Sound Pressure Level dBA
1	20
5	6
10	0
50	- 14
100	- 20

Fan Sayısı Değişiminin Ses Gücü Seviyesine Etkisi Deviation on Sound Power Level in case of Several Fans																
Fan sayısı Number of Fans	(ad.) (pcs.)	1	2	3	4	5	6	7	8	9	10	12	14	16	18	20
Ses Gücü Seviyesindeki Artış Change in Sound Power Level	(dBA)	0	3	5	6	7	8	8	9	9	10	11	12	13	13	

#### KAPASİTE STANDARTLARI

Akışkan	: %34 Etilen Glikollü Su
Hava Giriş Sıcaklığı	: 25°C
Akışkan Giriş/Çıkış Sıcaklıkları	: 40/35°C
Rakım	: 0 m

#### CAPACITY STANDARDS

Refrigerant	: Water / 34% Ethylen Glycol
Air Inlet Temperature	: 25°C
Fluid Inlet/Outlet Temperature	: 40/35°C
Altitude	: 0 m

#### KAPASİTE DÜZELTME FAKTÖRLERİ

Seçim aşağıdaki formül yardımıyla yapılabilir.

$$Q_n = (Q / f_1) \times f_2$$

$Q_n$  = Nominal Kapasite

$Q$  = İstenen Kapasite

#### CAPACITY CORRECTION FACTORS

Selection can be made with the help of the formula below.

$$Q_n = (Q / f_1) \times f_2$$

$Q_n$  = Nominal Capacity

$Q$  = Desired Capacity

#### KAPASİTE DÜZELTME FAKTÖRLERİ / CAPACITY CORRECTION FACTORS

Farklı Sıcaklıklar için Kapasite Düzeltme Faktörü (f1)  
Capacity Correction Factor for Different Temperatures

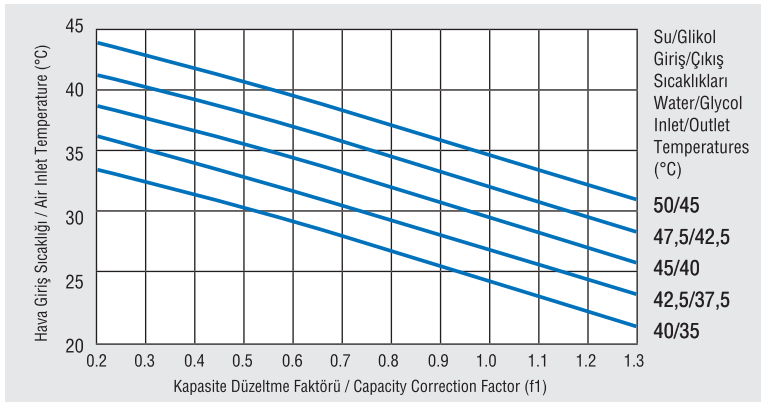

Rakım / Altitude (f2)

h (m)	f <sub>2</sub>
0	1.00
500	1.04
1000	1.07
1500	1.11
2000	1.16
2500	1.21
3000	1.25

\* Hesaplama sonucu elde edilen sonuçlar yaklaşıkştir. Daha hassas sonuçlar için lütfen ÜSP 6.0 Ürün Seçim Programını kullanınız.

\* This is an approximate result. Please use PSS 6.0 Product Selection Software for more accurate results.

#### FRITERM ÜRÜN SEÇİM YAZILIMI / FRITERM PRODUCT SELECTION SOFTWARE - ÜSP 6.0 / PSS 6.0

Farklı kullanım şartları için (akışkan, akışkan karışım oranı, giriş-çıkış sıcaklığı, ses seviyesi vs.) "Friterm Ürün Seçim Programı" kullanımı tavsiye edilmektedir. Friterm Ürün Seçim Yazılımı güncel ürünlerin en hızlı ve en kolay şekilde seçimine olanak sağlamaktadır.

"Friterm Product Selection Software" is recommended to select different products at different operating parameters (fluid, fluid mixture ratio, inlet-outlet temperature, sound pressure level etc.). This software provides selecting current products easily and rapidly.

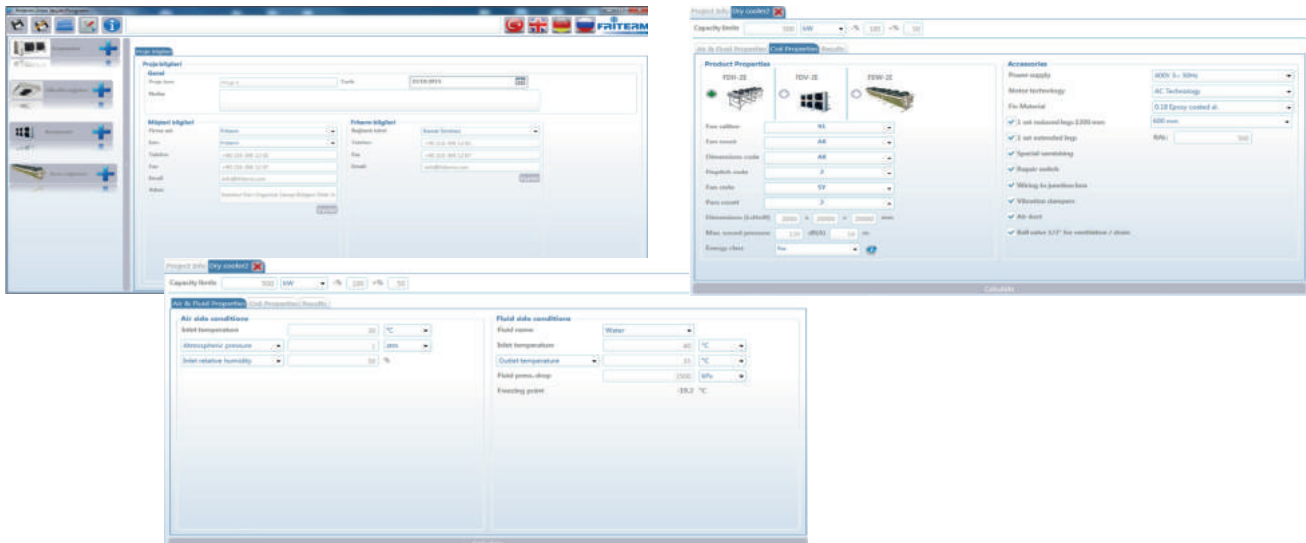

#### FRİTERM KURU SOĞUTUCU SU SPREYLEME SİSTEMİ

Friterm Su Spreyleme Sistemleri Kuru Soğutucu giriş hava sıcaklığını düşürerek verimin artmasını ve işletme maliyetinin azaltılmasını sağlamaktadır. Su birikimi olmadığından sağlık riski yaratmaz.

- **Doğrudan Spreyleme Sistemi** Aralıklı olarak yerleştirilmiş nozüllerden giriş havasına hava akış yönünde püskürtülen su zerreciklerinin giriş havasını neme doyması ve ortam yaş termometre sıcaklığına yaklaştırması esasına dayanmaktadır.
- **Ağ Üzeri (Ecomesh) Spreyleme Sistemi** Kuru soğutucuların hava giriş tarafına yerleştirilmiş sık gözlü ağ yapılı malzemenin üzerine nozullardan hava akışına zıt yönde sistemin ihtiyacı kadar su spreyletir. Spreylenen suyun adyabatik olarak buharlaşması sonucu ısı değiştirici giriş havası sıcaklığının düşürülerek, soğutmada verimin artırılması sağlanır. Kullanılan ağ sistemi kanatlara su gelmesini minimize eder.
- **Ağ üzeri spreyleme (Ecomesh) sisteminin faydaları:**
  - Kullanılan ağ sistemi su tüketimini azaltır.
  - Isı transfer verimliliğinin sürekliliğini sağlar.
  - Hava akışına zıt yönde spreyleme kanatlara su gelmesini en aza indirir.



#### FRİTERM DRY COOLERS SPRAYING SYSTEM

Friterm Water Spraying systems provides efficiency increasing with reducing the dry cooler air inlet temperature. This system also reduces the investment costs. Since there is no accumulation of water, the system does not create a health risk.

- **Direct Adiabatic Water Spray System** comprises a series of specialized water nozzles fitted intermittently. The nozzles are designed to pulverize the water in inlet air which absorbed by the high temperature ambient air approaching the coil. The saturated inlet air temperature approaches to the wet bulb temperature.
- **Ecomesh Water Spray System** concept is based on intermittently and efficiently evaporating water in opposite of air flow direction, on a large mesh area in front of the heat rejection surface of Dry Coolers. Water spray provides an adiabatic cooling effect for the incoming air stream and increases the cooling efficiency. Ecomesh system minimise the interaction of spray water and coil fins directly.
- **Advantages of Ecomesh Water Spray System:**
  - Ecomesh system reduces water consumption.
  - Provides continuity of heat transfer efficiency.
  - Water spraying in the opposite direction of air flow eliminates the interaction of spray water and coil fins directly.

#### TİTREŞİM DAMPERLERİ

Ürün ağırlıklarına göre farklı sayıda ve modelde titreşim damperi opsiyonel aksesuar olarak sunulmaktadır.

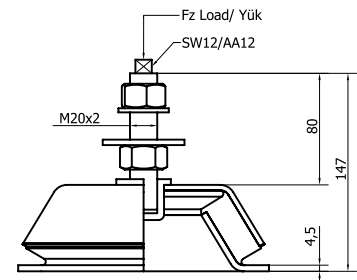
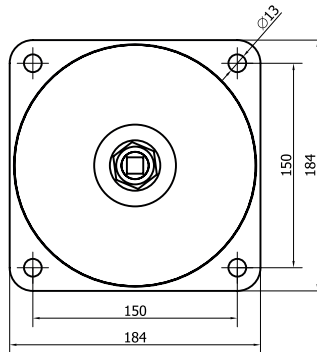

SW: Spanner Width  
AA: Anahtar Ağız

#### VIBRATION DAMPERS

Different vibration dampers with various numbers and models according to product weight is optional.

Model	Sertlik	Fz	Ağırlık	Sz
Model	Sh.	N	kg	mm
M1	45	3188	325	3,35
M2	60	6720	685	3,35
M3	70	10300	1049,9	3,35
M4	45	7455	759,9	3,5
M5	60	14519	1480	3,5
M6	70	20600	2099,9	3,5

Fz: Maksimum yük kuvveti / Maximum load force

Sz: Yüke karşı deplasman (Esneme miktarı) / Deflection at. max.load

FD H/V • Ø800 mm

Hatve / Fin Pitch: 2,1 mm

MODEL MODEL	Yüzey Surface	Boru Hacmi Tube Volume	Kapasite Capacity (Ethylen Glycol % 34 40/35°C 25°C)				Hava Debisi Air Flow				Glikol/Su Glycol/Water				Geçiş Sayısı No. of Pass	Motor Motor				Ses Seviyesi Noise Level		Enerji Verimliliği Sınıfı Energy Efficiency Class	Bağlantılar Connections		Ağırlık Weight
			S		S		Debi Flow		Basınç Kaybı Pressure Drop		3/400V 50 Hz					3/400V 50 Hz		3/400V 50 Hz	Giriş / Çıkış Inlet / Outlet						
			890 rpm	690 rpm	890 rpm	690 rpm	890 rpm	690 rpm	890 rpm	690 rpm	Toplam Güç / Total Power Toplam Akım / Total Current		S			S	S	S							
			Δ	Y	Δ	Y	Δ	Y	Δ	Y	Δ	Y	Δ	Y		Δ	Y	Δ	Y	Δ	Y				
			m <sup>2</sup>	dm <sup>3</sup>	kW		m <sup>3</sup> /h		m <sup>3</sup> /h		kPa		n	kW		A	kW	A	dB(A)	890/690 rpm	S 890 rpm		S 690 rpm	PN 10/ DN	
8011	D111	136	28	48,2	40,7	19.810	15.270	9,2	7,7	18	13	6	1,80	3,80	1,15	2,20	47	42	E/D	1 x 50	1 x 50	249			
	D121	155	31	53,4	45,1	20.620	16.000	10,2	8,6	23	17	6	1,80	3,80	1,15	2,20			E/D	1 x 50	1 x 50	264			
	D131	174	34	58,1	48,9	21.260	16.500	11,1	9,3	29	21	6	1,80	3,80	1,15	2,20			E/D	1 x 50	1 x 50	278			
	D211	181	36	58,2	47,9	18.680	14.260	11,1	9,1	31	22	8	1,80	3,80	1,15	2,20			E/D	1 x 50	1 x 50	266			
	D221	207	40	60,9	50,3	19.650	15.130	11,6	9,6	21	14	6	1,80	3,80	1,15	2,20			E/D	1 x 50	1 x 50	283			
	D231	232	47	66,2	54,5	20.460	15.710	12,6	10,4	19	18	6	1,80	3,80	1,15	2,20			D/D	1 x 65	1 x 50	303			
	D241	258	51	70,7	58,0	21.020	16.140	13,5	11,0	23	21	6	1,80	3,80	1,15	2,20			D/D	1 x 65	1 x 50	320			
	D251	284	55	74,7	61,3	21.510	16.580	14,2	11,7	28	24	6	1,80	3,80	1,15	2,20			D/D	1 x 65	1 x 50	336			
	D331	349	67	73,5	58,0	18.930	14.260	14,0	11,0	13	13	6	1,80	3,80	1,15	2,20			D/D	1 x 65	1 x 50	346			
	D341	387	73	78,4	61,9	19.650	14.840	14,9	11,8	16	16	6	1,80	3,80	1,15	2,20			D/D	1 x 65	1 x 50	367			
D351	426	79	82,9	65,0	20.300	15.270	15,8	12,4	19	12	6	1,80	3,80	1,15	2,20			D/D	1 x 65	1 x 65	388				
8012	D111	271	53	82,8	69,4	39.620	30.540	15,8	13,2	8	5	2	3,60	7,60	2,30	4,40	50	45	E/E	1 x 65	1 x 65	409			
	D121	310	59	94,5	79,6	41.230	31.990	18,0	15,2	10	7	2	3,60	7,60	2,30	4,40			E/D	1 x 65	1 x 65	438			
	D131	349	65	104,7	88,1	42.520	33.000	19,9	16,8	13	9	2	3,60	7,60	2,30	4,40			E/D	1 x 65	1 x 65	466			
	D211	362	68	116,1	95,5	37.360	28.510	22,1	18,2	30	21	4	3,60	7,60	2,30	4,40			E/D	1 x 65	1 x 65	442			
	D221	413	79	127,7	105,4	39.300	30.250	24,3	20,1	33	27	4	3,60	7,60	2,30	4,40			E/D	1 x 80	1 x 65	480			
	D231	465	88	137,6	113,4	40.750	31.410	26,2	21,6	41	34	4	3,60	7,60	2,30	4,40			D/D	1 x 80	1 x 65	513			
	D241	517	96	129,7	106,2	42.040	32.280	24,7	20,2	11	12	2	3,60	7,60	2,30	4,40			D/D	1 x 80	1 x 65	553			
	D251	568	104	138,5	113,6	43.010	33.150	26,4	21,6	13	13	2	3,60	7,60	2,30	4,40			D/D	1 x 80	1 x 65	591			
	D331	697	125	152,4	120,2	37.850	28.510	29,0	22,9	28	23	4	3,60	7,60	2,30	4,40			D/D	1 x 80	1 x 65	617			
	D341	775	137	161,9	127,6	39.300	29.670	30,8	24,3	34	22	4	3,60	7,60	2,30	4,40			D/D	1 x 80	1 x 80	645			
D351	852	150	170,3	133,5	40.590	30.540	32,4	25,4	40	25	4	3,60	7,60	2,30	4,40			D/D	1 x 80	1 x 80	713				
8013	D111	407	78	143,6	121,1	59.430	45.810	27,3	23,1	18	18	2	5,40	11,40	3,45	6,60	52	47	E/D	1 x 80	1 x 65	600			
	D121	465	87	159,5	134,7	61.850	47.980	30,4	25,7	23	17	2	5,40	11,40	3,45	6,60			E/D	1 x 80	1 x 80	643			
	D131	523	96	173,5	146,2	63.780	49.500	33,0	27,8	29	21	2	5,40	11,40	3,45	6,60			E/D	1 x 80	1 x 80	686			
	D211	542	100	163,7	134,7	56.040	42.760	31,2	25,7	17	12	2	5,40	11,40	3,45	6,60			E/D	1 x 80	1 x 80	650			
	D221	620	120	181,9	150,2	58.940	45.370	34,6	28,6	15	16	2	5,40	11,40	3,45	6,60			E/D	1 x 100	1 x 80	710			
	D231	697	132	198,0	162,8	61.360	47.110	37,7	31,0	19	19	2	5,40	11,40	3,45	6,60			D/D	1 x 100	1 x 80	760			
	D241	775	144	211,4	173,4	63.060	48.420	40,3	33,0	23	23	2	5,40	11,40	3,45	6,60			D/D	1 x 100	1 x 80	815			
	D251	852	155	223,8	183,5	64.510	49.720	42,6	34,9	28	19	2	5,40	11,40	3,45	6,60			D/D	1 x 100	1 x 100	905			
	D331	1046	188	219,7	173,4	56.770	42.760	41,8	33,0	14	16	2	5,40	11,40	3,45	6,60			D/D	1 x 100	1 x 80	886			
	D341	1162	207	234,6	185,1	58.940	44.500	44,7	35,2	17	11	2	5,40	11,40	3,45	6,60			D/D	1 x 100	1 x 100	954			
D351	1279	222	248,2	194,8	60.880	45.810	47,3	37,1	20	13	2	5,40	11,40	3,45	6,60			D/D	1 x 100	1 x 100	1065				
8014	D111	542	107	203,7	171,8	79.240	61.070	38,8	32,7	30	29	2	7,20	15,20	4,60	8,80	53	48	E/D	1 x 100	1 x 80	766			
	D121	620	118	224,3	189,3	82.460	63.970	42,7	36,0	41	30	2	7,20	15,20	4,60	8,80			E/D	1 x 100	1 x 100	836			
	D131	697	130	242,2	203,9	85.040	66.000	46,1	38,8	52	38	2	7,20	15,20	4,60	8,80			E/D	1 x 100	1 x 100	895			
	D211	723	136	231,7	190,6	74.720	57.020	44,1	36,3	26	18	2	7,20	15,20	4,60	8,80			E/D	1 x 100	1 x 100	832			
	D221	827	151	255,1	210,8	78.590	60.490	48,6	40,1	34	24	2	7,20	15,20	4,60	8,80			E/D	1 x 100	1 x 100	915			
	D231	930	167	275,1	226,6	81.490	62.810	52,4	43,2	43	30	2	7,20	15,20	4,60	8,80			D/D	1 x 100	1 x 100	983			
	D241	1033	183	293,0	240,0	84.080	64.550	55,8	45,7	52	36	2	7,20	15,20	4,60	8,80			D/D	1 x 100	1 x 100	1066			
	D251	1137	209	308,4	252,6	86.010	66.290	58,7	48,1	55	43	2	7,20	15,20	4,60	8,80			D/D	1 x 125	1 x 100	1163			
	D331	1395	250	304,7	240,3	75.690	57.020	58,0	45,8	25	20	2	7,20	15,20	4,60	8,80			D/D	1 x 125	1 x 100	1167			
	D341	1550	275	323,6	255,0	78.590	59.330	61,6	48,6	30	24	2	7,20	15,20	4,60	8,80			D/D	1 x 125	1 x 100	1289			
D351	1705	299	340,6	267,0	81.170	61.070	64,9	50,8	35	28	2	7,20	15,20	4,60	8,80			D/D	1 x 125	1 x 100	1376				
8015	D111	678	127	264,0	222,4	99.040	76.340	50,3	42,4	59	44	2	9,00	19,00	5,75	11,00	54	49	E/D	1 x 100	1 x 100	964			
	D121	775	142	288,8	243,6	103.080	79.960	55,0	46,4	78	57	2	9,00	19,00	5,75	11,00			E/D	1 x 100	1 x 100	1038			
	D131	872	167	310,8	261,3	106.300	82.500	59,2	49,8	91	71	2	9,00	19,00	5,75	11,00			E/D	1 x 125	1 x 100	1120			
	D211	904	173	298,7	246,6	92.990	71.270	56,9	47,0	43	35	2	9,00	19,00	5,75	11,00			E/D	1 x 125	1 x 100	1060			
	D221	1033	193	328,0	270,8	98.240	75.620	62,5	51,6	56	45	2	9,00	19,00	5,75	11,00			E/D	1 x 125	1 x 100	1145			
	D231	1162	213	352,4	290,0	101.870	78.510	67,1	55,2	71	56	2	9,00	19,00	5,75	11,00			D/D	1 x 125	1 x 100	1230			
	D241	1292	233	374,3	306,2	105.090	80.690	71,3	58,3	86	60	2	9,00	19,00	5,75	11,00			D/D	1 x 125	1 x 125	1327			
	D251	1421	253	393,0	320,4	107.510	82.500	74,8	61,0	102	71	2	9,00	19,00	5,75	11,00			D/D	1 x 125	1 x 125	1436			
	D331	1744	305	389,1	306,5	94.610	71.270																		



FD H/V 2E • Ø800 mm

Hatve / Fin Pitch: 2,1 mm

MODEL MODEL	Yüzey Surface	Boru Hacmi Tube Volume	Kapasite Capacity (Ethylen Glycol % 34 40/35°C 25°C)				Hava Debisi Air Flow				Glikol/Su Glycol/Water				Geçiş Sayısı No. of Pass	Motor Motor				Ses Seviyesi Noise Level		Enerji Verimliliği Sınıfı Energy Efficiency Class	Bağlantılar Connections		Ağırlık Weight
			S		S		Debi Flow		Basınç Kaybı Pressure Drop		3/400V 50 Hz					3/400V 50 Hz		3/400V 50 Hz		Giriş / Çıkış Inlet / Outlet					
			890 rpm	690 rpm	890 rpm	690 rpm	890 rpm	690 rpm	890 rpm	690 rpm	Toplam Güç / Total Power Toplam Akım / Total Current		S			S		S		S					
			Δ	Y	Δ	Y	Δ	Y	Δ	Y	Δ	Y	Δ	Y		Δ	Y	Δ	Y	Δ	Y		Δ	Y	
			m <sup>2</sup>	dm <sup>3</sup>	kW		m <sup>3</sup> /h		m <sup>3</sup> /h		kPa		n	kW		A		dB(A)		PN 10/ DN			kg		
8021	D111	253	59	98,3	82,8	38.650	29.670	18,7	15,8	41	30	8	2	3,60	7,60	2,30	4,40	50	45	E/E	1 x 65	1 x 65	414		
	D121	289	64	103,0	86,6	40.430	31.120	19,6	16,5	26	19	6	2	3,60	7,60	2,30	4,40	50	45	E/D	1 x 65	1 x 65	438		
	D131	325	70	112,3	94,3	41.880	32.280	21,4	18,0	33	24	6	2	3,60	7,60	2,30	4,40	50	45	E/D	1 x 65	1 x 65	461		
	D211	338	73	111,3	91,9	36.070	27.640	21,2	17,5	34	24	8	2	3,60	7,60	2,30	4,40	50	45	E/D	1 x 65	1 x 65	446		
	D221	386	81	104,5	85,9	38.330	29.380	19,9	16,4	12	8	4	2	3,60	7,60	2,30	4,40	50	45	E/D	1 x 65	1 x 65	474		
	D231	434	88	116,0	95,7	39.940	30.830	22,1	18,2	15	10	4	2	3,60	7,60	2,30	4,40	50	45	E/D	1 x 65	1 x 65	502		
	D241	482	96	126,0	103,5	41.230	31.700	24,0	19,7	18	12	4	2	3,60	7,60	2,30	4,40	50	45	D/D	1 x 65	1 x 65	529		
	D251	530	110	135,0	110,7	42.360	32.570	25,7	21,1	14	14	4	2	3,60	7,60	2,30	4,40	50	45	D/D	1 x 80	1 x 65	566		
	D331	651	131	141,5	111,8	36.720	27.640	27,0	21,3	17	16	6	2	3,60	7,60	2,30	4,40	50	45	D/D	1 x 80	1 x 65	590		
	D341	723	142	151,8	119,9	38.330	28.950	28,9	22,8	21	19	6	2	3,60	7,60	2,30	4,40	50	45	D/D	1 x 80	1 x 65	626		
D351	796	154	160,6	126,7	39.620	29.960	30,6	24,1	24	22	6	2	3,60	7,60	2,30	4,40	50	45	D/D	1 x 80	1 x 65	661			
8022	D111	506	120	196,0	165,0	77.300	59.330	37,3	31,4	34	31	4	2	7,20	15,20	4,60	8,80	53	48	E/E	1 x 100	1 x 80	716		
	D121	579	132	182,2	152,9	80.850	62.230	34,7	29,1	8	12	2	2	7,20	15,20	4,60	8,80	53	48	E/D	1 x 100	1 x 80	764		
	D131	651	143	202,5	169,9	83.750	64.550	38,6	32,3	11	15	2	2	7,20	15,20	4,60	8,80	53	48	E/D	1 x 100	1 x 80	811		
	D211	675	148	221,8	183,3	72.140	55.280	42,2	34,9	28	20	4	2	7,20	15,20	4,60	8,80	53	48	E/D	1 x 100	1 x 100	778		
	D221	771	163	245,9	202,8	76.650	58.750	46,8	38,6	37	26	4	2	7,20	15,20	4,60	8,80	53	48	E/D	1 x 100	1 x 100	833		
	D231	868	178	230,9	190,6	79.880	61.650	44,0	36,3	11	8	2	2	7,20	15,20	4,60	8,80	53	48	E/D	1 x 100	1 x 100	889		
	D241	964	193	251,0	206,2	82.460	63.390	47,8	39,3	14	9	2	2	7,20	15,20	4,60	8,80	53	48	D/D	1 x 100	1 x 100	951		
	D251	1061	209	269,1	220,6	84.720	65.130	51,2	42,0	16	11	2	2	7,20	15,20	4,60	8,80	53	48	D/D	1 x 100	1 x 100	1032		
	D331	1302	248	293,7	231,7	73.430	55.280	55,9	44,1	33	21	4	2	7,20	15,20	4,60	8,80	53	48	D/D	1 x 100	1 x 100	1044		
	D341	1446	290	313,4	247,3	76.650	57.890	59,7	47,1	32	25	4	2	7,20	15,20	4,60	8,80	53	48	D/D	1 x 125	1 x 100	1136		
D351	1591	313	330,1	260,2	79.240	59.910	62,9	49,6	38	29	4	2	7,20	15,20	4,60	8,80	53	48	D/D	1 x 125	1 x 100	1235			
8023	D111	759	160	275,7	232,2	115.950	89.000	52,5	44,2	21	15	2	2	10,80	22,80	6,90	13,20	55	50	E/E	1 x 100	1 x 100	1023		
	D121	868	196	307,4	258,7	121.270	93.350	58,5	49,3	20	20	2	2	10,80	22,80	6,90	13,20	55	50	E/D	1 x 125	1 x 100	1108		
	D131	976	213	335,6	281,8	108.630	96.830	63,9	53,7	26	25	2	2	10,80	22,80	6,90	13,20	55	50	E/D	1 x 125	1 x 100	1179		
	D211	1013	220	313,8	258,6	108.690	82.910	59,8	49,2	14	15	2	2	10,80	22,80	6,90	13,20	55	50	E/D	1 x 125	1 x 100	1130		
	D221	1157	243	350,3	288,9	114.980	88.130	66,7	55,0	18	19	2	2	10,80	22,80	6,90	13,20	55	50	E/D	1 x 125	1 x 100	1213		
	D231	1302	266	381,7	315,8	119.820	92.480	72,7	60,1	23	16	2	2	10,80	22,80	6,90	13,20	55	50	E/D	1 x 125	1 x 125	1296		
	D241	1446	289	409,2	336,6	123.690	95.090	77,9	64,1	28	19	2	2	10,80	22,80	6,90	13,20	55	50	D/D	1 x 125	1 x 125	1385		
	D251	1591	308	434,8	356,5	127.080	97.690	82,8	67,9	34	23	2	2	10,80	22,80	6,90	13,20	55	50	D/D	1 x 125	1 x 125	1522		
	D331	1953	371	423,2	334,3	110.140	82.910	80,6	63,7	19	12	2	2	10,80	22,80	6,90	13,20	55	50	D/D	1 x 125	1 x 125	1528		
	D341	2170	386	454,1	358,9	114.980	86.830	86,5	68,3	18	14	2	2	10,80	22,80	6,90	13,20	55	50	D/D	2 x 100	1 x 125	1630		
D351	2387	415	480,9	379,6	118.850	89.870	91,6	72,3	21	17	2	2	10,80	22,80	6,90	13,20	55	50	D/D	2 x 100	1 x 125	1807			
8024	D111	1013	219	391,1	329,4	154.600	118.660	74,5	62,7	35	26	2	2	14,40	30,40	9,20	17,60	56	51	E/E	1 x 125	1 x 125	1312		
	D121	1157	239	432,2	363,4	161.690	124.460	82,3	69,2	47	35	2	2	14,40	30,40	9,20	17,60	56	51	E/D	1 x 125	1 x 125	1429		
	D131	1302	243	468,5	393,1	167.500	129.100	89,2	74,9	55	43	2	2	14,40	30,40	9,20	17,60	56	51	E/D	2 x 100	1 x 125	1514		
	D211	1350	273	442,8	366,0	144.270	110.550	84,3	69,7	31	22	2	2	14,40	30,40	9,20	17,60	56	51	E/D	1 x 125	1 x 125	1434		
	D221	1543	281	491,4	405,3	153.300	117.500	93,6	77,2	36	29	2	2	14,40	30,40	9,20	17,60	56	51	E/D	2 x 100	1 x 125	1563		
	D231	1736	311	531,7	439,5	159.760	123.300	101,2	83,7	45	36	2	2	14,40	30,40	9,20	17,60	56	51	D/D	2 x 100	1 x 125	1677		
	D241	1929	341	567,3	465,9	164.920	126.780	108,0	88,7	55	38	2	2	14,40	30,40	9,20	17,60	56	51	D/D	2 x 100	2 x 100	1827		
	D251	2122	391	599,3	490,8	169.440	130.260	114,1	93,5	58	45	2	2	14,40	30,40	9,20	17,60	56	51	D/D	2 x 125	2 x 100	1955		
	D331	2604	448	587,1	463,3	146.850	110.550	111,8	88,2	32	21	2	2	14,40	30,40	9,20	17,60	56	51	D/D	2 x 100	2 x 100	2002		
	D341	2893	513	626,6	494,5	153.300	115.770	119,3	94,2	31	25	2	2	14,40	30,40	9,20	17,60	56	51	D/D	2 x 125	2 x 100	2200		
D351	3182	558	660,1	520,4	158.470	119.820	125,7	99,1	37	29	2	2	14,40	30,40	9,20	17,60	56	51	D/D	2 x 125	2 x 100	2348			
8025	D111	1266	237	506,6	426,5	193.240	148.330	96,5	81,2	62	49	2	2	18,00	38,00	11,50	22,00	57	52	E/D	2 x 100	1 x 125	1628		
	D121	1446	265	556,7	467,7	202.120	155.580	106,0	89,1	61	59	2	2	18,00	38,00	11,50	22,00	57	52	E/D	2 x 100	2 x 100	1750		
	D131	1627	313	601,2	504,0	209.380	161.370	114,5	96,0	96	75	2	2	18,00	38,00	11,50	22,00	57	52	E/D	2 x 125	2 x 100	1886		
	D211	1688	304	572,8	473,3	180.340	138.180	109,1	90,1	50	36	2	2	18,00	38,00	11,50	22,00	57	52	E/D	2 x 100	2 x 100	1788		
	D221	1929	361	632,0	520,7	191.630	146.880	120,3	99,2	59	47	2	2	18											

FD H/V 2E • Ø800 mm

Hatve / Fin Pitch: 2,1 mm

MODEL MODEL	Yüzey Surface	Boru Hacmi Tube Volume	Kapasite Capacity (Ethylen Glycol % 34 40/35°C 25°C)		Hava Debisi Air Flow		Glikol/Su Glycol/Water				Geçiş Sayısı No. of Pass	Motor Motor				Ses Seviyesi Noise Level		Enerji Verimliliği Sınıfı Energy Efficiency Class	Bağlantılar Connections		Ağırlık Weight	
			S		S		Debi Flow		Basınç Kaybı Pressure Drop			3/400V 50 Hz				3/400V 50 Hz			3/400V 50 Hz			Giriş / Çıkış Inlet / Outlet
			890 rpm	690 rpm	890 rpm	690 rpm	890 rpm	690 rpm	890 rpm	690 rpm		Toplam Güç / Total Power Toplam Akım / Total Current		S		S			S	S		
			Δ	Y	Δ	Y	Δ	Y	Δ	Y		Δ	Y	Δ	Y	Δ	Y					
m <sup>2</sup>	dm <sup>3</sup>	kW		m <sup>3</sup> /h		m <sup>3</sup> /h		kPa		n	kW		A		dB(A)		PN 10/ DN		kg			
8021	D112	271	63	96,4	81,3	39.620	30.540	18,4	15,5	20	15	6	3,60	7,60	2,30	4,40	50	45	E/D	1 x 65	1 x 65	430
	D122	310	69	106,8	90,3	41.230	31.990	20,3	17,2	26	19	6	3,60	7,60	2,30	4,40	50	45	E/D	1 x 65	1 x 65	455
	D132	349	75	116,2	97,8	42.520	33.000	22,1	18,6	32	23	6	3,60	7,60	2,30	4,40	50	45	E/D	1 x 65	1 x 65	480
	D212	362	78	116,4	95,8	37.360	28.510	22,2	18,2	34	24	8	3,60	7,60	2,30	4,40	50	45	E/D	1 x 65	1 x 65	464
	D222	413	86	108,5	89,2	39.300	30.250	20,7	17,0	12	9	4	3,60	7,60	2,30	4,40	50	45	E/D	1 x 65	1 x 65	494
	D232	465	95	120,3	98,7	40.910	31.410	22,9	18,8	16	11	4	3,60	7,60	2,30	4,40	50	45	E/D	1 x 65	1 x 65	524
	D242	517	110	130,2	106,6	42.040	32.280	24,8	20,3	12	13	4	3,60	7,60	2,30	4,40	50	45	D/D	1 x 80	1 x 65	562
	D252	568	118	138,9	113,9	43.010	33.150	26,5	21,7	14	15	4	3,60	7,60	2,30	4,40	50	45	D/D	1 x 80	1 x 65	591
	D332	697	140	147,0	116,0	37.850	28.510	28,0	22,1	18	17	6	3,60	7,60	2,30	4,40	50	45	D/D	1 x 80	1 x 65	618
	D342	775	153	156,8	123,7	39.300	29.670	29,9	23,6	21	19	6	3,60	7,60	2,30	4,40	50	45	D/D	1 x 80	1 x 65	656
8022	D352	852	165	165,7	130,0	40.590	30.540	31,6	24,8	24	15	6	3,60	7,60	2,30	4,40	50	45	D/D	1 x 80	1 x 80	694
	D112	542	129	204,1	172,1	79.240	61.070	38,9	32,8	33	31	4	7,20	15,20	4,60	8,80	53	48	E/D	1 x 100	1 x 80	745
	D122	620	141	189,0	159,2	82.460	63.970	36,0	30,3	9	12	2	7,20	15,20	4,60	8,80	53	48	E/D	1 x 100	1 x 80	795
	D132	697	153	209,5	176,1	85.040	66.000	39,9	33,5	11	15	2	7,20	15,20	4,60	8,80	53	48	E/D	1 x 100	1 x 80	845
	D212	723	158	232,1	191,0	74.720	57.020	44,2	36,4	28	19	4	7,20	15,20	4,60	8,80	53	48	E/D	1 x 100	1 x 100	811
	D222	827	174	255,3	210,9	78.590	60.490	48,6	40,2	36	25	4	7,20	15,20	4,60	8,80	53	48	E/D	1 x 100	1 x 100	869
	D232	930	191	239,4	196,5	81.820	62.810	45,6	37,4	11	8	2	7,20	15,20	4,60	8,80	53	48	E/D	1 x 100	1 x 100	929
	D242	1033	207	259,3	212,4	84.080	64.550	49,4	40,5	14	9	2	7,20	15,20	4,60	8,80	53	48	D/D	1 x 100	1 x 100	994
	D252	1137	224	277,0	227,2	86.010	66.290	52,8	43,3	16	11	2	7,20	15,20	4,60	8,80	53	48	D/D	1 x 100	1 x 100	1079
	D332	1395	287	304,8	240,4	75.690	57.020	58,0	45,8	25	21	4	7,20	15,20	4,60	8,80	53	48	D/D	1 x 125	1 x 100	1110
8023	D342	1550	311	323,7	255,1	78.590	59.330	61,6	48,6	31	25	4	7,20	15,20	4,60	8,80	53	48	D/D	1 x 125	1 x 100	1192
	D352	1705	336	340,7	267,0	81.170	61.070	64,9	50,9	36	28	4	7,20	15,20	4,60	8,80	53	48	D/D	1 x 125	1 x 100	1296
	D112	814	171	287,2	242,2	118.850	91.610	54,7	46,1	21	15	2	10,80	22,80	6,90	13,20	55	50	E/D	1 x 100	1 x 100	1063
	D122	930	210	318,9	269,4	123.690	95.960	60,7	51,3	20	20	2	10,80	22,80	6,90	13,20	55	50	E/D	1 x 125	1 x 100	1153
	D132	1046	229	347,1	292,3	127.560	99.000	66,1	55,7	25	25	2	10,80	22,80	6,90	13,20	55	50	E/D	1 x 125	1 x 100	1228
	D212	1085	236	327,3	269,5	112.080	85.520	62,3	51,3	14	15	2	10,80	22,80	6,90	13,20	55	50	E/D	1 x 125	1 x 100	1177
	D222	1240	260	363,8	300,5	117.880	90.740	69,3	57,2	18	13	2	10,80	22,80	6,90	13,20	55	50	E/D	1 x 125	1 x 125	1265
	D232	1395	285	395,9	325,7	122.720	94.220	75,4	62,0	23	16	2	10,80	22,80	6,90	13,20	55	50	D/D	1 x 125	1 x 125	1353
	D242	1550	309	422,8	346,9	126.110	96.830	80,5	66,0	27	19	2	10,80	22,80	6,90	13,20	55	50	D/D	1 x 125	1 x 125	1447
	D252	1705	330	447,6	367,0	129.020	99.430	85,2	69,9	33	23	2	10,80	22,80	6,90	13,20	55	50	D/D	1 x 125	1 x 125	1591
8024	D332	2092	397	439,3	346,8	113.530	85.520	83,7	66,0	19	12	2	10,80	22,80	6,90	13,20	55	50	D/D	1 x 125	1 x 125	1602
	D342	2325	413	469,2	370,2	117.880	89.000	89,4	70,5	17	14	2	10,80	22,80	6,90	13,20	55	50	D/D	2 x 100	1 x 125	1710
	D352	2557	444	496,4	389,6	121.760	91.610	94,5	74,2	21	17	2	10,80	22,80	6,90	13,20	55	50	D/D	2 x 100	1 x 125	1897
	D112	1085	235	407,3	343,6	158.470	122.140	77,6	65,4	34	25	2	14,40	30,40	9,20	17,60	56	51	E/D	1 x 125	1 x 125	1364
	D122	1240	257	448,5	378,6	164.920	127.940	85,4	72,1	46	34	2	14,40	30,40	9,20	17,60	56	51	E/D	1 x 125	1 x 125	1488
	D132	1395	260	484,5	407,7	170.080	132.000	92,3	77,6	52	42	2	14,40	30,40	9,20	17,60	56	51	E/D	2 x 100	1 x 125	1577
	D212	1446	272	463,3	381,3	149.430	114.030	88,2	72,6	26	22	2	14,40	30,40	9,20	17,60	56	51	E/D	2 x 100	1 x 125	1481
	D222	1653	301	510,3	421,5	157.180	120.980	97,2	80,3	35	29	2	14,40	30,40	9,20	17,60	56	51	E/D	2 x 100	1 x 125	1631
	D232	1860	334	550,2	453,2	162.980	125.620	104,8	86,3	44	31	2	14,40	30,40	9,20	17,60	56	51	D/D	2 x 100	2 x 100	1752
	D242	2066	366	586,1	480,0	168.150	129.100	111,6	91,4	53	37	2	14,40	30,40	9,20	17,60	56	51	D/D	2 x 100	2 x 100	1909
8025	D252	2273	418	616,8	505,2	172.020	132.580	117,5	96,2	55	43	2	14,40	30,40	9,20	17,60	56	51	D/D	2 x 125	2 x 100	2045
	D332	2790	501	609,4	480,6	151.370	114.030	116,1	91,5	25	21	2	14,40	30,40	9,20	17,60	56	51	D/D	2 x 125	2 x 100	2115
	D342	3100	549	647,3	510,1	157.180	118.660	123,3	97,1	30	24	2	14,40	30,40	9,20	17,60	56	51	D/D	2 x 125	2 x 100	2308
	D352	3410	597	681,2	534,0	162.340	122.140	129,7	101,7	35	28	2	14,40	30,40	9,20	17,60	56	51	D/D	2 x 125	2 x 100	2466
	D112	1356	254	527,9	444,9	198.080	152.680	100,5	84,7	60	48	2	18,00	38,00	11,50	22,00	57	52	E/D	2 x 100	1 x 125	1691
	D122	1550	284	577,6	487,2	206.150	159.920	110,0	92,8	78	58	2	18,00	38,00	11,50	22,00	57	52	E/D	2 x 100	2 x 100	1820
	D132	1744	335	621,6	522,7	212.600	165.000	118,4	99,5	91	72	2	18,00	38,00	11,50	22,00	57	52	E/D	2 x 125	2 x 100	1964
	D212	1808	346	597,5	493,1	185.980	142.530	113,8	93,9	43	35	2	18,00	38,00	11,50	22,00	57	52	E/D	2 x 125	2 x 100	1878
	D222	2066	386	656,1	541,5	196.470	151.230	124,9	103,1	57	46	2	18,00	38,00	11,50	22,00	57	52	E/D	2 x 125	2 x 100	2029
	D232	2325	426	704,7	580,0	203.730	157.020	134,2	110,5	71	57	2	18,00	38,00	11,50	22,00	57	52	D/D	2 x 125	2 x 100	2181
8026	D242	2583																				

FD H/V 2E • Ø800 mm

Hatve / Fin Pitch: 2,1 mm

MODEL MODEL	Yüzey Surface	Boru Hacmi Tube Volume	Kapasite Capacity (Ethylen Glycol % 34 40/35°C 25°C)				Hava Debisi Air Flow				Glikol/Su Glycol/Water				Geçiş Sayısı No. of Pass	Motor Motor				Ses Seviyesi Noise Level		Enerji Verimliliği Sınıfı Energy Efficiency Class	Bağlantılar Connections		Ağırlık Weight				
			S		S		Debi Flow		Basınç Kaybı Pressure Drop		3/400V 50 Hz					3/400V 50 Hz		3/400V 50 Hz		Giriş / Çıkış Inlet / Outlet									
			890 rpm	690 rpm	890 rpm	690 rpm	890 rpm	690 rpm	890 rpm	690 rpm	Toplam Güç / Total Power Toplam Akım / Total Current		S			S		S 890 rpm	S 690 rpm	S 890 rpm	S 690 rpm								
			Δ	Y	Δ	Y	Δ	Y	Δ	Y	Δ	Y	Δ	Y		Δ	Y	Δ	Y	Δ	Y		Δ	Y					
m <sup>2</sup>		dm <sup>3</sup>		kW				m <sup>3</sup> /h				m <sup>2</sup> /h				kPa				n	kW		A		dB(A)		PN 10/ DN		kg
8011	E111	142	20	49,3	42,0	20.540	15.850	9,4	8,0	40	30	6	1 x 1	1,80	3,80	1,15	2,20	47	42	E/D	1 x 50	1 x 50	243						
	E121	162	22	54,3	46,2	21.260	16.430	10,3	8,8	53	39	6		1,80	3,80	1,15	2,20			E/D	1 x 50	1 x 50	257						
	E131	183	24	58,7	49,8	21.750	16.870	11,2	9,5	66	49	6		1,80	3,80	1,15	2,20			E/D	1 x 50	1 x 50	270						
	E211	189	25	59,5	49,5	19.490	14.910	11,3	9,4	73	53	8		1,80	3,80	1,15	2,20			E/D	1 x 50	1 x 50	258						
	E221	216	28	62,6	51,9	20.380	15.560	11,9	9,9	44	31	6		1,80	3,80	1,15	2,20			E/D	1 x 50	1 x 50	273						
	E231	244	34	67,5	56,0	21.020	16.140	12,9	10,7	48	39	6		1,80	3,80	1,15	2,20			D/D	1 x 65	1 x 50	292						
	E241	271	36	71,8	59,1	21.510	16.430	13,7	11,2	59	46	6		1,80	3,80	1,15	2,20			D/D	1 x 65	1 x 50	307						
	E251	298	39	75,6	62,3	21.910	16.870	14,4	11,9	69	54	6		1,80	3,80	1,15	2,20			D/D	1 x 65	1 x 50	322						
	E331	365	46	76,3	60,3	19.650	14.690	14,5	11,5	31	25	6		1,80	3,80	1,15	2,20			D/D	1 x 65	1 x 50	328						
	E341	406	50	80,7	64,0	20.220	15.270	15,4	12,2	37	25	6		1,80	3,80	1,15	2,20			D/D	1 x 65	1 x 65	347						
E351	446	54	84,5	67,2	20.700	15.710	16,1	12,8	44	29	6	1,80	3,80	1,15	2,20	D/D	1 x 65	1 x 65	366										
8012	E111	284	37	88,4	75,2	41.070	31.700	16,8	14,3	14	10	2	1 x 2	3,60	7,60	2,30	4,40	50	45	E/E	1 x 65	1 x 65	396						
	E121	325	41	99,1	84,3	42.520	32.860	18,9	16,1	19	14	2		3,60	7,60	2,30	4,40			E/D	1 x 65	1 x 65	422						
	E131	365	45	108,7	92,1	43.650	33.730	20,7	17,5	24	17	2		3,60	7,60	2,30	4,40			E/D	1 x 65	1 x 65	449						
	E211	379	47	118,8	98,8	38.980	29.810	22,6	18,8	68	49	4		3,60	7,60	2,30	4,40			E/D	1 x 65	1 x 65	424						
	E221	433	56	130,0	107,6	40.750	31.120	24,7	20,5	83	63	4		3,60	7,60	2,30	4,40			E/D	1 x 80	1 x 65	460						
	E231	487	61	139,4	115,5	42.040	32.280	26,6	22,0	103	79	4		3,60	7,60	2,30	4,40			D/D	1 x 80	1 x 65	490						
	E241	541	67	134,4	111,0	43.010	33.000	25,6	21,1	21	19	2		3,60	7,60	2,30	4,40			D/D	1 x 80	1 x 65	526						
	E251	595	72	142,6	117,8	43.820	33.730	27,1	22,4	25	22	2		3,60	7,60	2,30	4,40			D/D	1 x 80	1 x 65	581						
	E331	731	86	157,0	123,9	39.300	29.380	29,9	23,6	67	49	4		3,60	7,60	2,30	4,40			D/D	1 x 80	1 x 65	560						
	E341	812	94	165,4	131,1	40.430	30.540	31,5	25,0	80	52	4		3,60	7,60	2,30	4,40			D/D	1 x 80	1 x 80	604						
E351	893	102	172,8	107,6	41.400	31.120	32,9	26,1	93	63	4	3,60	7,60	2,30	4,40	D/D	1 x 80	1 x 65	666										
8013	E111	426	55	147,3	125,5	61.610	47.550	28,0	23,9	37	34	2	1 x 3	5,40	11,40	3,45	6,60	52	47	E/D	1 x 80	1 x 65	580						
	E121	487	61	162,5	138,1	63.780	49.280	30,9	26,3	49	37	2		5,40	11,40	3,45	6,60			E/D	1 x 80	1 x 80	620						
	E131	548	67	175,5	148,9	65.240	50.590	33,4	28,4	62	46	2		5,40	11,40	3,45	6,60			E/D	1 x 80	1 x 80	659						
	E211	568	69	169,9	142,0	58.460	44.940	32,4	27,0	33	24	2		5,40	11,40	3,45	6,60			E/D	1 x 80	1 x 80	622						
	E221	649	85	187,3	155,1	61.120	46.680	35,7	29,5	35	31	2		5,40	11,40	3,45	6,60			E/D	1 x 100	1 x 80	679						
	E231	731	93	202,0	167,5	63.060	48.420	38,5	31,9	45	38	2		5,40	11,40	3,45	6,60			D/D	1 x 100	1 x 80	724						
	E241	812	101	214,8	176,8	64.510	49.280	40,9	33,7	54	45	2		5,40	11,40	3,45	6,60			D/D	1 x 100	1 x 80	775						
	E251	893	108	226,4	186,7	65.720	50.590	43,1	35,6	66	47	2		5,40	11,40	3,45	6,60			D/D	1 x 100	1 x 100	852						
	E331	1096	129	228,3	180,4	58.940	44.070	43,5	34,4	30	20	2		5,40	11,40	3,45	6,60			D/D	1 x 100	1 x 100	830						
	E341	1218	141	242,3	191,8	60.880	45.810	46,1	36,5	37	24	2		5,40	11,40	3,45	6,60			D/D	1 x 100	1 x 100	892						
E351	1339	152	253,3	201,3	62.090	47.110	48,2	38,3	44	29	2	5,40	11,40	3,45	6,60	D/D	1 x 100	1 x 100	983										
8014	E111	568	77	206,1	175,6	82.140	63.390	39,3	33,4	76	64	2	1 x 4	7,20	15,20	4,60	8,80	53	48	E/D	1 x 100	1 x 80	740						
	E121	649	84	225,8	191,7	85.040	65.710	43,0	36,5	103	77	2		7,20	15,20	4,60	8,80			E/D	1 x 100	1 x 100	799						
	E131	731	92	242,6	205,7	86.980	67.450	46,2	39,2	129	96	2		7,20	15,20	4,60	8,80			E/D	1 x 100	1 x 100	852						
	E211	758	96	237,3	197,4	77.950	59.620	45,2	37,6	61	44	2		7,20	15,20	4,60	8,80			E/D	1 x 100	1 x 100	795						
	E221	866	105	259,8	215,1	81.490	62.230	49,5	41,0	82	59	2		7,20	15,20	4,60	8,80			E/D	1 x 100	1 x 100	863						
	E231	974	116	278,8	230,9	84.080	64.550	53,1	44,0	103	74	2		7,20	15,20	4,60	8,80			D/D	1 x 100	1 x 100	925						
	E241	1082	126	295,3	242,7	86.010	65.710	56,2	46,2	125	88	2		7,20	15,20	4,60	8,80			D/D	1 x 100	1 x 100	1021						
	E251	1191	147	310,0	255,3	87.630	67.450	59,0	48,6	142	105	2		7,20	15,20	4,60	8,80			D/D	1 x 125	1 x 100	1092						
	E331	1461	174	313,9	247,7	78.590	58.750	59,8	47,2	62	45	2		7,20	15,20	4,60	8,80			D/D	1 x 125	1 x 100	1078						
	E341	1623	190	330,7	262,2	80.850	61.070	63,0	49,9	74	54	2		7,20	15,20	4,60	8,80			D/D	1 x 125	1 x 100	1190						
E351	1786	206	345,5	274,2	82.790	62.810	65,8	52,2	87	63	2	7,20	15,20	4,60	8,80	D/D	1 x 125	1 x 100	1266										
8015	E111	710	90	265,0	225,6	102.670	79.240	50,5	43,0	148	111	2	1 x 5	9,00	19,00	5,75	11,00	54	49	E/D	1 x 100	1 x 100	924						
	E121	812	100	289,1	245,3	106.300	82.140	55,1	46,7	194	145	2		9,00	19,00	5,75	11,00			E/D	1 x 100	1 x 100	991						
	E131	913	120	309,7	262,4	108.720	84.310	59,0	50,0	237	181	2		9,00	19,00	5,75	11,00			E/D	1 x 125	1 x 100	1068						
	E211	947	124	304,7	253,4	97.430	74.530	58,0	48,3	112	85	2		9,00	19,00	5,75	11,00			E/D	1 x 125	1 x 100	1005						
	E221	1082	137	332,2	274,8	101.870	77.790	63,2	52,3	147	110	2		9,00	19,00	5,75	11,00			E/D	1 x 125	1 x 100	1081						
	E231	1218	150	355,6	294,1	105.090	80.690	67,7	56,0	185	138	2		9,00	19,00	5,75	11,00			D/D	1 x 125	1 x 100	1158						
	E241	1353	163	375,7	308,5	107.510	82.140	71,5	58,7	224	158	2		9,00	19,00	5,75	11,00			D/D	1 x 125	1 x 125	1246						
	E251	1488	176	393,6	323,9	109.530	84.310	74,9	61,7	266	188	2		9,00	19,00	5,75	11,00			D/D	1 x 125	1 x 125	1346						
	E331	1826	210	399,2	314,4	98.240	73.440	76,0	59,9	115	75	2		9,00	19,00	5,75	11,00			D/D	1 x 125	1 x 125	1337						
	E341	2029	229	419,7	332,3	101.060	76.340	79,9	63,3	138	91	2		9,00	19,00	5,75	11,00			D/D	1 x								

FD H/V 2E • Ø800 mm

Hatve / Fin Pitch: 2,1 mm

MODEL MODEL	Yüzey Surface	Boru Hacmi Tube Volume	Kapasite Capacity (Ethylen Glycol % 34 40/35°C 25°C)				Hava Debisi Air Flow				Glikol/Su Glycol/Water				Geçiş Sayısı No. of Pass	Motor Motor				Ses Seviyesi Noise Level		Enerji Verimliliği Sınıfı Energy Efficiency Class	Bağlantılar Connections		Ağırlık Weight
			S		S		Debi Flow		Basınç Kaybı Pressure Drop		3/400V 50 Hz					3/400V 50 Hz		S	S	S	S				
			890 rpm	690 rpm	890 rpm	690 rpm	890 rpm	690 rpm	890 rpm	690 rpm	Toplam Güç / Total Power Toplam Akım / Total Current		S			S	S	S	S	S	S				
			Δ	Y	Δ	Y	Δ	Y	Δ	Y	Δ	Y	Δ	Y		Δ	Y	Δ	Y	Δ	Y		Δ	Y	
			m <sup>2</sup>	dm <sup>3</sup>	kW		m <sup>3</sup> /h		m <sup>3</sup> /h		kPa		n	kW		A	kW	A	dB(A)	890/690 rpm	S 890 rpm		S 690 rpm	PN 10/ DN	
8021	E111	285	44	99,2	84,7	40.100	30.970	18,9	16,1	98	73	8	2 x 1	3,60	7,60	2,30	4,40	50	45	E/D	1 x 65	1 x 65	404		
	E121	303	48	104,6	89,1	41.720	32.280	19,9	17,0	58	43	6	3,60	7,60	2,30	4,40	E/D	1 x 65	1 x 65	425					
	E131	341	51	113,4	96,1	43.010	33.150	21,6	18,3	73	54	6	3,60	7,60	2,30	4,40	E/D	1 x 65	1 x 65	447					
	E211	354	53	114,4	95,4	38.010	29.090	21,8	18,2	80	57	8	3,60	7,60	2,30	4,40	E/D	1 x 65	1 x 65	430					
	E221	404	58	110,9	92,2	39.940	30.540	21,1	17,6	20	14	4	3,60	7,60	2,30	4,40	E/D	1 x 65	1 x 65	455					
	E231	455	63	121,6	100,8	41.400	31.700	23,2	19,2	25	18	4	3,60	7,60	2,30	4,40	E/D	1 x 65	1 x 65	480					
	E241	505	75	130,9	108,2	42.520	32.570	24,9	20,6	23	21	4	3,60	7,60	2,30	4,40	D/D	1 x 80	1 x 65	516					
	E251	556	80	138,9	114,5	43.330	33.150	26,5	21,8	28	25	4	3,60	7,60	2,30	4,40	D/D	1 x 80	1 x 65	541					
	E331	682	93	147,4	117,2	38.330	28.800	28,1	22,3	37	30	6	3,60	7,60	2,30	4,40	D/D	1 x 80	1 x 65	557					
	E341	758	101	157,1	124,7	39.780	29.960	29,9	23,7	45	35	6	3,60	7,60	2,30	4,40	D/D	1 x 80	1 x 65	589					
8022	E351	833	108	164,8	130,8	40.750	30.830	31,4	24,9	52	34	6	3,60	7,60	2,30	4,40	D/D	1 x 80	1 x 80	620					
	E111	530	91	198,0	168,9	80.200	61.940	37,7	32,2	85	70	4	7,20	15,20	4,60	8,80	E/D	1 x 100	1 x 80	696					
	E121	606	99	190,9	162,7	83.430	64.550	36,3	31,0	17	19	2	7,20	15,20	4,60	8,80	E/D	1 x 100	1 x 80	739					
	E131	682	106	209,9	177,9	86.010	66.290	40,0	33,9	22	24	2	7,20	15,20	4,60	8,80	E/D	1 x 100	1 x 80	783					
	E211	707	109	228,3	190,3	76.010	58.180	43,5	36,2	68	49	4	7,20	15,20	4,60	8,80	E/D	1 x 100	1 x 100	747					
	E221	808	119	250,1	208,2	79.560	61.070	47,6	39,7	89	64	4	7,20	15,20	4,60	8,80	E/D	1 x 100	1 x 100	797					
	E231	909	129	242,5	201,1	82.790	63.390	46,2	38,3	20	14	2	7,20	15,20	4,60	8,80	E/D	1 x 100	1 x 100	848					
	E241	1010	139	261,2	216,0	85.040	65.130	49,7	41,1	25	17	2	7,20	15,20	4,60	8,80	D/D	1 x 100	1 x 100	904					
	E251	1111	149	277,3	228,5	86.660	66.290	52,8	43,5	29	20	2	7,20	15,20	4,60	8,80	D/D	1 x 100	1 x 100	979					
	E331	1364	194	303,5	240,8	76.650	57.600	57,8	45,9	67	49	4	7,20	15,20	4,60	8,80	D/D	1 x 125	1 x 100	994					
8023	E341	1515	209	322,2	254,2	79.560	59.620	61,4	48,4	81	58	4	7,20	15,20	4,60	8,80	D/D	1 x 125	1 x 100	1063					
	E351	1667	224	336,9	267,1	81.490	61.650	64,2	50,9	95	68	4	7,20	15,20	4,60	8,80	D/D	1 x 125	1 x 100	1153					
	E111	796	117	282,4	241,2	120.300	92.910	53,8	45,9	42	31	2	10,80	22,80	6,90	13,20	E/E	1 x 100	1 x 100	988					
	E121	909	148	312,7	266,4	125.140	96.830	59,5	50,7	48	41	2	10,80	22,80	6,90	13,20	E/D	1 x 125	1 x 100	1069					
	E131	1023	159	339,4	287,6	129.020	99.430	64,6	54,8	61	52	2	10,80	22,80	6,90	13,20	E/D	1 x 125	1 x 100	1134					
	E211	1061	163	326,5	272,4	114.010	87.260	62,2	51,9	30	27	2	10,80	22,80	6,90	13,20	E/D	1 x 125	1 x 100	1081					
	E221	1212	178	361,3	300,1	119.820	91.610	68,8	57,2	40	29	2	10,80	22,80	6,90	13,20	E/D	1 x 125	1 x 125	1156					
	E231	1364	193	391,3	324,5	124.180	95.090	74,5	61,8	51	36	2	10,80	22,80	6,90	13,20	E/D	1 x 125	1 x 125	1231					
	E241	1515	208	417,5	345,1	127.560	97.690	79,5	65,7	62	44	2	10,80	22,80	6,90	13,20	D/D	1 x 125	1 x 125	1312					
	E251	1667	221	439,3	362,3	129.500	99.430	83,6	69,0	75	53	2	10,80	22,80	6,90	13,20	D/D	1 x 125	1 x 125	1425					
8024	E331	2046	261	441,2	350,7	114.980	86.390	84,0	66,8	36	24	2	10,80	22,80	6,90	13,20	D/D	1 x 125	1 x 125	1425					
	E341	2273	264	470,4	373,4	119.340	89.870	89,6	71,1	39	29	2	10,80	22,80	6,90	13,20	D/D	2 x 100	1 x 125	1510					
	E351	2500	284	493,7	392,1	122.240	92.480	94,0	74,7	46	34	2	10,80	22,80	6,90	13,20	D/D	2 x 100	1 x 125	1650					
	E111	1061	162	395,3	337,4	160.400	123.880	75,3	64,2	83	62	2	14,40	30,40	9,20	17,60	E/D	1 x 125	1 x 125	1265					
	E121	1212	176	434,5	370,0	166.860	129.100	82,7	70,5	112	84	2	14,40	30,40	9,20	17,60	E/D	1 x 125	1 x 125	1362					
	E131	1364	171	469,6	397,3	172.020	132.580	89,4	75,7	137	105	2	14,40	30,40	9,20	17,60	E/D	2 x 100	1 x 125	1434					
	E211	1414	178	456,0	380,1	152.010	116.350	86,8	72,4	64	49	2	14,40	30,40	9,20	17,60	E/D	2 x 100	1 x 125	1351					
	E221	1616	197	499,9	416,2	159.110	122.140	95,2	79,3	86	66	2	14,40	30,40	9,20	17,60	E/D	2 x 100	1 x 125	1465					
	E231	1818	216	540,0	447,3	165.570	126.780	102,8	85,2	110	83	2	14,40	30,40	9,20	17,60	D/D	2 x 100	1 x 125	1567					
	E241	2020	236	574,2	473,8	170.080	130.260	109,3	90,2	134	95	2	14,40	30,40	9,20	17,60	D/D	2 x 100	2 x 100	1704					
8025	E251	2222	275	601,5	495,6	172.660	132.580	114,5	94,4	151	112	2	14,40	30,40	9,20	17,60	D/D	2 x 125	2 x 100	1821					
	E331	2727	325	606,8	481,5	153.300	115.190	115,5	91,7	65	48	2	14,40	30,40	9,20	17,60	D/D	2 x 125	2 x 100	1848					
	E341	3030	354	644,2	508,3	159.110	119.240	122,7	96,8	79	57	2	14,40	30,40	9,20	17,60	D/D	2 x 125	2 x 100	2012					
	E351	3334	384	673,7	534,2	162.980	123.300	128,3	101,7	94	67	2	14,40	30,40	9,20	17,60	D/D	2 x 125	2 x 100	2141					
	E111	1326	168	508,5	433,6	200.500	154.850	96,8	82,6	154	120	2	18,00	38,00	11,50	22,00	E/D	2 x 100	1 x 125	1551					
	E121	1515	186	556,6	473,5	208.570	161.370	106,0	90,2	204	153	2	18,00	38,00	11,50	22,00	E/D	2 x 100	2 x 100	1660					
	E131	1705	224	599,5	507,0	215.020	165.720	114,2	96,5	252	192	2	18,00	38,00	11,50	22,00	E/D	2 x 125	2 x 100	1786					
	E211	1768	211	584,1	488,1	189.210	145.430	111,2	92,9	123	89	2	18,00	38,00	11,50	22,00	E/D	2 x 100	2 x 100	1681					
	E221	2020	255	639,4	531,9	198.890	152.680	121,7	101,3	155	117	2	18,00	38,00	11,50	22,00	E/D	2 x 125	2 x 100	1824					
	E231	2273	280	688,6	569,9	206.960	158.470	131,1	108,5	196	146	2	18,00	38,00	11,50	22,00	D/D	2 x 125	2 x 100	1951					
8026	E241	2525	304	730,5	602,3	212.600	162.820	139,1	114,7	240	171	2	18,00	38,00	11,50	22,00	D/D	2 x 125	2 x 125	2090					
	E251	2778	329	763,9	628,8	215.830	165.720	145,5	119,7	284	201	2	18,00	38,00	11,50	22,00	D/D	2 x 125	2 x 125	2240					
	E331	3409	391	771,8	611,7	191.630	143.980	147,0	116,5	122	80	2	18,00	38,00	11,50	22,00	D/D	2 x 125	2 x 125	2281					
	E341	3788	428	817,6	644,4	198.890	149.050																		

FD H/V 2E • Ø800 mm

Hatve / Fin Pitch: 2,1 mm

MODEL MODEL	Yüzey Surface	Boru Hacmi Tube Volume	Kapasite Capacity (Ethylen Glycol % 34 40/35°C 25°C)				Hava Debisi Air Flow				Glikol/Su Glycol/Water				Geçiş Sayısı No. of Pass	Motor Motor				Ses Seviyesi Noise Level		Enerji Verimliliği Sınıfı Energy Efficiency Class	Bağlantılar Connections		Ağırlık Weight
			S		S		Debi Flow		Basınç Kaybı Pressure Drop		3/400V 50 Hz					3/400V 50 Hz		3/400V 50 Hz		Giriş / Çıkış Inlet / Outlet					
			890 rpm	690 rpm	890 rpm	690 rpm	890 rpm	690 rpm	890 rpm	690 rpm	Toplam Güç / Total Power Toplam Akım / Total Current		S			S		S 890 rpm	S 690 rpm	S 890 rpm	S 690 rpm				
			Δ	Y	Δ	Y	Δ	Y	Δ	Y	Δ	Y	Δ	Y		Δ	Y	Δ	Y	Δ	Y		Δ	Y	
			m <sup>2</sup>	dm <sup>3</sup>	kW		m <sup>3</sup> /h		m <sup>3</sup> /h		kPa		n	kW		A	kW	A	dB(A)				PN 10/ DN	kg	
8021	E112	284	47	98,6	84,1	41.070	31.700	18,8	16,0	43	32	6	3,60	7,60	2,30	4,40	50	45	E/D	1 x 65	1 x 65	419			
	E122	325	51	108,7	92,4	42.520	32.860	20,7	17,6	56	41	6	3,60	7,60	2,30	4,40			E/D	1 x 65	1 x 65	442			
	E132	365	55	117,3	99,6	43.490	33.730	22,3	19,0	70	52	6	3,60	7,60	2,30	4,40			E/D	1 x 65	1 x 65	465			
	E212	379	57	119,1	99,0	38.980	29.810	22,7	18,9	77	55	8	3,60	7,60	2,30	4,40			E/D	1 x 65	1 x 65	448			
	E222	433	62	115,0	95,3	40.750	31.120	21,9	18,1	20	14	4	3,60	7,60	2,30	4,40			E/D	1 x 65	1 x 65	474			
	E232	487	68	125,6	104,1	42.040	32.280	23,9	19,8	25	18	4	3,60	7,60	2,30	4,40			E/D	1 x 65	1 x 65	501			
	E242	541	80	134,7	111,3	43.010	33.000	25,7	21,2	23	21	4	3,60	7,60	2,30	4,40			D/D	1 x 80	1 x 65	538			
	E252	595	85	142,9	118,0	43.820	33.730	27,2	22,5	27	24	4	3,60	7,60	2,30	4,40			D/D	1 x 80	1 x 65	564			
	E332	731	100	152,6	120,5	39.300	29.380	29,1	23,0	36	29	6	3,60	7,60	2,30	4,40			D/D	1 x 80	1 x 65	583			
	E342	812	108	161,4	128,1	40.430	30.540	30,7	24,4	43	28	6	3,60	7,60	2,30	4,40			D/D	1 x 80	1 x 80	617			
8022	E352	893	116	169,1	134,3	41.400	31.410	32,2	25,6	49	32	6	3,60	7,60	2,30	4,40			D/D	1 x 80	1 x 80	650			
	E112	568	98	206,4	175,8	82.140	63.390	39,3	33,5	81	68	4	7,20	15,20	4,60	8,80	53	48	E/D	1 x 100	1 x 80	723			
	E122	649	106	198,2	168,6	85.040	65.710	37,7	32,1	17	19	2	7,20	15,20	4,60	8,80			E/D	1 x 100	1 x 80	769			
	E132	731	114	217,4	184,2	87.300	67.450	41,4	35,1	21	16	2	7,20	15,20	4,60	8,80			E/D	1 x 100	1 x 100	815			
	E212	758	117	237,6	197,6	77.950	59.620	45,2	37,6	66	47	4	7,20	15,20	4,60	8,80			E/D	1 x 100	1 x 100	778			
	E222	866	127	259,9	215,2	81.490	62.230	49,5	41,0	86	61	4	7,20	15,20	4,60	8,80			E/D	1 x 100	1 x 100	831			
	E232	974	138	250,4	207,6	84.080	64.550	47,7	39,5	20	14	2	7,20	15,20	4,60	8,80			E/D	1 x 100	1 x 100	884			
	E242	1082	149	268,8	222,1	86.010	66.000	51,2	42,3	24	17	2	7,20	15,20	4,60	8,80			D/D	1 x 100	1 x 100	943			
	E252	1191	159	285,1	235,6	87.630	67.450	54,3	44,9	28	20	2	7,20	15,20	4,60	8,80			D/D	1 x 100	1 x 100	1022			
	E332	1461	208	314,0	247,7	78.590	58.750	59,8	47,2	64	46	4	7,20	15,20	4,60	8,80			D/D	1 x 125	1 x 100	1041			
8023	E342	1623	224	330,8	262,3	80.850	61.070	63,0	49,9	76	55	4	7,20	15,20	4,60	8,80			D/D	1 x 125	1 x 100	1114			
	E352	1786	240	345,6	274,2	82.790	62.810	65,8	52,2	89	65	4	7,20	15,20	4,60	8,80			D/D	1 x 125	1 x 100	1208			
	E112	852	126	294,6	251,0	123.210	95.090	56,1	47,8	41	31	2	10,80	22,80	6,90	13,20	55	50	E/D	1 x 100	1 x 100	1025			
	E122	974	158	324,9	276,2	127.560	98.560	61,9	52,6	46	40	2	10,80	22,80	6,90	13,20			E/D	1 x 125	1 x 100	1111			
	E132	1096	170	351,0	297,9	130.470	101.170	66,8	56,7	58	43	2	10,80	22,80	6,90	13,20			E/D	1 x 125	1 x 125	1180			
	E212	1136	175	339,9	283,9	116.920	89.870	64,7	54,1	30	27	2	10,80	22,80	6,90	13,20			E/D	1 x 125	1 x 100	1125			
	E222	1299	191	374,5	310,3	122.240	93.350	71,3	59,1	39	28	2	10,80	22,80	6,90	13,20			E/D	1 x 125	1 x 125	1204			
	E232	1461	206	404,1	335,0	126.110	96.830	76,9	63,8	49	35	2	10,80	22,80	6,90	13,20			D/D	1 x 125	1 x 125	1284			
	E242	1623	222	429,6	353,7	129.020	98.560	81,8	67,3	59	41	2	10,80	22,80	6,90	13,20			D/D	1 x 125	1 x 125	1369			
	E252	1786	216	452,8	373,4	131.440	101.170	86,2	71,1	67	50	2	10,80	22,80	6,90	13,20			D/D	2 x 100	1 x 125	1470			
8024	E332	2192	259	456,7	360,8	117.880	88.130	87,0	68,7	31	23	2	10,80	22,80	6,90	13,20			D/D	2 x 100	1 x 125	1475			
	E342	2435	283	484,7	383,6	121.760	91.610	92,3	73,0	37	28	2	10,80	22,80	6,90	13,20			D/D	2 x 100	1 x 125	1581			
	E352	2679	304	506,6	402,6	124.180	94.220	96,5	76,7	44	33	2	10,80	22,80	6,90	13,20			D/D	2 x 100	1 x 125	1729			
	E112	1136	174	412,2	351,1	164.280	126.780	78,5	66,9	80	60	2	14,40	30,40	9,20	17,60	56	51	E/D	1 x 125	1 x 125	1313			
	E122	1299	168	451,7	383,5	170.080	131.420	86,0	73,0	103	80	2	14,40	30,40	9,20	17,60			E/D	2 x 100	1 x 125	1398			
	E132	1461	184	485,2	411,4	173.950	134.900	92,4	78,3	130	100	2	14,40	30,40	9,20	17,60			E/D	2 x 100	1 x 125	1491			
	E212	1515	191	474,5	394,7	155.890	119.240	90,4	75,2	62	48	2	14,40	30,40	9,20	17,60			E/D	2 x 100	1 x 125	1405			
	E222	1732	211	519,5	430,2	162.980	124.460	98,9	81,9	83	63	2	14,40	30,40	9,20	17,60			E/D	2 x 100	1 x 125	1526			
	E232	1948	232	557,5	461,8	168.150	129.100	106,2	87,9	104	74	2	14,40	30,40	9,20	17,60			D/D	2 x 100	2 x 100	1634			
	E242	2165	253	590,7	485,4	172.020	131.420	112,5	92,4	126	89	2	14,40	30,40	9,20	17,60			D/D	2 x 100	2 x 100	1777			
8025	E252	2381	294	619,9	510,6	175.250	134.900	118,0	97,2	142	106	2	14,40	30,40	9,20	17,60			D/D	2 x 125	2 x 100	1901			
	E332	2922	348	627,8	495,3	157.180	117.500	119,6	94,3	62	45	2	14,40	30,40	9,20	17,60			D/D	2 x 125	2 x 100	1935			
	E342	3247	380	661,5	524,4	161.690	122.140	126,0	99,9	74	54	2	14,40	30,40	9,20	17,60			D/D	2 x 125	2 x 100	2107			
	E352	3572	411	691,1	548,3	165.570	125.620	131,6	104,4	88	64	2	14,40	30,40	9,20	17,60			D/D	2 x 125	2 x 100	2244			
	E112	1421	180	530,1	451,3	205.340	158.470	100,9	85,9	148	111	2	18,00	38,00	11,50	22,00	57	52	E/D	2 x 100	2 x 100	1608			
	E122	1623	199	578,3	490,7	212.600	164.270	110,1	93,4	194	145	2	18,00	38,00	11,50	22,00			E/D	2 x 100	2 x 100	1724			
	E132	1826	240	619,4	524,8	217.440	168.620	117,9	99,9	237	182	2	18,00	38,00	11,50	22,00			E/D	2 x 125	2 x 100	1857			
	E212	1894	247	609,5	506,8	194.860	149.050	116,1	96,5	112	86	2	18,00	38,00	11,50	22,00			E/D	2 x 125	2 x 100	1765			
	E222	2165	273	664,3	549,6	203.730	155.580	126,5	104,7	147	111	2	18,00	38,00	11,50	22,00			E/D	2 x 125	2 x 100	1900			
	E232	2435	300	711,2	588,3	210.180	161.370	135,4	112,0	185	139	2	18,00	38,00	11,50	22,00			D/D	2 x 125	2 x 100	2034			
8026	E242	2706	326	751,4	616,9	215.020	164.270	143,1	117,5	224	158	2	18,00	38,00	11,50	22,00			D/D	2 x 125					



FD H/V 2E • Ø910 mm

Hatve / Fin Pitch: 2,1 mm

MODEL MODEL	Yüzey Surface	Boru Hacmi Tube Volume	Kapasite Capacity (Ethylen Glycol % 34 40/35°C 25°C)				Hava Debisi Air Flow				Glikol/Su Glycol/Water				Geçiş Sayısı No. of Pass	Motor Motor				Ses Seviyesi Noise Level	Enerji Verimliliği Sınıfı Energy Efficiency Class	Bağlantılar Connections		Ağırlık Weight
			S		S		Debi Flow		Basınç Kaybı Pressure Drop		3/400V 50 Hz					3/400V 50 Hz		3/400V 50 Hz				Giriş / Çıkış Inlet / Outlet		
			900 rpm	700 rpm	900 rpm	700 rpm	900 rpm	700 rpm	900 rpm	700 rpm	Toplam Güç / Total Power Toplam Akım / Total Current		S			S		S				S		
			Δ	Y	Δ	Y	Δ	Y	Δ	Y	Δ	Y	Δ	Y		Δ	Y	Δ	Y			Δ	Y	
m <sup>2</sup>	dm <sup>2</sup>	kW		m <sup>3</sup> /h		m <sup>3</sup> /h		kPa		n	kW		A		dB(A)		PN 10/ DN		kg					
9111	D111	136	28	57,1	48,2	26.040	19.810	10,9	9,2	24	18	6	1 x 1	3,30	6,20	2,30	4,00	62	56	E/E	1 x 50	1 x 50	258	
	D121	155	35	64,4	54,3	27.720	21.160	12,3	10,3	27	24	6		3,30	6,20	2,30	4,00			E/E	1 x 65	1 x 50	277	
	D131	174	38	70,9	59,9	29.020	22.280	13,5	11,4	34	30	6		3,30	6,20	2,30	4,00			E/E	1 x 65	1 x 50	291	
	D211	181	39	68,9	57,0	23.900	18.130	13,1	10,9	36	30	8		3,30	6,20	2,30	4,00			E/E	1 x 65	1 x 50	280	
	D221	207	43	73,5	60,8	25.760	19.590	14,0	11,6	22	20	6		3,30	6,20	2,30	4,00			E/E	1 x 65	1 x 50	296	
	D231	232	47	81,1	67,1	27.250	20.820	15,4	12,8	28	20	6		3,30	6,20	2,30	4,00			E/E	1 x 65	1 x 65	313	
	D241	258	51	87,8	72,7	28.460	21.830	16,7	13,8	35	25	6		3,30	6,20	2,30	4,00			E/E	1 x 65	1 x 65	329	
	D251	284	55	93,9	77,6	29.490	22.620	17,9	14,8	42	30	6		3,30	6,20	2,30	4,00			E/E	1 x 65	1 x 65	346	
	D331	349	67	89,9	72,0	24.370	18.470	17,1	13,7	19	13	6		3,30	6,20	2,30	4,00			E/E	1 x 65	1 x 65	356	
	D341	387	73	97,6	78,2	25.760	19.590	18,6	14,9	24	16	6		3,30	6,20	2,30	4,00			E/E	1 x 65	1 x 65	377	
D351	426	79	104,8	83,9	27.070	20.600	20,0	16,0	29	19	6	3,30	6,20	2,30	4,00	E/E	1 x 65	1 x 65	398					
9112	D111	271	53	98,5	82,8	52.080	39.620	18,8	15,8	11	8	2	1 x 2	6,60	12,40	4,60	8,00	65	59	E/E	1 x 65	1 x 65	425	
	D121	310	59	114,1	96,1	55.430	42.320	21,7	18,3	15	11	2		6,60	12,40	4,60	8,00			E/E	1 x 65	1 x 65	454	
	D131	349	69	127,9	108,0	58.040	44.560	24,4	20,6	13	14	2		6,60	12,40	4,60	8,00			E/E	1 x 80	1 x 65	468	
	D211	362	71	137,4	113,6	47.800	36.250	26,2	21,6	34	29	4		6,60	12,40	4,60	8,00			E/E	1 x 80	1 x 65	484	
	D221	413	79	154,2	127,4	51.520	39.170	29,4	24,3	47	33	4		6,60	12,40	4,60	8,00			E/E	1 x 80	1 x 80	497	
	D231	465	88	169,0	139,8	54.500	41.640	32,2	26,6	60	42	4		6,60	12,40	4,60	8,00			E/E	1 x 80	1 x 80	530	
	D241	517	96	161,0	133,3	56.920	43.660	30,6	25,4	16	11	2		6,60	12,40	4,60	8,00			E/E	1 x 80	1 x 80	570	
	D251	568	104	173,9	143,8	58.970	45.240	33,1	27,4	20	14	2		6,60	12,40	4,60	8,00			E/E	1 x 80	1 x 80	628	
	D331	697	133	186,8	149,4	48.730	36.930	35,6	28,4	33	27	4		6,60	12,40	4,60	8,00			E/E	1 x 100	1 x 80	627	
	D341	775	145	201,8	161,4	51.520	39.170	38,4	30,7	42	34	4		6,60	12,40	4,60	8,00			E/E	1 x 100	1 x 80	674	
D351	852	158	215,8	172,5	54.130	41.190	41,1	32,8	51	40	4	6,60	12,40	4,60	8,00	E/E	1 x 100	1 x 80	742					
9113	D111	407	78	170,2	143,6	78.110	59.430	32,4	27,3	24	18	2	1 x 3	9,90	18,60	6,90	12,00	67	61	E/E	1 x 80	1 x 80	624	
	D121	465	95	192,2	162,2	83.140	63.470	36,6	30,9	24	24	2		9,90	18,60	6,90	12,00			E/E	1 x 100	1 x 80	679	
	D131	523	104	211,8	179,0	87.050	66.840	40,3	34,1	32	30	2		9,90	18,60	6,90	12,00			E/E	1 x 100	1 x 80	722	
	D211	542	108	193,7	160,2	71.690	54.380	36,9	30,5	15	17	2		9,90	18,60	6,90	12,00			E/E	1 x 100	1 x 80	686	
	D221	620	120	219,5	181,5	77.280	58.760	41,8	34,6	21	15	2		9,90	18,60	6,90	12,00			E/E	1 x 100	1 x 100	736	
	D231	697	132	242,3	200,5	87.050	62.460	46,1	38,2	27	19	2		9,90	18,60	6,90	12,00			E/E	1 x 100	1 x 100	785	
	D241	775	144	262,6	217,4	85.380	65.490	50,0	41,4	34	24	2		9,90	18,60	6,90	12,00			E/E	1 x 100	1 x 100	841	
	D251	852	155	281,2	232,3	88.450	67.850	53,5	44,2	42	30	2		9,90	18,60	6,90	12,00			E/E	1 x 100	1 x 100	930	
	D331	1046	188	268,8	215,3	73.090	55.390	51,2	41,0	21	14	2		9,90	18,60	6,90	12,00			E/E	1 x 100	1 x 100	911	
	D341	1162	207	292,0	234,0	77.280	58.760	55,6	44,6	25	17	2		9,90	18,60	6,90	12,00			E/E	1 x 100	1 x 100	980	
D351	1279	232	314,0	251,3	81.190	61.790	59,8	47,9	24	21	2	9,90	18,60	6,90	12,00	E/E	1 x 125	1 x 100	1101					
9114	D111	542	107	241,5	203,7	104.150	79.240	46,0	38,8	41	30	2	1 x 4	13,20	24,80	9,20	16,00	68	62	E/E	1 x 100	1 x 100	798	
	D121	620	118	270,5	228,1	110.850	84.630	51,5	43,4	58	42	2		13,20	24,80	9,20	16,00			E/E	1 x 100	1 x 100	867	
	D131	697	130	296,0	249,0	116.070	88.670	56,4	47,4	75	55	2		13,20	24,80	9,20	16,00			E/E	1 x 100	1 x 100	926	
	D211	723	136	274,3	226,8	95.590	72.500	52,2	43,2	35	25	2		13,20	24,80	9,20	16,00			E/E	1 x 100	1 x 100	864	
	D221	827	161	308,2	254,6	103.030	78.340	58,7	48,5	42	34	2		13,20	24,80	9,20	16,00			E/E	1 x 125	1 x 100	956	
	D231	930	177	337,8	279,4	108.990	83.280	64,3	53,2	54	44	2		13,20	24,80	9,20	16,00			E/E	1 x 125	1 x 100	1024	
	D241	1033	193	364,2	301,3	113.830	87.320	69,3	57,4	68	48	2		13,20	24,80	9,20	16,00			E/E	1 x 125	1 x 125	1128	
	D251	1137	209	388,0	320,3	117.930	90.470	73,9	61,0	82	59	2		13,20	24,80	9,20	16,00			E/E	1 x 125	1 x 125	1196	
	D331	1395	250	373,4	298,6	97.450	73.850	71,1	56,9	36	24	2		13,20	24,80	9,20	16,00			E/E	1 x 125	1 x 125	1200	
	D341	1550	275	403,4	322,8	103.030	78.340	76,8	61,5	44	30	2		13,20	24,80	9,20	16,00			E/E	1 x 125	1 x 125	1322	
D351	1705	299	431,6	344,9	108.250	82.380	82,2	65,7	54	36	2	13,20	24,80	9,20	16,00	E/E	1 x 125	1 x 125	1409					
9115	D111	678	137	313,1	264,0	130.190	99.050	59,6	50,3	74	59	2	1 x 5	16,50	31,00	11,50	20,00	69	63	E/E	1 x 125	1 x 100	1013	
	D121	775	152	348,7	293,7	138.570	105.790	66,4	55,9	100	80	2		16,50	31,00	11,50	20,00			E/E	1 x 125	1 x 100	1086	
	D131	872	167	380,0	319,5	145.080	110.840	72,4	60,8	130	95	2		16,50	31,00	11,50	20,00			E/E	1 x 125	1 x 125	1160	
	D211	904	173	355,2	293,3	119.480	90.630	67,6	55,9	58	47	2		16,50	31,00	11,50	20,00			E/E	1 x 125	1 x 100	1099	
	D221	1033	193	396,6	327,3	128.790	97.930	75,5	62,3	79	56	2		16,50	31,00	11,50	20,00			E/E	1 x 125	1 x 125	1185	
	D231	1162	213	433,2	358,0	136.240	104.100	82,5	68,2	102	73	2		16,50	31,00	11,50	20,00			E/E	1 x 125	1 x 125	1270	
	D241	1292	223	465,6	384,9	142.290	109.150	88,7	73,3	123	91	2		16,50	31,00	11,50	20,00			E/E	2 x 100	1 x 125	1358	
	D251	1421	243	495,2	408,2	147.410	113.080	94,3	77,7	149	109	2		16,50	31,00	11,50	20,00			E/E	2 x 100	1 x 125	1466	
	D331	1744	294	477,3	381,3	121.810	92.310	90,9	72,6	61	44	2		16,50	31,00	11,50	20,00			E/E	2 x 100	1 x 125	1480	
	D341	1937	325	514,3	411,0	128.790	97.930	97,9	78,3	76	54	2												

### FD H/V 2E • Ø910 mm

### Hatve / Fin Pitch: 2,1 mm

MODEL MODEL	Yüzey Surface	Boru Hacmi Tube Volume	Kapasite Capacity (Ethylen Glycol % 34 40/35°C 25°C)				Hava Debisi Air Flow				Glikol/Su Glycol/Water				Geçiş Sayısı No. of Pass	Motor Motor				Ses Seviyesi Noise Level	Enerji Verimliliği Sınıfı Energy Efficiency Class	Bağlantılar Connections		Ağırlık Weight
			S		S		Debi Flow		Basınç Kaybı Pressure Drop		3/400V 50 Hz					3/400V 50 Hz		3/400V 50 Hz				Giriş / Çıkış Inlet / Outlet		
			900 rpm	700 rpm	900 rpm	700 rpm	900 rpm	700 rpm	900 rpm	700 rpm	Toplam Güç / Total Power Toplam Akım / Total Current		S			S		S 900 rpm	S 700 rpm					
			Δ	Y	Δ	Y	Δ	Y	Δ	Y	Δ	Y	Δ	Y		Δ	Y					Δ	Y	
			m <sup>2</sup>	dm <sup>3</sup>	kW		m <sup>3</sup> /h		m <sup>3</sup> /h		kPa		n	kW		A		dB(A)				PN 10/ DN		
9121	D111	253	59	115,6	97,3	50.220	38.050	22,0	18,5	55	40	8	2 x 1	6,60	12,40	4,60	8,00	65	59	E/E	1 x 65	1 x 65	433	
	D121	289	64	123,1	103,9	53.750	40.970	23,4	19,8	36	26	6		6,60	12,40	4,60	8,00			E/E	1 x 65	1 x 65	456	
	D131	325	77	135,9	114,6	56.550	43.220	25,9	21,8	39	34	6		6,60	12,40	4,60	8,00			E/E	1 x 80	1 x 65	490	
	D211	338	80	130,9	108,2	45.750	34.680	24,9	20,6	40	33	8		6,60	12,40	4,60	8,00			E/E	1 x 80	1 x 65	475	
	D221	386	81	125,1	103,5	49.660	37.830	23,8	19,7	17	12	4		6,60	12,40	4,60	8,00			E/E	1 x 65	1 x 65	493	
	D231	434	95	141,0	116,7	52.820	40.300	26,9	22,2	14	15	4		6,60	12,40	4,60	8,00			E/E	1 x 80	1 x 65	531	
	D241	482	103	155,3	128,4	55.430	42.320	29,6	24,4	18	12	4		6,60	12,40	4,60	8,00			E/E	1 x 80	1 x 80	558	
	D251	530	110	167,9	139,0	57.480	44.110	32,0	26,5	21	15	4		6,60	12,40	4,60	8,00			E/E	1 x 80	1 x 80	586	
	D331	651	131	171,3	137,3	46.680	35.360	32,6	26,1	25	16	6		6,60	12,40	4,60	8,00			E/E	1 x 80	1 x 80	610	
	D341	723	157	186,9	150,2	49.660	37.830	35,6	28,6	23	20	6		6,60	12,40	4,60	8,00			E/E	1 x 100	1 x 80	667	
D351	796	169	201,1	161,3	52.260	39.850	38,3	30,7	27	25	6	6,60	12,40	4,60	8,00	E/E	1 x 100	1 x 80	703					
9122	D111	506	120	230,4	194,0	100.430	76.100	43,9	36,9	45	33	4	2 x 2	13,20	24,80	9,20	16,00	68	62	E/E	1 x 100	1 x 100	752	
	D121	579	132	218,0	183,7	107.500	81.940	41,5	35,0	12	9	2		13,20	24,80	9,20	16,00			E/E	1 x 100	1 x 100	801	
	D131	651	143	245,2	206,7	113.090	86.430	46,7	39,4	16	11	2		13,20	24,80	9,20	16,00			E/E	1 x 100	1 x 100	848	
	D211	675	148	260,9	215,8	91.490	69.360	49,7	41,1	38	27	4		13,20	24,80	9,20	16,00			E/E	1 x 100	1 x 100	814	
	D221	771	163	294,2	242,6	99.310	75.200	56,0	46,2	51	36	4		13,20	24,80	9,20	16,00			E/E	1 x 100	1 x 100	870	
	D231	868	178	280,5	232,3	105.640	80.590	53,4	44,2	16	11	2		13,20	24,80	9,20	16,00			E/E	1 x 100	1 x 100	926	
	D241	964	213	309,4	255,8	110.850	84.630	58,9	48,7	13	14	2		13,20	24,80	9,20	16,00			E/E	1 x 125	1 x 100	1004	
	D251	1061	228	334,7	277,2	114.950	88.220	63,7	52,8	16	17	2		13,20	24,80	9,20	16,00			E/E	1 x 125	1 x 100	1086	
	D331	1302	268	355,9	284,7	93.350	70.710	67,8	54,2	37	31	4		13,20	24,80	9,20	16,00			E/E	1 x 125	1 x 100	1097	
	D341	1446	290	386,4	310,0	99.310	75.650	73,6	59,0	46	31	4		13,20	24,80	9,20	16,00			E/E	1 x 125	1 x 125	1175	
D351	1591	313	414,1	331,7	104.520	79.690	78,8	63,2	57	38	4	13,20	24,80	9,20	16,00	E/E	1 x 125	1 x 125	1274					
9123	D111	759	179	324,0	273,0	150.640	114.140	61,7	52,0	20	20	2	2 x 3	19,80	37,20	13,80	24,00	70	64	E/E	1 x 125	1 x 100	1090	
	D121	868	196	367,3	310,0	161.250	122.900	69,9	59,0	28	21	2		19,80	37,20	13,80	24,00			E/E	1 x 125	1 x 125	1161	
	D131	976	213	406,0	342,3	169.630	129.640	77,3	65,2	37	27	2		19,80	37,20	13,80	24,00			E/E	1 x 125	1 x 125	1232	
	D211	1013	220	367,6	304,4	137.240	104.040	70,0	58,0	18	13	2		19,80	37,20	13,80	24,00			E/E	1 x 125	1 x 125	1182	
	D221	1157	243	418,6	345,6	148.960	112.800	79,7	65,8	25	18	2		19,80	37,20	13,80	24,00			E/E	1 x 125	1 x 125	1265	
	D231	1302	247	464,1	384,1	158.460	120.880	88,4	73,1	28	23	2		19,80	37,20	13,80	24,00			E/E	2 x 100	1 x 125	1333	
	D241	1446	269	504,8	417,0	166.280	126.940	96,1	79,4	35	29	2		19,80	37,20	13,80	24,00			E/E	2 x 100	1 x 125	1422	
	D251	1591	289	541,1	447,9	172.420	132.330	103,0	85,3	44	35	2		19,80	37,20	13,80	24,00			E/E	2 x 100	1 x 125	1560	
	D331	1953	351	512,1	410,4	140.030	106.060	97,5	78,1	21	17	2		19,80	37,20	13,80	24,00			E/E	2 x 100	1 x 125	1566	
	D341	2170	386	559,1	449,2	148.960	113.470	106,5	85,5	26	22	2		19,80	37,20	13,80	24,00			E/E	2 x 100	1 x 125	1680	
D351	2387	434	602,2	483,2	156.780	119.530	114,7	92,0	25	21	2	19,80	37,20	13,80	24,00	E/E	2 x 125	2 x 100	1873					
9124	D111	1013	200	459,8	387,2	200.850	152.190	87,5	73,7	42	34	2	2 x 4	26,40	49,60	18,40	32,00	71	65	E/E	2 x 100	1 x 125	1362	
	D121	1157	220	516,8	435,9	215.000	163.870	98,4	83,0	59	48	2		26,40	49,60	18,40	32,00			E/E	2 x 100	1 x 125	1479	
	D131	1302	243	567,6	478,3	226.170	172.850	108,1	91,1	77	57	2		26,40	49,60	18,40	32,00			E/E	2 x 100	2 x 100	1577	
	D211	1350	254	520,7	430,8	182.980	138.720	99,2	82,0	35	29	2		26,40	49,60	18,40	32,00			E/E	2 x 100	1 x 125	1485	
	D221	1543	281	588,0	484,8	198.620	150.390	112,0	92,3	50	35	2		26,40	49,60	18,40	32,00			E/E	2 x 100	2 x 100	1625	
	D231	1736	331	647,2	535,1	211.280	161.170	123,2	101,9	56	45	2		26,40	49,60	18,40	32,00			E/E	2 x 125	2 x 100	1756	
	D241	1929	361	700,2	578,2	221.700	169.250	133,3	110,1	71	57	2		26,40	49,60	18,40	32,00			E/E	2 x 125	2 x 100	1906	
	D251	2122	391	746,8	617,5	229.890	176.440	142,2	117,6	86	61	2		26,40	49,60	18,40	32,00			E/E	2 x 125	2 x 125	2026	
	D331	2604	468	711,4	569,3	186.700	141.410	135,5	108,4	36	30	2		26,40	49,60	18,40	32,00			E/E	2 x 125	2 x 100	2081	
	D341	2893	513	772,5	619,8	198.620	151.290	147,1	118,0	46	31	2		26,40	49,60	18,40	32,00			E/E	2 x 125	2 x 125	2265	
D351	3182	558	827,9	663,3	209.040	159.370	157,6	126,3	56	37	2	26,40	49,60	18,40	32,00	E/E	2 x 125	2 x 125	2413					
9125	D111	1266	256	596,0	501,5	251.060	190.240	113,5	95,5	76	60	2	2 x 5	33,00	62,00	23,00	40,00	72	66	E/E	2 x 125	2 x 100	1720	
	D121	1446	284	666,4	561,5	268.750	204.830	126,9	106,9	74	63	2		33,00	62,00	23,00	40,00			E/E	2 x 125	2 x 100	1842	
	D131	1627	313	728,8	613,7	282.710	216.060	138,8	116,9	135	100	2		33,00	62,00	23,00	40,00			E/E	2 x 125	2 x 125	1964	
	D211	1688	323	674,3	557,2	228.720	173.400	128,4	106,1	59	48	2		33,00	62,00	23,00	40,00			E/E	2 x 125	2 x 100	1880	
	D221	1929	361	756,8	623,4	248.270	187.990	144,1	118,7	82	58	2		33,00	62,00	23,00	40,00			E/E	2 x 125	2 x 125	2024	
	D231	2170	398	830,0	686,0	264.090	201.460	158,0	130,6	106	76	2		33,00	62,00	23,00	40,00			E/E	2 x 125	2 x 125	2167	
	D241	2411	436	895,4	738,7	277.130	211.570	170,5	140,7	133	95	2		33,00	62,00	23,00	40,00			E/E	2 x 125	2 x 125	2321	
	D251	2652	473	952,7	787,2	287.370	220.550	181,4	149,9	155	115	2		33,00	62,00	23,00	40,00			E/E	3 x 125	2 x 125	2490	
	D331	3255	569	909,6	726,9	233.380	176.760	173,2																

FD H/V 2E • Ø910 mm

Hatve / Fin Pitch: 2,1 mm

MODEL MODEL	Yüzey Surface	Boru Hacmi Tube Volume	Kapasite Capacity (Ethylen Glycol % 34 40/35°C 25°C)				Hava Debisi Air Flow				Glikol/Su Glycol/Water				Geçiş Sayısı No. of Pass	Motor Motor				Ses Seviyesi Noise Level		Enerji Verimliliği Sınıfı Energy Efficiency Class		Bağlantılar Connections		Ağırlık Weight
			S		S		Debi Flow		Basınç Kaybı Pressure Drop		3/400V 50 Hz					3/400V 50 Hz		3/400V 50 Hz		Giriş / Çıkış Inlet / Outlet						
			900 rpm	700 rpm	900 rpm	700 rpm	900 rpm	700 rpm	900 rpm	700 rpm	Toplam Güç / Total Power Toplam Akım / Total Current		S			S		S		S						
			Δ	Y	Δ	Y	Δ	Y	Δ	Y	Δ	Y	Δ	Y		Δ	Y	Δ	Y	Δ	Y	Δ	Y			
m <sup>2</sup>	dm <sup>2</sup>	kW		m <sup>3</sup> /h		m <sup>3</sup> /h		kPa		n	kW		A		dB(A)		PN 10/ DN		kg							
9121	D112	271	63	114,2	96,4	52.080	39.620	21,8	18,4	27	20	6	6,60	12,40	4,60	8,00	65	59	E/E	1 x 65	1 x 65	449				
	D122	310	76	128,8	108,7	55.430	42.320	24,5	20,7	30	27	6	6,60	12,40	4,60	8,00	65	59	E/E	1 x 80	1 x 65	485				
	D132	349	82	141,8	119,8	58.040	44.560	27,0	22,8	38	34	6	6,60	12,40	4,60	8,00	65	59	E/E	1 x 80	1 x 65	510				
	D212	362	85	137,9	114,0	47.800	36.250	26,3	21,7	39	33	8	6,60	12,40	4,60	8,00	65	59	E/E	1 x 80	1 x 65	494				
	D222	413	94	131,1	108,2	51.520	39.170	25,0	20,6	11	12	4	6,60	12,40	4,60	8,00	65	59	E/E	1 x 80	1 x 65	523				
	D232	465	102	147,3	121,8	54.500	41.640	28,0	23,2	14	16	4	6,60	12,40	4,60	8,00	65	59	E/E	1 x 80	1 x 65	554				
	D242	517	110	161,6	133,8	56.920	43.660	30,8	25,5	18	13	4	6,60	12,40	4,60	8,00	65	59	E/E	1 x 80	1 x 80	583				
	D252	568	118	174,5	144,2	58.970	45.240	33,2	27,5	21	15	4	6,60	12,40	4,60	8,00	65	59	E/E	1 x 80	1 x 80	612				
	D332	697	156	179,9	144,0	48.730	36.930	34,3	27,4	18	17	6	6,60	12,40	4,60	8,00	65	59	E/E	1 x 100	1 x 80	662				
	D342	775	168	195,3	156,4	51.520	39.170	37,2	29,8	22	21	6	6,60	12,40	4,60	8,00	65	59	E/E	1 x 100	1 x 80	699				
9122	D352	852	181	209,7	167,8	54.130	41.190	39,9	31,9	27	25	6	6,60	12,40	4,60	8,00	68	62	E/E	1 x 100	1 x 80	737				
	D112	542	129	242,0	204,1	104.150	79.240	46,1	38,9	45	33	4	13,20	24,80	9,20	16,00	68	62	E/E	1 x 100	1 x 100	782				
	D122	620	141	228,1	192,2	110.850	84.630	43,4	36,6	12	9	2	13,20	24,80	9,20	16,00	68	62	E/E	1 x 100	1 x 100	832				
	D132	697	153	255,8	216,0	116.070	89.120	48,7	41,1	16	12	2	13,20	24,80	9,20	16,00	68	62	E/E	1 x 100	1 x 100	883				
	D212	723	158	274,9	227,3	95.590	72.500	52,3	43,3	38	27	4	13,20	24,80	9,20	16,00	68	62	E/E	1 x 100	1 x 100	848				
	D222	827	195	308,4	254,7	103.030	78.340	58,7	48,5	44	36	4	13,20	24,80	9,20	16,00	68	62	E/E	1 x 125	1 x 100	925				
	D232	930	191	293,1	242,5	108.990	83.280	55,8	46,2	17	12	2	13,20	24,80	9,20	16,00	68	62	E/E	1 x 100	1 x 100	966				
	D242	1033	228	321,9	266,6	113.830	87.320	61,3	50,8	13	15	2	13,20	24,80	9,20	16,00	68	62	E/E	1 x 125	1 x 100	1049				
	D252	1137	244	347,9	287,6	117.930	90.470	66,2	54,8	16	17	2	13,20	24,80	9,20	16,00	68	62	E/E	1 x 125	1 x 100	1134				
	D332	1395	287	373,5	298,8	97.450	73.850	71,1	56,9	37	24	4	13,20	24,80	9,20	16,00	68	62	E/E	1 x 125	1 x 125	1150				
9123	D342	1550	311	403,5	322,9	103.030	78.340	76,8	61,5	46	30	4	13,20	24,80	9,20	16,00	68	62	E/E	1 x 125	1 x 125	1232				
	D352	1705	336	431,7	344,9	108.250	82.380	82,2	65,7	55	37	4	13,20	24,80	9,20	16,00	68	62	E/E	1 x 125	1 x 125	1336				
	D112	814	192	340,4	287,3	156.220	118.860	64,8	54,7	21	21	2	19,80	37,20	13,80	24,00	70	64	E/E	1 x 125	1 x 100	1131				
	D122	930	210	384,5	324,4	166.280	126.940	73,2	61,8	28	21	2	19,80	37,20	13,80	24,00	70	64	E/E	1 x 125	1 x 125	1206				
	D132	1046	229	423,7	357,9	174.100	133.680	80,7	68,2	36	27	2	19,80	37,20	13,80	24,00	70	64	E/E	1 x 125	1 x 125	1281				
	D212	1085	236	387,4	320,5	143.380	108.750	73,8	61,0	19	13	2	19,80	37,20	13,80	24,00	70	64	E/E	1 x 125	1 x 125	1230				
	D222	1240	260	438,9	362,9	154.550	117.510	83,6	69,1	26	18	2	19,80	37,20	13,80	24,00	70	64	E/E	1 x 125	1 x 125	1318				
	D232	1395	284	484,5	401,0	163.490	124.920	92,3	76,4	28	23	2	19,80	37,20	13,80	24,00	70	64	E/E	2 x 100	1 x 125	1390				
	D242	1550	269	525,1	434,7	170.750	130.980	100,0	82,8	34	29	2	19,80	37,20	13,80	24,00	70	64	E/E	2 x 100	1 x 125	1484				
	D252	1705	309	562,3	464,7	176.890	135.700	107,1	88,5	43	30	2	19,80	37,20	13,80	24,00	70	64	E/E	2 x 100	2 x 100	1628				
9124	D332	2092	376	537,7	430,6	146.170	110.780	102,4	82,0	21	18	2	19,80	37,20	13,80	24,00	70	64	E/E	2 x 100	1 x 125	1640				
	D342	2325	413	584,1	468,0	154.550	117.510	111,2	89,1	26	17	2	19,80	37,20	13,80	24,00	70	64	E/E	2 x 100	2 x 100	1760				
	D352	2557	465	628,0	502,6	162.370	123.570	119,6	95,7	25	21	2	19,80	37,20	13,80	24,00	70	64	E/E	2 x 125	2 x 100	1964				
	D112	1085	214	483,0	407,4	208.300	158.480	92,0	77,6	42	34	2	26,40	49,60	18,40	32,00	71	65	E/E	2 x 100	1 x 125	1413				
	D122	1240	236	541,0	456,1	221.700	169.250	103,0	86,9	58	43	2	26,40	49,60	18,40	32,00	71	65	E/E	2 x 100	2 x 100	1537				
	D132	1395	260	592,0	498,1	232.130	177.340	112,7	94,8	75	55	2	26,40	49,60	18,40	32,00	71	65	E/E	2 x 100	2 x 100	1640				
	D212	1446	272	548,6	453,6	191.170	145.000	104,5	86,4	36	25	2	26,40	49,60	18,40	32,00	71	65	E/E	2 x 100	2 x 100	1544				
	D222	1653	322	616,4	509,1	206.060	156.680	117,4	96,9	42	35	2	26,40	49,60	18,40	32,00	71	65	E/E	2 x 125	2 x 100	1711				
	D232	1860	354	675,7	558,9	217.980	166.560	128,7	106,4	55	45	2	26,40	49,60	18,40	32,00	71	65	E/E	2 x 125	2 x 100	1832				
	D242	2066	386	728,4	602,7	227.660	174.640	138,7	114,8	68	49	2	26,40	49,60	18,40	32,00	71	65	E/E	2 x 125	2 x 125	1989				
9125	D252	2273	418	776,0	640,5	235.850	180.930	147,8	122,0	83	59	2	26,40	49,60	18,40	32,00	71	65	E/E	2 x 125	2 x 125	2119				
	D332	2790	501	746,8	597,3	194.890	147.700	142,2	113,7	36	24	2	26,40	49,60	18,40	32,00	71	65	E/E	2 x 125	2 x 125	2181				
	D342	3100	549	806,8	645,6	206.060	156.680	153,6	122,9	45	30	2	26,40	49,60	18,40	32,00	71	65	E/E	2 x 125	2 x 125	2374				
	D352	3410	597	863,2	689,7	216.490	164.760	164,4	131,3	54	36	2	26,40	49,60	18,40	32,00	71	65	E/E	2 x 125	2 x 125	2532				
	D112	1356	275	626,2	528,0	260.370	198.090	119,2	100,5	74	60	2	33,00	62,00	23,00	40,00	72	66	E/E	2 x 125	2 x 100	1785				
	D122	1550	305	697,3	587,5	277.130	211.570	132,8	111,9	101	81	2	33,00	62,00	23,00	40,00	72	66	E/E	2 x 125	2 x 100	1913				
	D132	1744	335	760,0	639,1	290.160	221.670	144,7	121,7	130	95	2	33,00	62,00	23,00	40,00	72	66	E/E	2 x 125	2 x 125	2042				
	D212	1808	346	710,3	586,7	238.960	181.250	135,3	111,7	58	48	2	33,00	62,00	23,00	40,00	72	66	E/E	2 x 125	2 x 100	1956				
	D222	2066	386	793,3	654,6	257.580	195.850	151,1	124,6	80	56	2	33,00	62,00	23,00	40,00	72	66	E/E	2 x 125	2 x 125	2108				
	D232	2325	426	866,4	716,0	272.470	208.200	165,0	136,3	103	73	2														

FD H/V 2E • Ø910 mm

Hatve / Fin Pitch: 2,1 mm

MODEL MODEL	Yüzey Surface	Boru Hacmi Tube Volume	Kapasite Capacity (Ethylen Glycol % 34 40/35°C 25°C)		Hava Debisi Air Flow		Glikol/Su Glycol/Water				Geçiş Sayısı No. of Pass	Motor Motor				Ses Seviyesi Noise Level	Enerji Verimliliği Sınıfı Energy Efficiency Class	Bağlantılar Connections		Ağırlık Weight		
			S		S		Debi Flow		Basınç Kaybı Pressure Drop			3/400V 50 Hz		3/400V 50 Hz				3/400V 50 Hz			Giriş / Çıkış Inlet / Outlet	
			900 rpm	700 rpm	900 rpm	700 rpm	900 rpm	700 rpm	900 rpm	700 rpm		Toplam Güç / Total Power Toplam Akım / Total Current		S				S	S			S
			Δ	Y	Δ	Y	Δ	Y	Δ	Y		Δ	Y	Δ	Y			Δ	Y		900/700 rpm	S 900 rpm
m <sup>2</sup>	dm <sup>3</sup>	kW		m <sup>3</sup> /h		m <sup>3</sup> /h		kPa		n	kW		A		dB(A)		PN 10/ DN	kg				
9111	E111	142	20	58,4	49,9	27.440	20.940	11,1	9,5	55	41	6	3,30	6,20	2,30	4,00	62	56	E/E	1 x 50	1 x 50	250
	E121	162	25	65,3	55,8	28.930	22.170	12,4	10,6	68	55	6	3,30	6,20	2,30	4,00	62	56	E/E	1 x 65	1 x 50	267
	E131	183	27	71,5	61,0	30.140	23.180	13,6	11,6	88	71	6	3,30	6,20	2,30	4,00	62	56	E/E	1 x 65	1 x 50	280
	E211	189	28	70,7	59,3	25.390	19.360	13,5	11,3	94	73	8	3,30	6,20	2,30	4,00	62	56	E/E	1 x 65	1 x 50	268
	E221	216	31	75,7	63,3	27.160	20.710	14,4	12,1	55	39	6	3,30	6,20	2,30	4,00	62	56	E/E	1 x 65	1 x 65	283
	E231	244	34	82,9	69,3	28.550	21.830	15,8	13,2	70	51	6	3,30	6,20	2,30	4,00	62	56	E/E	1 x 65	1 x 65	298
	E241	271	36	89,4	74,6	29.670	22.730	17,0	14,2	87	63	6	3,30	6,20	2,30	4,00	62	56	E/E	1 x 65	1 x 65	314
	E251	298	39	95,1	79,2	30.510	23.410	18,1	15,1	105	76	6	3,30	6,20	2,30	4,00	62	56	E/E	1 x 65	1 x 65	329
	E331	365	46	94,2	76,1	25.860	19.590	17,9	14,5	46	31	6	3,30	6,20	2,30	4,00	62	56	E/E	1 x 65	1 x 65	335
	E341	406	50	101,6	81,9	27.160	20.600	19,4	15,6	57	38	6	3,30	6,20	2,30	4,00	62	56	E/E	1 x 65	1 x 65	353
E351	446	54	108,2	86,8	28.280	21.390	20,6	16,5	68	46	6	3,30	6,20	2,30	4,00	62	56	E/D	1 x 65	1 x 65	372	
9112	E111	284	37	104,7	89,4	54.870	41.870	19,9	17,0	19	14	2	6,60	12,40	4,60	8,00	65	59	E/E	1 x 80	1 x 65	409
	E121	325	41	119,1	101,8	57.850	44.340	22,7	19,4	26	19	2	6,60	12,40	4,60	8,00	65	59	E/E	1 x 80	1 x 65	435
	E131	365	49	132,1	112,8	60.270	46.360	25,2	21,5	27	25	2	6,60	12,40	4,60	8,00	65	59	E/E	1 x 80	1 x 65	467
	E211	379	51	141,1	118,3	50.770	38.720	26,9	22,5	86	68	4	6,60	12,40	4,60	8,00	65	59	E/E	1 x 80	1 x 65	442
	E221	433	56	157,2	131,4	54.310	41.420	29,9	25,0	116	84	4	6,60	12,40	4,60	8,00	65	59	E/E	1 x 80	1 x 80	473
	E231	487	61	171,5	143,2	57.100	43.660	32,7	27,3	150	108	4	6,60	12,40	4,60	8,00	65	59	E/E	1 x 80	1 x 80	503
	E241	541	67	167,2	139,7	59.340	45.460	31,8	26,6	31	22	2	6,60	12,40	4,60	8,00	65	59	E/E	1 x 80	1 x 80	539
	E251	595	72	179,1	149,4	61.010	46.810	34,1	28,4	38	27	2	6,60	12,40	4,60	8,00	65	59	E/E	1 x 80	1 x 80	584
	E331	731	94	194,2	156,6	51.710	39.170	37,0	29,8	89	66	4	6,60	12,40	4,60	8,00	65	59	E/E	1 x 100	1 x 80	595
	E341	812	102	208,7	167,9	54.310	41.190	39,7	32,0	111	82	4	6,60	12,40	4,60	8,00	65	59	E/E	1 x 100	1 x 80	629
E351	433	56	157,2	177,5	54.310	42.770	42,2	33,8	116	97	4	6,60	12,40	4,60	8,00	65	59	E/D	1 x 80	1 x 80	691	
9113	E111	426	55	174,4	149,0	82.300	62.800	33,2	28,4	51	38	2	9,90	18,60	6,90	12,00	67	61	E/E	1 x 80	1 x 80	599
	E121	487	69	195,1	166,7	86.770	66.500	37,2	31,7	60	52	2	9,90	18,60	6,90	12,00	67	61	E/E	1 x 100	1 x 80	651
	E131	548	75	213,8	182,5	90.400	69.540	40,7	34,8	78	59	2	9,90	18,60	6,90	12,00	67	61	E/E	1 x 100	1 x 100	700
	E211	568	77	201,9	169,2	76.440	58.080	38,4	32,2	36	33	2	9,90	18,60	6,90	12,00	67	61	E/E	1 x 100	1 x 80	653
	E221	649	85	226,2	189,3	81.470	62.130	43,1	36,1	50	36	2	9,90	18,60	6,90	12,00	67	61	E/E	1 x 100	1 x 100	698
	E231	731	93	248,1	207,4	85.650	65.490	47,2	39,5	65	47	2	9,90	18,60	6,90	12,00	67	61	E/E	1 x 100	1 x 100	744
	E241	812	101	267,6	223,3	89.010	68.190	51,0	42,5	81	58	2	9,90	18,60	6,90	12,00	67	61	E/E	1 x 100	1 x 100	795
	E251	893	108	284,8	237,3	91.520	70.210	54,2	45,2	100	72	2	9,90	18,60	6,90	12,00	67	61	E/E	1 x 100	1 x 100	871
	E331	1096	129	282,0	227,8	77.560	58.760	53,7	43,4	45	30	2	9,90	18,60	6,90	12,00	67	61	E/E	1 x 100	1 x 100	849
	E341	1218	152	304,2	245,2	81.470	61.790	57,9	46,7	49	37	2	9,90	18,60	6,90	12,00	67	61	E/E	1 x 125	1 x 100	921
E351	1339	162	324,3	260,1	84.820	64.150	61,8	49,5	61	46	2	9,90	18,60	6,90	12,00	67	61	E/D	1 x 125	1 x 100	1012	
9114	E111	568	77	244,2	208,5	109.740	83.730	46,5	39,7	103	77	2	13,20	24,80	9,20	16,00	68	62	E/E	1 x 100	1 x 100	766
	E121	649	84	271,3	231,6	115.690	88.670	51,7	44,1	142	107	2	13,20	24,80	9,20	16,00	68	62	E/E	1 x 100	1 x 100	825
	E131	731	92	296,0	252,5	120.530	92.710	56,4	48,1	184	139	2	13,20	24,80	9,20	16,00	68	62	E/E	1 x 100	1 x 100	878
	E211	758	96	281,7	236,3	101.540	77.440	53,6	45,0	84	61	2	13,20	24,80	9,20	16,00	68	62	E/E	1 x 100	1 x 100	821
	E221	866	116	314,2	262,7	108.620	82.830	59,8	50,0	109	84	2	13,20	24,80	9,20	16,00	68	62	E/E	1 x 125	1 x 100	899
	E231	974	126	342,8	286,2	114.200	87.320	65,3	54,5	141	108	2	13,20	24,80	9,20	16,00	68	62	E/E	1 x 125	1 x 100	960
	E241	1082	137	367,5	307,1	118.300	90.920	70,0	58,5	176	128	2	13,20	24,80	9,20	16,00	68	62	E/E	1 x 125	1 x 125	1057
	E251	1191	147	390,4	325,0	122.020	93.610	74,3	61,9	213	154	2	13,20	24,80	9,20	16,00	68	62	E/E	1 x 125	1 x 125	1118
	E331	1461	174	388,3	313,1	103.410	78.340	73,9	59,6	90	61	2	13,20	24,80	9,20	16,00	68	62	E/E	1 x 125	1 x 125	1104
	E341	1623	190	417,2	335,8	108.620	82.380	79,5	63,9	112	76	2	13,20	24,80	9,20	16,00	68	62	E/E	1 x 125	1 x 125	1216
E351	1786	206	443,2	354,9	113.090	85.530	84,4	67,6	136	91	2	13,20	24,80	9,20	16,00	68	62	E/D	1 x 125	1 x 125	1292	
9115	E111	710	100	314,3	268,2	137.170	104.660	59,9	51,1	193	151	2	16,50	31,00	11,50	20,00	69	63	E/E	1 x 125	1 x 100	966
	E121	812	110	347,7	296,7	144.620	110.840	66,2	56,5	261	197	2	16,50	31,00	11,50	20,00	69	63	E/E	1 x 125	1 x 125	1033
	E131	913	120	378,2	322,4	150.670	115.890	72,0	61,4	337	254	2	16,50	31,00	11,50	20,00	69	63	E/E	1 x 125	1 x 125	1100
	E211	947	124	362,2	303,4	126.930	96.800	69,0	57,8	152	111	2	16,50	31,00	11,50	20,00	69	63	E/E	1 x 125	1 x 125	1037
	E221	1082	137	402,2	335,9	135.770	103.540	76,6	64,0	206	150	2	16,50	31,00	11,50	20,00	69	63	E/E	1 x 125	1 x 125	1114
	E231	1218	150	437,5	364,9	142.750	109.150	83,3	69,5	266	193	2	16,50	31,00	11,50	20,00	69	63	E/E	1 x 125	1 x 125	1190
	E241	1353	153	467,9	390,7	147.870	113.640	89,1	74,4	326	240	2	16,50									

FD H/V 2E • Ø910 mm

Hatve / Fin Pitch: 2,1 mm

MODEL MODEL	Yüzey Surface	Boru Hacmi Tube Volume	Kapasite Capacity (Ethylen Glycol % 34 40/35°C 25°C)		Hava Debisi Air Flow		Glikol/Su Glycol/Water				Geçiş Sayısı No. of Pass	Motor Motor				Ses Seviyesi Noise Level		Enerji Verimliliği Sınıfı Energy Efficiency Class	Bağlantılar Connections		Ağırlık Weight	
			S		S		Debi Flow		Basınç Kaybı Pressure Drop			3/400V 50 Hz				3/400V 50 Hz			S			
			900 rpm	700 rpm	900 rpm	700 rpm	900 rpm	700 rpm	900 rpm	700 rpm		Toplam Güç / Total Power Toplam Akım / Total Current		S		S			S			
			Δ	Y	Δ	Y	Δ	Y	Δ	Y		Δ	Y	Δ	Y	Δ	Y		Δ	Y		Δ
m <sup>2</sup>	dm <sup>2</sup>	kW		m <sup>3</sup> /h		m <sup>3</sup> /h		kPa		n	kW		A		dB(A)		PN 10/ DN		kg			
9121	E111	285	44	116,9	99,8	53.200	40.520	22,3	19,0	132	99	8	6,60	12,40	4,60	8,00	65	59	E/E	1 x 65	1 x 65	417
	E121	303	48	124,9	106,9	56.360	43.220	23,8	20,3	80	60	6	6,60	12,40	4,60	8,00	65	59	E/E	1 x 65	1 x 65	438
	E131	341	58	136,9	117,1	58.780	45.240	26,1	22,3	95	77	6	6,60	12,40	4,60	8,00	65	59	E/E	1 x 80	1 x 65	470
	E211	354	60	134,6	112,7	48.910	37.150	25,6	21,5	100	77	8	6,60	12,40	4,60	8,00	65	59	E/E	1 x 80	1 x 65	454
	E221	404	65	132,7	111,2	52.640	40.070	25,3	21,2	21	20	4	6,60	12,40	4,60	8,00	65	59	E/E	1 x 80	1 x 65	479
	E231	455	70	147,4	123,9	55.430	42.540	28,1	23,6	27	26	4	6,60	12,40	4,60	8,00	65	59	E/E	1 x 80	1 x 65	504
	E241	505	75	160,9	134,7	57.850	44.340	30,6	25,7	34	25	4	6,60	12,40	4,60	8,00	65	59	E/E	1 x 80	1 x 80	529
	E251	556	80	172,9	144,7	59.710	45.910	32,9	27,5	41	30	4	6,60	12,40	4,60	8,00	65	59	E/E	1 x 80	1 x 80	554
	E331	682	108	180,2	145,9	49.840	37.830	34,3	27,8	46	36	6	6,60	12,40	4,60	8,00	65	59	E/E	1 x 100	1 x 80	591
	E341	758	115	195,2	157,3	52.640	39.850	37,2	30,0	57	45	6	6,60	12,40	4,60	8,00	65	59	E/E	1 x 100	1 x 80	623
9122	E351	833	123	208,7	167,7	55.060	41.640	39,7	31,9	69	53	6	6,60	12,40	4,60	8,00	65	59	E/E	1 x 100	1 x 80	655
	E111	530	91	233,2	199,2	106.390	81.040	44,4	37,9	114	86	4	13,20	24,80	9,20	16,00	68	62	E/E	1 x 100	1 x 100	722
	E121	606	99	227,8	195,0	112.720	86.430	43,4	37,1	24	18	2	13,20	24,80	9,20	16,00	68	62	E/E	1 x 100	1 x 100	766
	E131	682	106	253,4	216,4	117.930	90.470	48,3	41,2	31	23	2	13,20	24,80	9,20	16,00	68	62	E/E	1 x 100	1 x 100	809
	E211	707	109	268,6	224,9	97.820	74.300	51,2	42,8	91	66	4	13,20	24,80	9,20	16,00	68	62	E/E	1 x 100	1 x 100	774
	E221	808	138	300,6	251,3	105.270	80.140	57,2	47,9	118	90	4	13,20	24,80	9,20	16,00	68	62	E/E	1 x 125	1 x 100	841
	E231	909	129	293,7	247,0	110.850	85.080	55,9	47,0	29	21	2	13,20	24,80	9,20	16,00	68	62	E/E	1 x 100	1 x 100	874
	E241	1010	158	321,0	268,8	115.690	88.670	61,1	51,2	28	26	2	13,20	24,80	9,20	16,00	68	62	E/E	1 x 125	1 x 100	947
	E251	1111	168	345,0	288,7	119.420	91.810	65,7	55,0	35	31	2	13,20	24,80	9,20	16,00	68	62	E/E	1 x 125	1 x 100	1022
	E331	1364	194	371,5	300,4	99.680	75.650	70,7	57,2	96	66	4	13,20	24,80	9,20	16,00	68	62	E/E	1 x 125	1 x 125	1020
9123	E341	1515	209	400,9	322,6	105.270	79.690	76,3	61,4	120	81	4	13,20	24,80	9,20	16,00	68	62	E/E	1 x 125	1 x 125	1089
	E351	1667	224	427,5	342,9	110.110	83.280	81,4	65,3	146	98	4	13,20	24,80	9,20	16,00	68	62	E/E	1 x 125	1 x 125	1179
	E111	796	136	332,7	284,1	159.580	121.550	63,4	54,1	48	42	2	19,80	37,20	13,80	24,00	70	64	E/E	1 x 125	1 x 100	1044
	E121	909	148	373,3	319,4	169.070	129.640	71,1	60,8	66	50	2	19,80	37,20	13,80	24,00	70	64	E/E	1 x 125	1 x 125	1109
	E131	1023	159	409,6	350,3	135.700	78,0	66,7	85	65	2	19,80	37,20	13,80	24,00	70	64	E/E	1 x 125	1 x 125	1173	
	E211	1061	163	383,6	321,7	146.730	111.450	73,0	61,3	40	29	2	19,80	37,20	13,80	24,00	70	64	E/E	1 x 125	1 x 125	1121
	E221	1212	178	432,5	362,1	157.900	120.210	82,4	68,9	56	40	2	19,80	37,20	13,80	24,00	70	64	E/E	1 x 125	1 x 125	1196
	E231	1364	174	475,0	398,7	166.280	127.620	90,5	75,9	67	52	2	19,80	37,20	13,80	24,00	70	64	E/E	2 x 100	1 x 125	1255
	E241	1515	188	514,0	429,8	173.540	133.000	97,9	81,8	84	65	2	19,80	37,20	13,80	24,00	70	64	E/E	2 x 100	1 x 125	1335
	E251	1667	202	548,7	458,5	179.120	137.720	104,5	87,3	105	76	2	19,80	37,20	13,80	24,00	70	64	E/E	2 x 100	2 x 100	1448
9124	E331	2046	242	539,3	436,7	149.520	113.470	102,7	83,2	46	36	2	19,80	37,20	13,80	24,00	70	64	E/E	2 x 100	1 x 125	1449
	E341	2273	264	584,3	471,0	157.900	119.530	111,3	89,7	57	39	2	19,80	37,20	13,80	24,00	70	64	E/E	2 x 100	2 x 100	1549
	E351	2500	303	625,3	502,4	165.160	124.920	119,1	95,7	64	48	2	19,80	37,20	13,80	24,00	70	64	E/E	2 x 125	2 x 100	1706
	E111	1061	143	465,8	397,8	212.770	162.070	88,7	75,7	106	84	2	26,40	49,60	18,40	32,00	71	65	E/E	2 x 100	1 x 125	1301
	E121	1212	157	519,4	444,0	225.430	172.850	98,9	84,5	148	116	2	26,40	49,60	18,40	32,00	71	65	E/E	2 x 100	1 x 125	1399
	E131	1364	171	566,9	484,5	235.110	180.930	107,9	92,3	192	145	2	26,40	49,60	18,40	32,00	71	65	E/E	2 x 100	2 x 100	1486
	E211	1414	178	536,5	449,2	195.640	148.600	102,2	85,5	86	67	2	26,40	49,60	18,40	32,00	71	65	E/E	2 x 100	1 x 125	1403
	E221	1616	216	600,8	502,4	210.530	160.270	114,4	95,7	113	87	2	26,40	49,60	18,40	32,00	71	65	E/E	2 x 125	2 x 100	1534
	E231	1818	235	656,4	550,3	221.700	170.150	125,0	104,8	147	113	2	26,40	49,60	18,40	32,00	71	65	E/E	2 x 125	2 x 100	1635
	E241	2020	255	707,5	590,8	231.380	177.340	134,7	112,5	185	141	2	26,40	49,60	18,40	32,00	71	65	E/E	2 x 125	2 x 100	1772
9125	E251	2222	275	752,3	628,4	238.830	183.620	143,3	119,7	225	164	2	26,40	49,60	18,40	32,00	71	65	E/E	2 x 125	2 x 125	1874
	E331	2727	325	742,7	600,5	199.360	151.290	141,4	114,3	93	64	2	26,40	49,60	18,40	32,00	71	65	E/E	2 x 125	2 x 125	1900
	E341	3030	354	801,6	645,1	210.530	159.370	152,6	122,8	117	80	2	26,40	49,60	18,40	32,00	71	65	E/E	2 x 125	2 x 125	2065
	E351	3334	384	854,7	685,6	220.210	166.560	162,8	130,6	143	97	2	26,40	49,60	18,40	32,00	71	65	E/E	2 x 125	2 x 125	2194
	E111	1326	187	599,5	511,7	265.960	202.590	114,2	97,4	200	156	2	33,00	62,00	23,00	40,00	72	66	E/E	2 x 125	2 x 100	1632
	E121	1515	205	665,2	566,6	281.780	214.930	126,7	107,9	272	210	2	33,00	62,00	23,00	40,00	72	66	E/E	2 x 125	2 x 100	1742
	E131	1705	224	724,5	618,7	293.880	226.160	138,0	117,8	352	266	2	33,00	62,00	23,00	40,00	72	66	E/E	2 x 125	2 x 125	1852
	E211	1768	231	689,7	577,0	244.550	185.750	131,3	109,9	157	120	2	33,00	62,00	23,00	40,00	72	66	E/E	2 x 125	2 x 100	1763
	E221	2020	255	769,1	642,5	263.160	200.340	146,5	122,3	214	156	2	33,00	62,00	23,00	40,00	72	66	E/E	2 x 125	2 x 125	1890
	E231	2273	280	837,8	699,2	277.130	211.570	159,5	133,1	278	202	2	33,00	62,00	23,00	40,00						



FD H/V 2E • Ø910 mm

Hatve / Fin Pitch: 2,1 mm

MODEL MODEL	Yüzey Surface	Boru Hacmi Tube Volume	Kapasite Capacity (Ethylen Glycol % 34 40/35°C 25°C)		Hava Debisi Air Flow		Glikol/Su Glycol/Water				Geçiş Sayısı No. of Pass	Motor Motor				Ses Seviyesi Noise Level		Enerji Verimliliği Sınıfı Energy Efficiency Class	Bağlantılar Connections		Ağırlık Weight	
			S		S		Debi Flow		Basınç Kaybı Pressure Drop			3/400V 50 Hz				3/400V 50 Hz			3/400V 50 Hz			Giriş / Çıkış Inlet / Outlet
			900 rpm	700 rpm	900 rpm	700 rpm	900 rpm	700 rpm	900 rpm	700 rpm		Toplam Güç / Total Power Toplam Akım / Total Current		S		S	S		S	S		
			Δ	Y	Δ	Y	Δ	Y	Δ	Y		Δ	Y	Δ	Y	Δ	Y		Δ	Y		Δ
m <sup>2</sup>	dm <sup>3</sup>	kW		m <sup>3</sup> /h		m <sup>3</sup> /h		kPa		n	kW		A		dB(A)		PN 10/ DN		kg			
9121	E112	284	47	116,8	99,8	54.870	41.870	22,2	19,0	58	44	6	6,60	12,40	4,60	8,00	65	59	E/E	1 x 80	1 x 65	432
	E122	325	58	130,5	111,5	57.850	44.340	24,9	21,2	71	59	6	6,60	12,40	4,60	8,00	65	59	E/E	1 x 80	1 x 65	466
	E132	365	62	142,9	122,0	60.270	46.360	27,2	23,2	92	75	6	6,60	12,40	4,60	8,00	65	59	E/E	1 x 80	1 x 65	489
	E212	379	64	141,4	118,5	50.770	38.720	26,9	22,6	98	76	8	6,60	12,40	4,60	8,00	65	59	E/E	1 x 80	1 x 65	472
	E222	433	69	138,8	116,3	54.310	41.420	26,4	22,1	21	21	4	6,60	12,40	4,60	8,00	65	59	E/E	1 x 80	1 x 65	498
	E232	487	75	154,0	128,9	57.100	43.660	29,3	24,5	27	20	4	6,60	12,40	4,60	8,00	65	59	E/E	1 x 80	1 x 80	525
	E242	541	80	167,6	140,0	59.340	45.460	31,9	26,7	34	24	4	6,60	12,40	4,60	8,00	65	59	E/E	1 x 80	1 x 80	551
	E252	595	101	179,5	149,7	61.010	46.810	34,2	28,5	33	29	4	6,60	12,40	4,60	8,00	65	59	E/E	1 x 100	1 x 80	600
	E332	731	116	188,5	152,2	51.710	39.170	35,9	29,0	44	36	6	6,60	12,40	4,60	8,00	65	59	E/E	1 x 100	1 x 80	619
	E342	812	123	203,2	163,8	54.310	41.190	38,7	31,2	55	44	6	6,60	12,40	4,60	8,00	65	59	E/E	1 x 100	1 x 80	652
E352	893	131	216,5	173,6	56.950	42.770	41,2	33,1	66	52	6	6,60	12,40	4,60	8,00	65	59	E/D	1 x 100	1 x 80	686	
9122	E112	568	98	244,6	208,7	109.740	83.730	46,6	39,7	110	83	4	13,20	24,80	9,20	16,00	68	62	E/E	1 x 100	1 x 100	749
	E122	649	106	238,2	203,5	115.690	88.670	45,4	38,8	23	18	2	13,20	24,80	9,20	16,00	68	62	E/E	1 x 100	1 x 100	795
	E132	731	114	264,2	225,7	120.530	92.710	50,3	43,0	31	23	2	13,20	24,80	9,20	16,00	68	62	E/E	1 x 100	1 x 100	841
	E212	758	117	282,1	236,6	101.540	77.440	53,7	45,1	90	65	4	13,20	24,80	9,20	16,00	68	62	E/E	1 x 100	1 x 100	804
	E222	866	148	314,4	262,8	108.620	82.830	59,9	50,0	113	87	4	13,20	24,80	9,20	16,00	68	62	E/E	1 x 125	1 x 100	875
	E232	974	159	307,1	257,0	114.200	87.320	58,5	48,9	22	21	2	13,20	24,80	9,20	16,00	68	62	E/E	1 x 125	1 x 100	929
	E242	1082	169	334,3	279,4	118.670	90.920	63,7	53,2	28	26	2	13,20	24,80	9,20	16,00	68	62	E/E	1 x 125	1 x 100	987
	E252	1191	180	358,2	298,8	122.020	93.610	68,2	56,9	34	24	2	13,20	24,80	9,20	16,00	68	62	E/E	1 x 125	1 x 125	1066
	E332	1461	208	388,5	313,2	103.410	78.340	74,0	59,6	93	63	4	13,20	24,80	9,20	16,00	68	62	E/E	1 x 125	1 x 125	1067
	E342	1623	224	417,4	335,9	108.620	82.380	79,5	64,0	115	78	4	13,20	24,80	9,20	16,00	68	62	E/E	1 x 125	1 x 125	1140
E352	1786	240	443,3	354,9	113.090	85.530	84,4	67,6	139	94	4	13,20	24,80	9,20	16,00	68	62	E/D	1 x 125	1 x 125	1234	
9123	E112	852	146	348,9	298,0	164.600	125.590	66,4	56,7	47	35	2	19,80	37,20	13,80	24,00	70	64	E/E	1 x 125	1 x 125	1084
	E122	974	158	390,2	333,4	173.540	133.000	74,3	63,5	64	48	2	19,80	37,20	13,80	24,00	70	64	E/E	1 x 125	1 x 125	1150
	E132	1096	170	427,6	365,0	180.800	139.070	81,4	69,5	83	62	2	19,80	37,20	13,80	24,00	70	64	E/E	1 x 125	1 x 125	1219
	E212	1136	175	403,8	338,4	152.870	116.160	76,9	64,4	40	29	2	19,80	37,20	13,80	24,00	70	64	E/E	1 x 125	1 x 125	1164
	E222	1299	170	452,5	378,7	162.930	124.250	86,2	72,1	50	40	2	19,80	37,20	13,80	24,00	70	64	E/E	2 x 100	1 x 125	1226
	E232	1461	186	496,2	414,8	171.300	130.980	94,5	79,0	65	51	2	19,80	37,20	13,80	24,00	70	64	E/E	2 x 100	1 x 125	1306
	E242	1623	202	535,2	446,6	178.010	136.370	101,9	85,0	81	63	2	19,80	37,20	13,80	24,00	70	64	E/E	2 x 100	1 x 125	1391
	E252	1786	216	569,6	474,6	183.030	140.410	108,5	90,4	100	72	2	19,80	37,20	13,80	24,00	70	64	E/E	2 x 100	2 x 100	1509
	E332	2192	259	648,6	520,2	169.630	128.290	123,5	99,1	61	46	2	19,80	37,20	13,80	24,00	70	64	E/D	2 x 125	2 x 100	1786
	E342	2435	303	608,5	490,5	162.930	123.570	115,9	93,4	49	38	2	19,80	37,20	13,80	24,00	70	64	E/E	2 x 125	2 x 100	1638
9124	E112	1136	153	488,4	417,0	219.470	167.460	93,0	79,4	103	82	2	26,40	49,60	18,40	32,00	71	65	E/E	2 x 100	1 x 125	1348
	E122	1299	168	542,5	463,2	231.380	177.340	103,3	88,2	143	108	2	26,40	49,60	18,40	32,00	71	65	E/E	2 x 100	2 x 100	1451
	E132	1461	184	592,0	505,0	241.060	185.420	112,7	96,2	185	139	2	26,40	49,60	18,40	32,00	71	65	E/E	2 x 100	2 x 100	1543
	E212	1515	191	563,5	472,5	203.080	154.880	107,3	90,0	84	61	2	26,40	49,60	18,40	32,00	71	65	E/E	2 x 100	2 x 100	1457
	E222	1732	231	628,4	525,3	217.230	165.660	119,7	100,0	109	85	2	26,40	49,60	18,40	32,00	71	65	E/E	2 x 125	2 x 100	1596
	E232	1948	252	685,6	572,4	228.400	174.640	130,6	109,0	142	109	2	26,40	49,60	18,40	32,00	71	65	E/E	2 x 125	2 x 100	1703
	E242	2165	273	734,9	614,2	236.600	181.830	139,9	117,0	176	128	2	26,40	49,60	18,40	32,00	71	65	E/E	2 x 125	2 x 125	1846
	E252	2381	294	780,8	650,0	244.040	187.220	148,7	123,8	214	154	2	26,40	49,60	18,40	32,00	71	65	E/E	2 x 125	2 x 125	1953
	E332	2922	348	776,7	626,3	206.810	156.680	147,9	119,3	91	62	2	26,40	49,60	18,40	32,00	71	65	E/E	2 x 125	2 x 125	1987
	E342	3247	380	834,5	671,6	217.230	164.760	158,9	127,9	113	77	2	26,40	49,60	18,40	32,00	71	65	E/E	2 x 125	2 x 125	2159
9125	E112	1421	200	628,6	536,3	274.330	209.320	119,7	102,1	193	151	2	33,00	62,00	23,00	40,00	72	66	E/E	2 x 125	2 x 100	1690
	E122	1623	220	695,5	593,4	289.230	221.670	132,4	113,0	261	197	2	33,00	62,00	23,00	40,00	72	66	E/E	2 x 125	2 x 125	1806
	E132	1826	240	756,4	644,8	301.330	231.770	144,0	122,8	337	254	2	33,00	62,00	23,00	40,00	72	66	E/E	2 x 125	2 x 125	1922
	E212	1894	247	724,4	606,9	253.850	193.600	137,9	115,6	152	111	2	33,00	62,00	23,00	40,00	72	66	E/E	2 x 125	2 x 125	1830
	E222	2165	273	804,3	671,8	271.540	207.080	153,2	127,9	207	150	2	33,00	62,00	23,00	40,00	72	66	E/E	2 x 125	2 x 125	1965
	E232	2435	300	875,0	729,9	285.500	218.300	166,6	139,0	267	194	2	33,00	62,00	23,00	40,00	72	66	E/E	2 x 125	2 x 125	2099
	E242	2706	326	935,8	781,5	295.740	227.280	178,2	148,8	324	241	2	33,00	62,00	23,00	40,00	72	66	E/E	3 x 125	2 x 125	2246
	E252	2976	352	992,3	825,5	305.050	234.020	189,0	157,2													

**FDH 2E 1 Sıra Fanlı / 1 Row Fans**

**TEKNİK ÇİZİM • DRAWING**

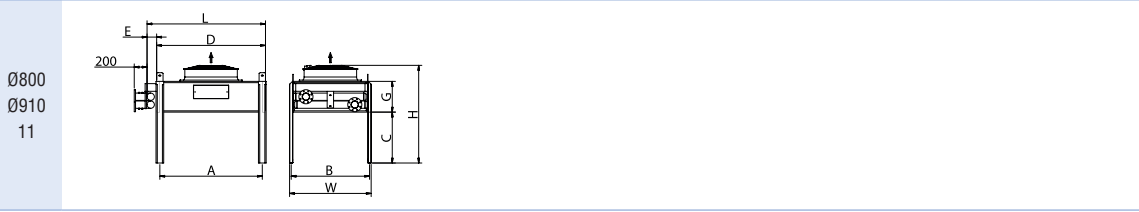

Montaj ayağı detayı  
Mounting leg detail

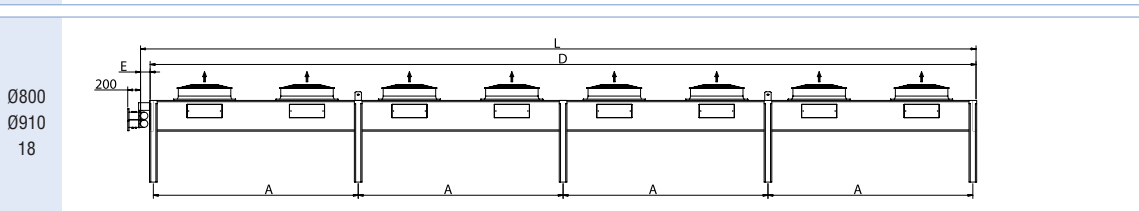
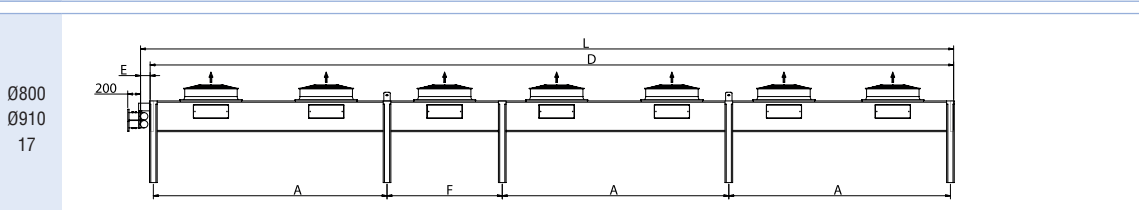
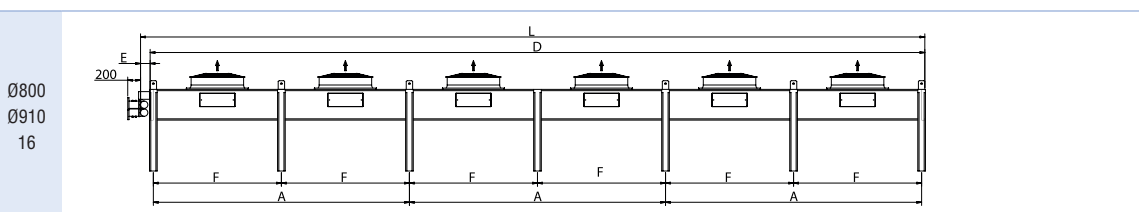
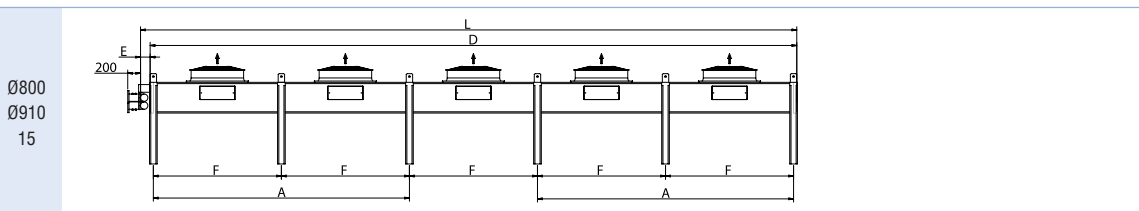
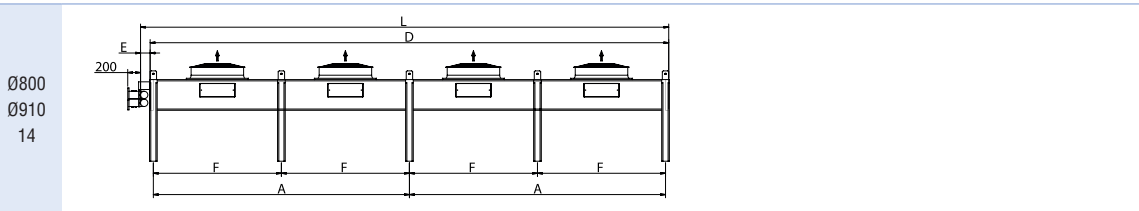
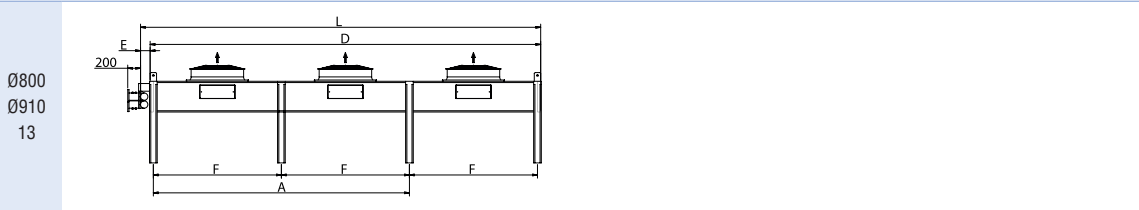
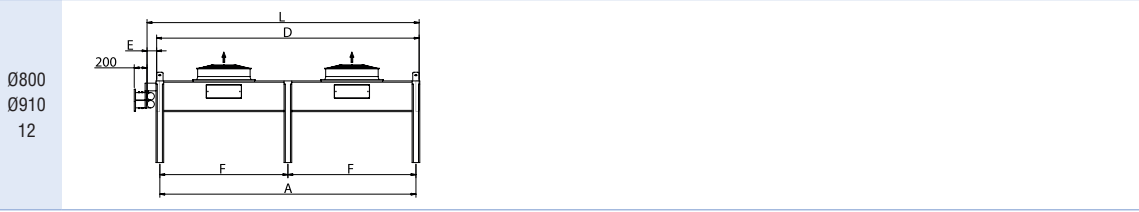
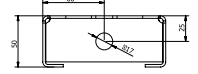

\* Aynı fan sayısında farklı L değerleri için ayak sayıları değişken olabilmektedir. Gerçek ölçü detayları için ÜSP 6.0'a bakınız.  
 \* Number of mounting legs can be variable for different L dimensions at the same fan number. For detailed dimensions please use PSS 6.0.

**FDH 2E 2 Sıra Fanlı / 2 Row Fans**

**TEKNİK ÇİZİM • DRAWING**

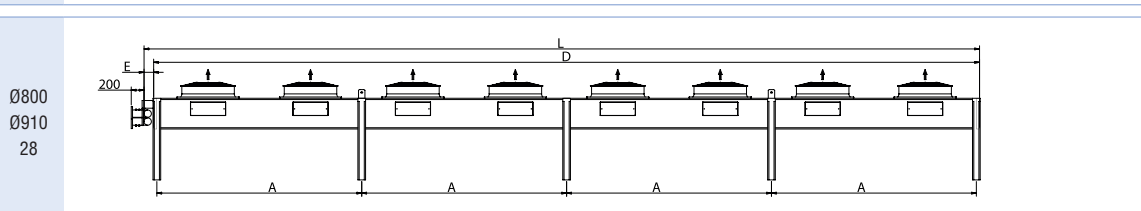
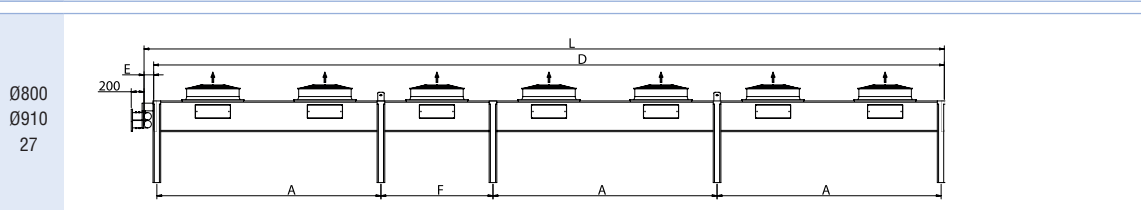
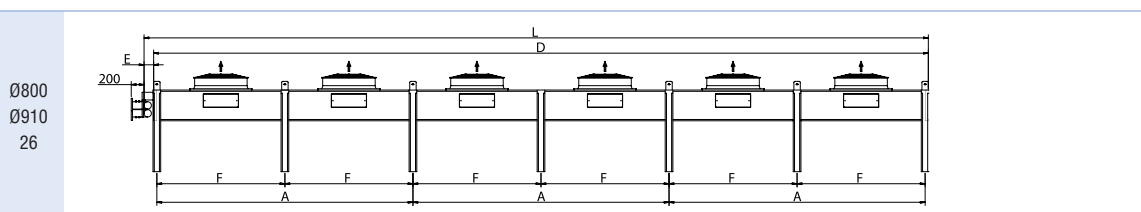
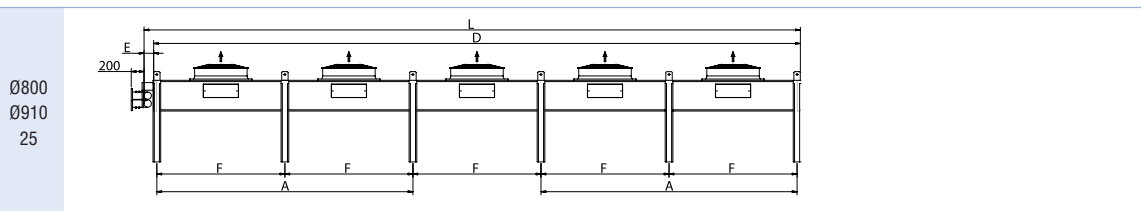
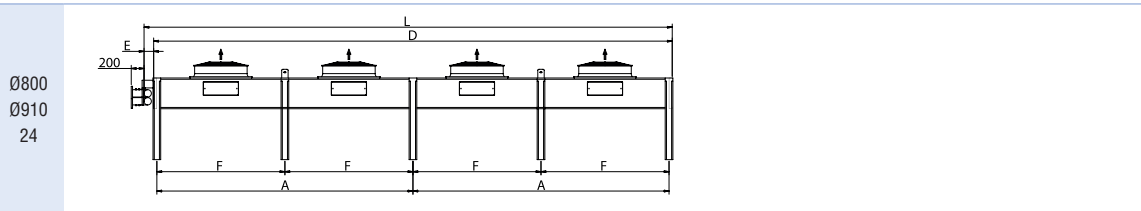
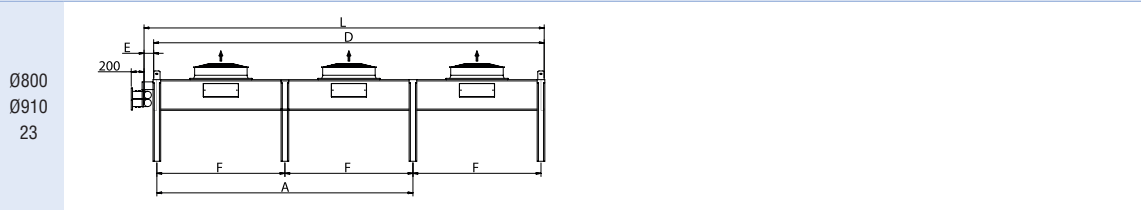
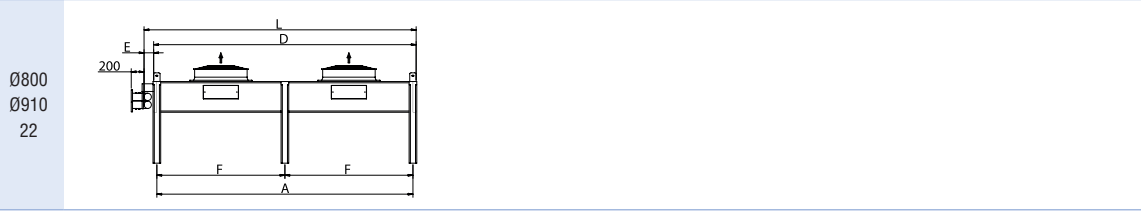
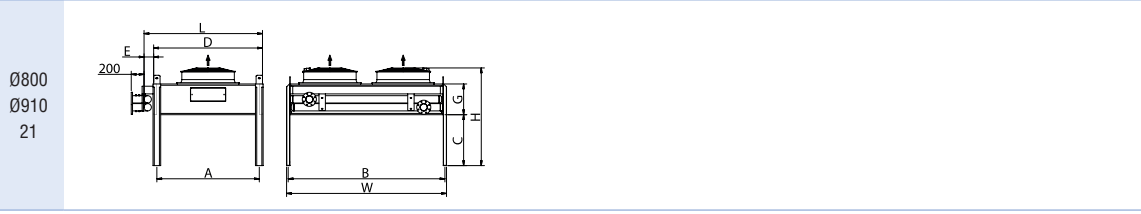

\* Aynı fan sayısında farklı L değerleri için ayak sayıları değişken olabilmektedir. Gerçek ölçü detayları için ÜSP 6.0'a bakınız.  
 \* Number of mounting legs can be variable for different L dimensions at the same fan number. For detailed dimensions please use PSS 6.0.

**FDV 2E 1 Sıra Fanlı / 1 Row Fans**

**TEKNİK ÇİZİM • DRAWING**

Ø800  
 Ø910  
 11

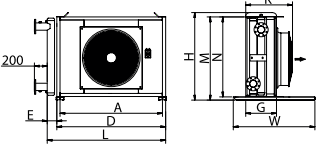

Ø800  
 Ø910  
 12

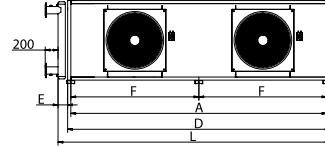

Ø800  
 Ø910  
 13

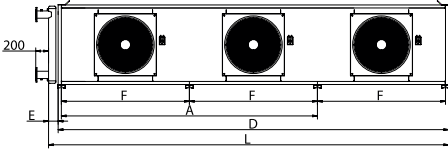

Ø800  
 Ø910  
 14

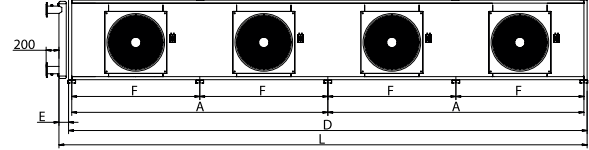

Ø800  
 Ø910  
 15

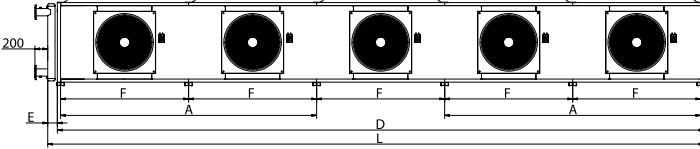

Ø800  
 Ø910  
 16

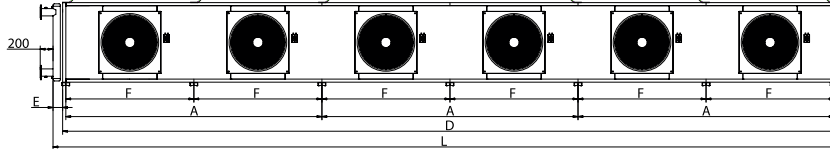

Ø800  
 Ø910  
 17

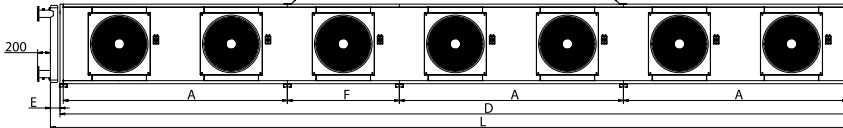

Ø800  
 Ø910  
 18

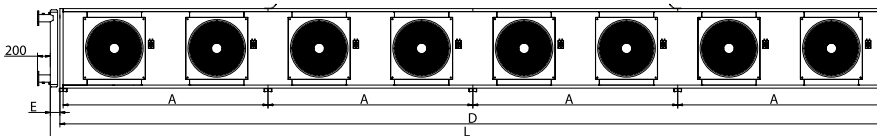

\* Aynı fan sayısında farklı L değerleri için ayak sayıları değişken olabilmektedir. Gerçek ölçü detayları için ÜSP 6.0'a bakınız.  
 \* Number of mounting legs can be variable for different L dimensions at the same fan number. For detailed dimensions please use PSS 6.0.

**FDV 2E 2 Sıra Fanlı / 2 Row Fans**

**TEKNİK ÇİZİM • DRAWING**

Ø800  
 Ø910  
 21

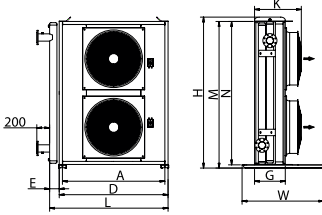

Ø800  
 Ø910  
 22

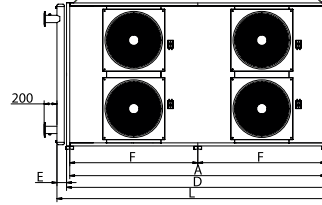

Ø800  
 Ø910  
 23

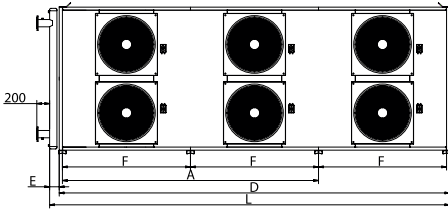

Ø800  
 Ø910  
 24

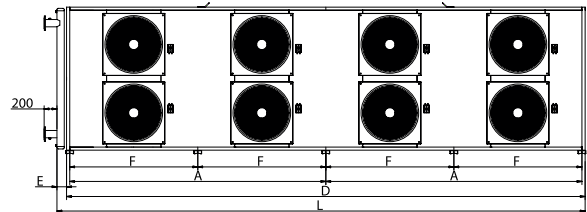

Ø800  
 Ø910  
 25

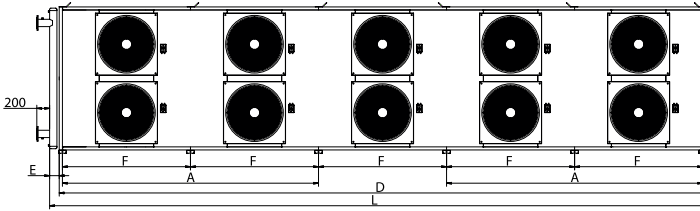

Ø800  
 Ø910  
 26

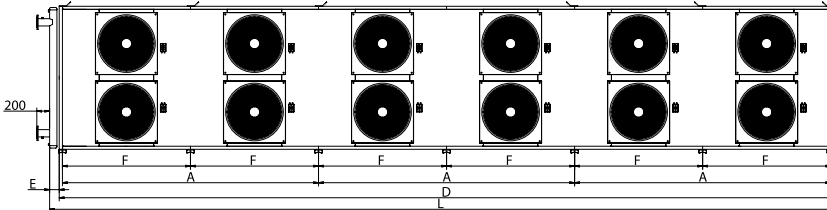

Ø800  
 Ø910  
 27

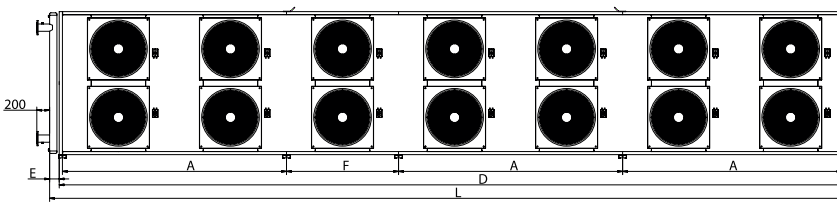

Ø800  
 Ø910  
 28

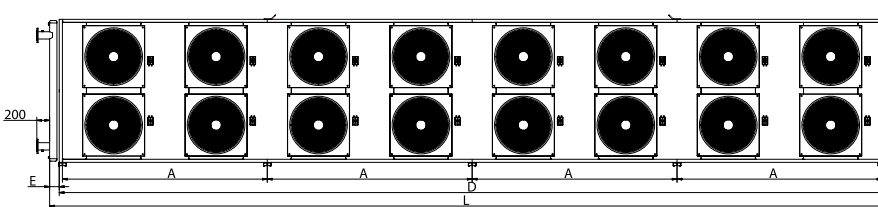

\* Aynı fan sayısında farklı L değerleri için ayak sayıları değişken olabilmektedir. Gerçek ölçü detayları için ÜSP 6.0'a bakınız.  
 \* Number of mounting legs can be variable for different L dimensions at the same fan number. For detailed dimensions please use PSS 6.0.



**FDH/FDV 2E**

**BOYUTLAR • DIMENSIONS**

MODEL MODEL	D mm	A mm	F mm	B mm	W		M mm	N mm	H		L mm	AYAK SAYILARI	
					FDH	FDV			FDV	YATIK		DİK	
					mm	mm							
80/91 11	E111	1500	1400	-	2300	2350	1275	1305	1255	1375	1595	4	2
	E211	1500	1400	-	2300	2350	1275	1305	1255	1375	1610	4	2
	E121	1700	1600	-	2300	2350	1275	1305	1255	1375	1810	4	2
	E221	1700	1600	-	2300	2350	1275	1305	1255	1375	1810	4	2
	E131	1900	1800	-	2300	2350	1275	1305	1255	1375	2010	4	2
	E231	1900	1800	-	2300	2350	1275	1305	1255	1375	2010	4	2
	E331	1900	1800	-	2300	2350	1275	1305	1255	1375	2010	4	2
	E241	2100	2000	-	2300	2350	1275	1305	1255	1375	2210	4	2
	E341	2100	2000	-	2300	2350	1275	1305	1255	1375	2210	4	2
	E251	2300	2200	-	2300	2350	1275	1305	1255	1375	2410	4	2
E351	2300	2200	-	2300	2350	1275	1305	1255	1375	2410	4	2	
80/91 12	E111	2900	2800	-	2300	2350	1275	1305	1255	1375	3010	4	2
	E211	2900	2800	-	2300	2350	1275	1305	1255	1375	3010	4	2
	E121	3300	3200	-	2300	2350	1275	1305	1255	1375	3425	4	2
	E221	3300	3200	-	2300	2350	1275	1305	1255	1375	3425	4	2
	E131	3700	3600	-	2300	2350	1275	1305	1255	1375	3825	4	2
	E231	3700	3600	-	2300	2350	1275	1305	1255	1375	3825	4	2
	E331	3700	3600	-	2300	2350	1275	1305	1255	1375	3825	4	2
	E241	4100	-	2000	2300	2350	1275	1305	1255	1375	4225	6	3
	E341	4100	-	2000	2300	2350	1275	1305	1255	1375	4250	6	3
	E251	4500	-	2200	2300	2350	1275	1305	1255	1375	4650	6	3
E351	4500	-	2200	2300	2350	1275	1305	1255	1375	4650	6	3	
80/91 13	E111	4300	2800	1400	2300	2350	1275	1305	1255	1375	4425	6	3
	E211	4300	2800	1400	2300	2350	1275	1305	1255	1375	4450	6	3
	E121	4900	3200	1600	2300	2350	1275	1305	1255	1375	5050	6	3
	E221	4900	3200	1600	2300	2350	1275	1305	1255	1375	5050	6	3
	E131	5500	3600	1800	2300	2350	1275	1305	1255	1375	5650	6	3
	E231	5500	3600	1800	2300	2350	1275	1305	1255	1375	5650	6	3
	E331	5500	3600	1800	2300	2350	1275	1305	1255	1375	5650	6	3
	E241	6100	-	2000	2300	2350	1275	1305	1255	1375	6250	8	4
	E341	6100	-	2000	2300	2350	1275	1305	1255	1375	6250	8	4
	E251	6700	-	2200	2300	2350	1275	1305	1255	1375	6900	8	4
E351	6700	-	2200	2300	2350	1275	1305	1255	1375	6900	8	4	
80/91 14	E111	5700	2800	-	2300	2350	1275	1305	1255	1375	5850	6	3
	E211	5700	2800	-	2300	2350	1275	1305	1255	1375	5850	6	3
	E121	6500	3200	-	2300	2350	1275	1305	1255	1375	6650	6	3
	E221	6500	3200	-	2300	2350	1275	1305	1255	1375	6650	6	3
	E131	7300	3600	-	2300	2350	1275	1305	1255	1375	7500	6	3
	E231	7300	3600	-	2300	2350	1275	1305	1255	1375	7500	6	3
	E331	7300	3600	-	2300	2350	1275	1305	1255	1375	7500	6	3
	E241	8100	-	2000	2300	2350	1275	1305	1255	1375	8300	10	5
	E341	8100	-	2000	2300	2350	1275	1305	1255	1375	8300	10	5
	E251	8900	-	2200	2300	2350	1275	1305	1255	1375	9100	10	5
E351	8900	-	2200	2300	2350	1275	1305	1255	1375	9100	10	5	
80/91 15	E111	7100	2800	1400	2300	2350	1275	1305	1255	1375	7300	8	4
	E211	7100	2800	1400	2300	2350	1275	1305	1255	1375	7300	8	4
	E121	8100	3200	1600	2300	2350	1275	1305	1255	1375	8300	8	4
	E221	8100	3200	1600	2300	2350	1275	1305	1255	1375	8300	8	4
	E131	9100	3600	1800	2300	2350	1275	1305	1255	1375	9300	8	4
	E231	9100	3600	1800	2300	2350	1275	1305	1255	1375	9300	8	4
	E331	9100	3600	1800	2300	2350	1275	1305	1255	1375	9300	8	4
	E241	10100	-	2000	2300	2350	1275	1305	1255	1375	10300	12	6
	E341	10100	-	2200	2300	2350	1275	1305	1255	1375	10300	12	6
	E251	11100	-	2200	2300	2350	1275	1305	1255	1375	11300	12	6
E351	11100	-	2200	2300	2350	1275	1305	1255	1375	11300	12	6	

**FDH/FDV 2E**

**BOYUTLAR • DIMENSIONS**

MODEL MODEL	D	A	F	B	W	W	M	N	H	L	AYAK SAYILARI		
					FDH	FDV			FDV		YATIK	DİK	
					mm	mm			mm				mm
80/91 16	E111	8500	2800	-	2300	2350	1275	1305	1255	1375	8700	8	4
	E211	8500	2800	-	2300	2350	1275	1305	1255	1375	8700	8	4
	E121	9700	3200	-	2300	2350	1275	1305	1255	1375	9900	8	4
	E221	9700	3200	-	2300	2350	1275	1305	1255	1375	9900	8	4
	E131	10900	3600	-	2300	2350	1275	1305	1255	1375	11100	8	4
	E231	10900	3600	-	2300	2350	1275	1305	1255	1375	11100	8	4
	E331	10900	3600	-	2300	2350	1275	1305	1255	1375	11100	8	4
	E241	12100	-	2000	2300	2350	1275	1305	1255	1375	12300	14	7
E341	12100	-	2000	2300	2350	1275	1305	1255	1375	12300	14	7	
80/91 17	E111	9900	2800	1400	2300	2350	1275	1305	1255	1375	10100	10	5
	E211	9900	2800	1400	2300	2350	1275	1305	1255	1375	10100	10	5
	E121	11300	3200	1600	2300	2350	1275	1305	1255	1375	11500	10	5
	E221	11300	3200	1600	2300	2350	1275	1305	1255	1375	11500	10	5
	E131	12700	3600	1800	2300	2350	1275	1305	1255	1375	12900	10	5
	E231	12700	3600	1800	2300	2350	1275	1305	1255	1375	12900	10	5
80/91 18	E111	11300	2800	-	2300	2350	1275	1305	1255	1375	11500	10	5
	E211	11300	2800	-	2300	2350	1275	1305	1255	1375	11500	10	5
	E121	12900	3200	-	2300	2350	1275	1305	1255	1375	13100	10	5
	E221	12900	3200	-	2300	2350	1275	1305	1255	1375	13100	10	5

Connection Size	E	C	G	H (FDH)		K	
	mm	mm	mm	Ø800	Ø910	Ø800	Ø910
1"	70	795	480	1540	1580	740	780
1 1/4"	80	795	480	1540	1580	740	780
1 1/2"	85	795	480	1540	1580	740	780
2"	95	795	480	1540	1580	740	780
2 1/2"	110	795	480	1540	1580	740	780
3"	125	795	480	1540	1580	740	780
4"	150	795	480	1540	1580	740	780
5"	200	895	600	1760	1800	860	900

**FDH/FDV 2E**

**BOYUTLAR • DIMENSIONS**

	MODEL MODEL	D mm	A mm	F mm	B mm	W		M mm	N mm	H		L mm	AYAK SAYILARI		MODEL MODEL	D mm	A mm	F mm	B mm	W		M mm	N mm	H		L mm	AYAK SAYILARI												
						FDH	FDV			FDH	FDV		FDH	FDV						FDH	FDV			YATIK	DİK		YATIK	DİK											
						mm	mm			mm	mm		mm	mm						mm	mm			mm	mm		mm	mm	mm	mm	mm	mm	mm	mm	mm	mm	mm	mm	mm
80/91 21	E111	1500	1400	-	2300	2350	1275	2295	2245	2365	1610	4	2	E112	1500	1400	-	2450	2500	1275	2450	2400	2520	1610	4	2	E1212	1500	1400	-	2450	2500	1275	2450	2400	2520	1625	4	2
	E211	1500	1400	-	2300	2350	1275	2295	2245	2365	1610	4	2	E212	1500	1400	-	2450	2500	1275	2450	2400	2520	1625	4	2	E2212	1500	1400	-	2450	2500	1275	2450	2400	2520	1825	4	2
	E121	1700	1600	-	2300	2350	1275	2295	2245	2365	1825	4	2	E122	1700	1600	-	2450	2500	1275	2450	2400	2520	1825	4	2	E222	1700	1600	-	2450	2500	1275	2450	2400	2520	1825	4	2
	E221	1700	1600	-	2300	2350	1275	2295	2245	2365	1825	4	2	E222	1700	1600	-	2450	2500	1275	2450	2400	2520	1825	4	2	E322	1700	1600	-	2450	2500	1275	2450	2400	2520	1825	4	2
	E131	1900	1800	-	2300	2350	1275	2295	2245	2365	2025	4	2	E132	1900	1800	-	2450	2500	1275	2450	2400	2520	2025	4	2	E232	1900	1800	-	2450	2500	1275	2450	2400	2520	2025	4	2
	E231	1900	1800	-	2300	2350	1275	2295	2245	2365	2025	4	2	E232	1900	1800	-	2450	2500	1275	2450	2400	2520	2025	4	2	E332	1900	1800	-	2450	2500	1275	2450	2400	2520	2025	4	2
	E331	1900	1800	-	2300	2350	1275	2295	2245	2365	2025	4	2	E332	1900	1800	-	2450	2500	1275	2450	2400	2520	2025	4	2	E422	2100	2000	-	2300	2350	1275	2295	2245	2365	2225	4	2
	E241	2100	2000	-	2300	2350	1275	2295	2245	2365	2225	4	2	E242	2100	2000	-	2450	2500	1275	2450	2400	2520	2250	4	2	E342	2100	2000	-	2300	2350	1275	2295	2245	2365	2250	4	2
	E341	2100	2000	-	2300	2350	1275	2295	2245	2365	2250	4	2	E342	2100	2000	-	2450	2500	1275	2450	2400	2520	2250	4	2	E252	2300	2200	-	2300	2350	1275	2295	2245	2365	2450	4	2
	E251	2300	2200	-	2300	2350	1275	2295	2245	2365	2450	4	2	E252	2300	2200	-	2450	2500	1275	2450	2400	2520	2450	4	2	E352	2300	2200	-	2300	2350	1275	2295	2245	2365	2450	4	2
E351	2300	2200	-	2300	2350	1275	2295	2245	2365	2450	4	2	E352	2300	2200	-	2450	2500	1275	2450	2400	2520	2450	4	2														
80/91 22	E111	2900	2800	-	2300	2350	1275	2295	2245	2365	3050	4	2	E112	2900	2800	-	2450	2500	1275	2450	2400	2520	3050	4	2	E212	2900	2800	-	2300	2350	1275	2295	2245	2365	3050	4	2
	E211	2900	2800	-	2300	2350	1275	2295	2245	2365	3050	4	2	E212	2900	2800	-	2450	2500	1275	2450	2400	2520	3050	4	2	E222	2900	2800	-	2300	2350	1275	2295	2245	2365	3450	4	2
	E121	3300	3200	-	2300	2350	1275	2295	2245	2365	3450	4	2	E122	3300	3200	-	2450	2500	1275	2450	2400	2520	3450	4	2	E222	3300	3200	-	2300	2350	1275	2295	2245	2365	3450	4	2
	E221	3300	3200	-	2300	2350	1275	2295	2245	2365	3450	4	2	E222	3300	3200	-	2450	2500	1275	2450	2400	2520	3450	4	2	E322	3300	3200	-	2300	2350	1275	2295	2245	2365	3900	4	2
	E131	3700	3600	-	2300	2350	1275	2295	2245	2365	3900	4	2	E132	3700	3600	-	2450	2500	1275	2450	2400	2520	3900	4	2	E232	3700	3600	-	2300	2350	1275	2295	2245	2365	3850	4	2
	E231	3700	3600	-	2300	2350	1275	2295	2245	2365	3850	4	2	E232	3700	3600	-	2450	2500	1275	2450	2400	2520	3900	4	2	E332	3700	3600	-	2300	2350	1275	2295	2245	2365	3900	4	2
	E331	3700	3600	-	2300	2350	1275	2295	2245	2365	3900	4	2	E332	3700	3600	-	2450	2500	1275	2450	2400	2520	3900	4	2	E422	4100	-	2000	2300	2350	1275	2295	2245	2365	4300	6	3
	E241	4100	-	2000	2300	2350	1275	2295	2245	2365	4300	6	3	E242	4100	-	2000	2450	2500	1275	2450	2400	2520	4300	6	3	E342	4100	-	2000	2300	2350	1275	2295	2245	2365	4300	6	3
	E341	4100	-	2000	2300	2350	1275	2295	2245	2365	4300	6	3	E342	4100	-	2000	2450	2500	1275	2450	2400	2520	4300	6	3	E252	4500	-	2200	2300	2350	1275	2295	2245	2365	4700	6	3
	E251	4500	-	2200	2300	2350	1275	2295	2245	2365	4700	6	3	E252	4500	-	2200	2450	2500	1275	2450	2400	2520	4700	6	3	E352	4500	-	2200	2300	2350	1275	2295	2245	2365	4700	6	3
E351	4500	-	2200	2300	2350	1275	2295	2245	2365	4700	6	3	E352	4500	-	2200	2450	2500	1275	2450	2400	2520	4700	6	3														
80/91 23	E111	4300	2800	1400	2300	2350	1275	2295	2245	2365	4500	6	3	E112	4300	2800	1400	2450	2500	1275	2450	2400	2520	4500	6	3	E212	4300	2800	1400	2300	2350	1275	2295	2245	2365	4500	6	3
	E211	4300	2800	1400	2300	2350	1275	2295	2245	2365	4500	6	3	E212	4300	2800	1400	2450	2500	1275	2450	2400	2520	4500	6	3	E222	4300	2800	1400	2300	2350	1275	2295	2245	2365	5100	6	3
	E121	4900	3200	1600	2300	2350	1275	2295	2245	2365	5100	6	3	E122	4900	3200	1600	2450	2500	1275	2450	2400	2520	5100	6	3	E222	4900	3200	1600	2300	2350	1275	2295	2245	2365	5100	6	3
	E221	4900	3200	1600	2300	2350	1275	2295	2245	2365	5100	6	3	E222	4900	3200	1600	2450	2500	1275	2450	2400	2520	5100	6	3	E322	4900	3200	1600	2300	2350	1275	2295	2245	2365	5700	6	3
	E131	5500	3600	1800	2300	2350	1275	2295	2245	2365	5700	6	3	E132	5500	3600	1800	2450	2500	1275	2450	2400	2520	5700	6	3	E232	5500	3600	1800	2300	2350	1275	2295	2245	2365	5700	6	3
	E231	5500	3600	1800	2300	2350	1275	2295	2245	2365	5700	6	3	E232	5500	3600	1800	2450	2500	1275	2450	2400	2520	5700	6	3	E332	5500	3600	1800	2300	2350	1275	2295	2245	2365	5700	6	3
	E331	5500	3600	1800	2300	2350	1275	2295	2245	2365	5700	6	3	E332	5500	3600	1800	2450	2500	1275	2450	2400	2520	5700	6	3	E422	6100	-	2000	2300	2350	1275	2295	2245	2365	6300	8	4
	E241	6100	-	2000	2300	2350	1275	2295	2245	2365	6300	8	4	E242	6100	-	2000	2450	2500	1275	2450	2400	2520	6300	8	4	E342	6100	-	2000	2300	2350	1275	2295	2245	2365	6300	8	4
	E341	6100	-	2000	2300	2350	1275	2295	2245	2365	6300	8	4	E342	6100	-	2000	2450	2500	1275	2450	2400	2520	6300	8	4	E252	6700	-	2200	2300	2350	1275	2295	2245	2365	6900	8	4
	E251	6700	-	2200	2300	2350	1275	2295	2245	2365	6900	8	4	E252	6700	-	2200	2450	2500	1275	2450	2400	2520	6900	8														

**FDH/FDV 2E**

**BOYUTLAR • DIMENSIONS**

	MODEL MODEL	D mm	A mm	F mm	B mm	W		M mm	N mm	H		AYAK SAYILARI		MODEL MODEL	D mm	A mm	F mm	B mm	W		M mm	N mm	H		AYAK SAYILARI			
						FDH	FDV			FDV	L	FDH	FDV						L	YATIK			DİK	FDH	FDV	L	YATIK	DİK
						mm	mm			mm	mm	mm	mm						mm	mm			mm	mm	mm	mm	mm	mm
80/91 25	E111	7100	2800	1400	2300	2350	1275	2295	2245	2365	7300	8	4	E112	7100	2800	1400	2450	2500	1275	2450	2400	2520	7300	8	4		
	E211	7100	2800	1400	2300	2350	1275	2295	2245	2365	7300	8	4	E212	7100	2800	1400	2450	2500	1275	2450	2400	2520	7300	8	4		
	E121	8100	3200	1600	2300	2350	1275	2295	2245	2365	8300	8	4	E122	8100	3200	1600	2450	2500	1275	2450	2400	2520	8300	8	4		
	E221	8100	3200	1600	2300	2350	1275	2295	2245	2365	8300	8	4	E222	8100	3200	1600	2450	2500	1275	2450	2400	2520	8300	8	4		
	E131	9100	3600	1800	2300	2350	1275	2295	2245	2365	9300	8	4	E132	9100	3600	1800	2450	2500	1275	2450	2400	2520	9300	8	4		
	E231	9100	3600	1800	2300	2350	1275	2295	2245	2365	9300	8	4	E232	9100	3600	1800	2450	2500	1275	2450	2400	2520	9300	8	4		
	E331	9100	3600	1800	2300	2350	1275	2295	2245	2365	9300	8	4	E332	9100	3600	1800	2450	2500	1275	2450	2400	2520	9300	8	4		
	E241	10100	-	2000	2300	2350	1275	2295	2245	2365	10300	12	6	E242	10100	-	2000	2450	2500	1275	2450	2400	2520	10300	12	6		
	E341	10100	-	2200	2300	2350	1275	2295	2245	2365	10300	12	6	E342	10100	-	2200	2450	2500	1275	2450	2400	2520	10300	12	6		
	E251	11100	-	2200	2300	2350	1275	2295	2245	2365	11300	12	6	E252	11100	-	2200	2450	2500	1275	2450	2400	2520	11300	12	6		
E351	11100	-	2200	2300	2350	1275	2295	2245	2365	11300	12	6	E352	11100	-	2200	2450	2500	1275	2450	2400	2520	11300	12	6			
80/91 26	E111	8500	2800	-	2300	2350	1275	2295	2245	2365	8700	8	4	E112	8500	2800	-	2450	2500	1275	2450	2400	2520	8700	8	4		
	E211	8500	2800	-	2300	2350	1275	2295	2245	2365	8700	8	4	E212	8500	2800	-	2450	2500	1275	2450	2400	2520	8700	8	4		
	E121	9700	3200	-	2300	2350	1275	2295	2245	2365	9900	8	4	E122	9700	3200	-	2450	2500	1275	2450	2400	2520	9900	8	4		
	E221	9700	3200	-	2300	2350	1275	2295	2245	2365	9900	8	4	E222	9700	3200	-	2450	2500	1275	2450	2400	2520	9900	8	4		
	E131	10900	3600	-	2300	2350	1275	2295	2245	2365	11100	8	4	E132	10900	3600	-	2450	2500	1275	2450	2400	2520	11100	8	4		
	E231	10900	3600	-	2300	2350	1275	2295	2245	2365	11100	8	4	E232	10900	3600	-	2450	2500	1275	2450	2400	2520	11100	8	4		
	E331	10900	3600	-	2300	2350	1275	2295	2245	2365	11100	8	4	E332	10900	3600	-	2450	2500	1275	2450	2400	2520	11100	8	4		
	E241	12100	-	2000	2300	2350	1275	2295	2245	2365	12300	14	7	E242	12100	-	2000	2450	2500	1275	2450	2400	2520	12300	14	7		
	E341	12100	-	2000	2300	2350	1275	2295	2245	2365	12300	14	7	E342	12100	-	2000	2450	2500	1275	2450	2400	2520	12300	14	7		
	80/91 27	E111	9900	2800	1400	2300	2350	1275	2295	2245	2365	10100	10	5	E112	9900	2800	1400	2450	2500	1275	2450	2400	2520	10100	10	5	
E211		9900	2800	1400	2300	2350	1275	2295	2245	2365	10100	10	5	E212	9900	2800	1400	2450	2500	1275	2450	2400	2520	10100	10	5		
E121		11300	3200	1600	2300	2350	1275	2295	2245	2365	11500	10	5	E122	11300	3200	1600	2450	2500	1275	2450	2400	2520	11500	10	5		
E221		11300	3200	1600	2300	2350	1275	2295	2245	2365	11500	10	5	E222	11300	3200	1600	2450	2500	1275	2450	2400	2520	11500	10	5		
E131		12700	3600	1800	2300	2350	1275	2295	2245	2365	12900	10	5	E132	12700	3600	1800	2450	2500	1275	2450	2400	2520	12900	10	5		
E231		12700	3600	1800	2300	2350	1275	2295	2245	2365	12900	10	5	E232	12700	3600	1800	2450	2500	1275	2450	2400	2520	12900	10	5		
E331		12700	3600	1800	2300	2350	1275	2295	2245	2365	12900	10	5	E332	12700	3600	1800	2450	2500	1275	2450	2400	2520	12900	10	5		
80/91 28	E111	11300	2800	-	2300	2350	1275	2295	2245	2365	11500	10	5	E112	11300	2800	-	2450	2500	1275	2450	2400	2520	11500	10	5		
	E211	11300	2800	-	2300	2350	1275	2295	2245	2365	11500	10	5	E212	11300	2800	-	2450	2500	1275	2450	2400	2520	11500	10	5		
	E121	12900	3200	-	2300	2350	1275	2295	2245	2365	13100	10	5	E122	12900	3200	-	2450	2500	1275	2450	2400	2520	13100	10	5		
	E221	12900	3200	-	2300	2350	1275	2295	2245	2365	13100	10	5	E222	12900	3200	-	2450	2500	1275	2450	2400	2520	13100	10	5		

Connection Size	E	C	G	H (FDH)		K	
	mm	mm	mm	Ø800	Ø910	Ø800	Ø910
1"	70	795	480	1540	1580	740	780
1 1/4"	80	795	480	1540	1580	740	780
1 1/2"	85	795	480	1540	1580	740	780
2"	95	795	480	1540	1580	740	780
2 1/2"	110	795	480	1540	1580	740	780
3"	125	795	480	1540	1580	740	780
4"	150	795	480	1540	1580	740	780
5"	200	895	600	1760	1800	860	900



# Innovative products for a sustainable environment



CERTIFIED GEOMETRIES	ID No
M2522-3/8"	14.06.001
F3228-12mm	14.04.002
F3833-12mm	14.04.003
F3833-15mm	14.04.004
M4035-12mm	14.04.005
M4035-15mm	14.04.006

Choose Friterm **Class A**  
Products in Your Applications



NH<sub>3</sub> Unit Air Cooler  
Freon Unit Air Cooler



High efficiency heat exchanger  
for coil energy recovery loop systems



V Type Dry Cooler



Horizontal Type  
Air Cooled Condenser



**Head office / Factory:**  
Istanbul Deri Organize Sanayi Bölgesi Dilek Sokak  
No: 10 X-12 Özel Parsel Tuzla 34957 İstanbul / TURKEY  
Tel: +90 216 394 12 82 (pbx) Fax: +90 216 394 12 87  
info@friterm.com  
www.friterm.com



twitter.com/friterm



facebook.com/friterm



linkedin.com/company/friterm

BK HVDC / 13.04.2016 | © Copyright Friterm A.Ş. All Rights Reserved.